

Width 4087.8 mm  
Depth 490.4 mm

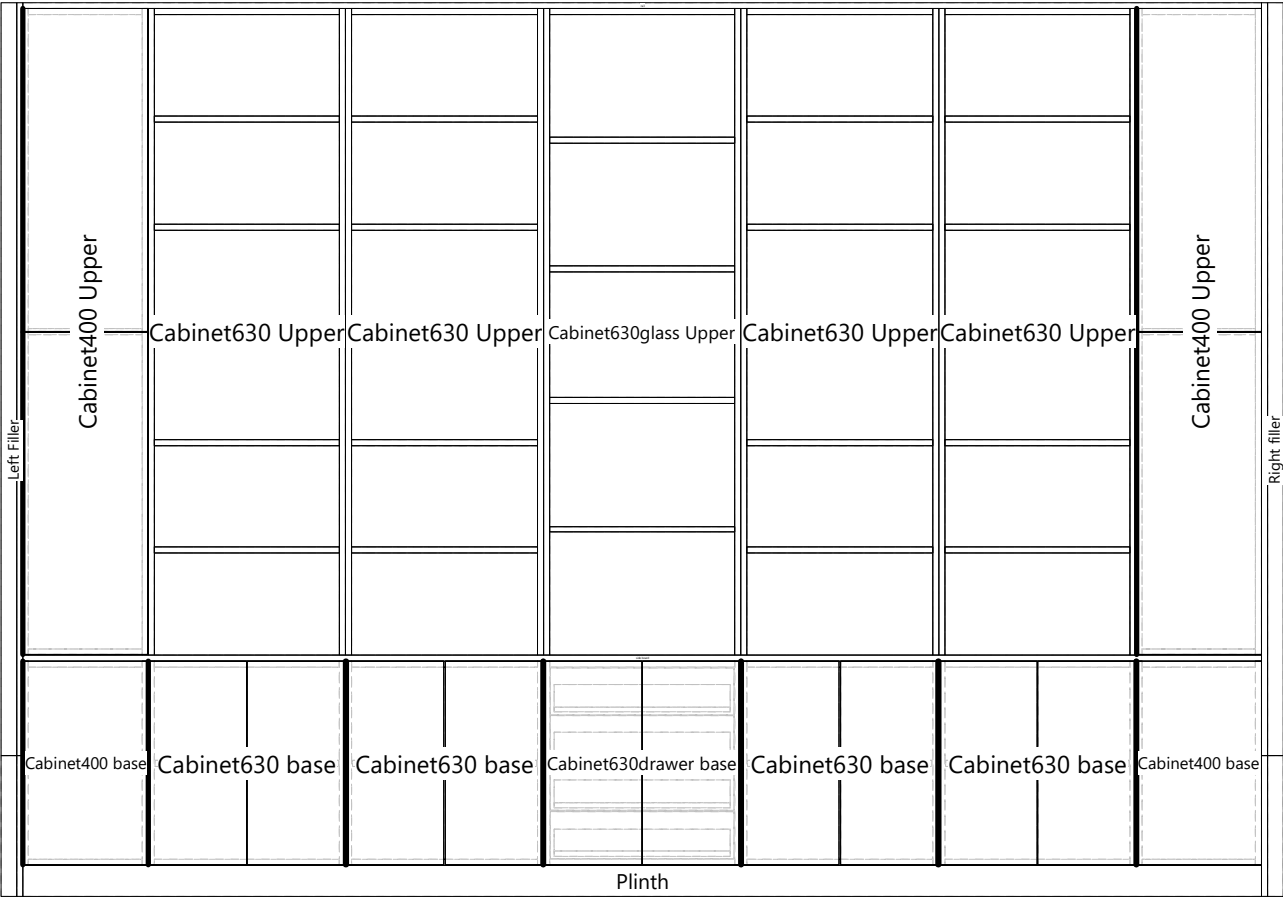

Cabinet List

Name	Height (mm)	Width (mm)	Depth (mm)	Quantity	Unit Price (€)	Price (€)
Cabinet400 base	650.0	400.0	490.0	2	55.91	111.82
Cabinet400 Upper	2060.0	400.0	490.0	2	148.27	296.54
Cabinet630 base	650.0	630.0	490.0	4	77.00	308.00
Cabinet630 Upper	2060.0	630.0	340.0	4	135.08	540.32
Cabinet630drawer base	650.0	630.0	490.0	1	142.20	142.20
Cabinet630glass Upper	2060.0	630.0	340.0	1	129.37	129.37
Left Filler	2848.0	69.0	70.0	1	23.57	23.57
Plinth	100.0	3950.0	69.0	1	29.56	29.56
rail	19.0	3950.0	200.0	1	46.50	46.50
Right filler	2848.0	69.0	70.0	1	23.57	23.57
side board	19.0	3950.0	470.0	1	83.96	83.96
Total						1735.41

Cutting List (Overall Dimensions) Generic 0160, 16.0

Num	Reference	Height	Width	Quantity	Grain	Left Edge	Right Edge	Bottom Edge	Top Edge
Cabinet630drawer base									
8	Bottom Drawer 400 [1]	560.0	398.0	4	No				
9	Back Drawer 400 [1]	560.0	71.0	4	No				

Cutting List (Overall Dimensions) Generic 0181, 18.0

Num	Reference	Height	Width	Quantity	Grain	Left Edge	Right Edge	Bottom Edge	Top Edge
Cabinet630drawer base									
7	Drawer 400 [...]	149.3	586.0	4	No	Edge-020, 2....	Edge-020, 2....	Edge-020, 2....	Edge-020, 2....

Cutting List (Overall Dimensions) Wood 0222 Oak, 19.0

Num	Reference	Height	Width	Quantity	Grain	Left Edge	Right Edge	Bottom Edge	Top Edge
Cabinet400 base (x2)									
1	Top_1	362.0	89.8	2	Yes				
2	Top_2	362.0	89.8	2	Yes		Edge-010, 1....		
3	Bottom	362.0	449.5	2	Yes		Edge-010, 1....		
4	[Left, Right] ...	650.0	449.5	4	Yes		Edge-010, 1....		
5	Back	650.0	400.0	2	Yes				
6	Mobile Shelf...	361.0	446.5	2	Yes		Edge-010, 1....		
7	Door Std (Si...	647.0	397.0	2	Yes	Edge-010, 1....	Edge-010, 1....	Edge-010, 1....	Edge-010, 1....
Cabinet400 Upper (x2)									
1	Top	362.0	449.5	2	Yes		Edge-010, 1....		
2	Bottom	362.0	449.5	2	Yes		Edge-010, 1....		
3	[Left, Right] ...	2060.0	449.5	4	Yes		Edge-010, 1....		
4	Back	2060.0	400.0	2	Yes				
5	Fixed Shelf [1]	362.0	449.5	2	Yes		Edge-010, 1....		

## Cutting List (Overall Dimensions) Wood 0222 Oak, 19.0 (Next)

Num	Reference	Height	Width	Quantity	Grain	Left Edge	Right Edge	Bottom Edge	Top Edge
6	Door Std (Si...	1027.0	397.0	4	Yes	Edge-010, 1....	Edge-010, 1....	Edge-010, 1....	Edge-010, 1....
<b>Cabinet630 base (x4)</b>									
1	Top_1	592.0	89.8	4	Yes				
2	Top_2	592.0	89.8	4	Yes		Edge-010, 1....		
3	Bottom	592.0	449.5	4	Yes		Edge-010, 1....		
4	[Left, Right] ...	650.0	449.5	8	Yes		Edge-010, 1....		
5	Back	650.0	630.0	4	Yes				
6	Mobile Shelf...	586.0	444.5	4	Yes		Edge-010, 1....		
7	Door Std (D...	647.0	312.0	8	Yes	Edge-010, 1....	Edge-010, 1....	Edge-010, 1....	Edge-010, 1....
<b>Cabinet630 Upper (x4)</b>									
1	Top	592.0	321.0	4	Yes		Edge-010, 1....		
2	[Left, Right] ...	2060.0	321.0	8	Yes		Edge-010, 1....		
3	Back	2060.0	630.0	4	Yes				
4	Mobile Shelf	591.0	298.0	20	Yes		Edge-010, 1....		
<b>Cabinet630drawer base</b>									
1	Top_1	592.0	89.8	1	Yes				
2	Top_2	592.0	89.8	1	Yes		Edge-010, 1....		
3	Bottom	592.0	449.5	1	Yes		Edge-010, 1....		
4	[Left, Right] ...	650.0	449.5	2	Yes		Edge-010, 1....		
5	Back	650.0	630.0	1	Yes				
6	Door Std (D...	647.0	312.0	2	Yes	Edge-010, 1....	Edge-010, 1....	Edge-010, 1....	Edge-010, 1....
<b>Cabinet630glass Upper</b>									
1	Top	592.0	321.0	1	Yes		Edge-010, 1....		
2	[Left, Right] ...	2060.0	321.0	2	Yes		Edge-010, 1....		
3	Back	2060.0	630.0	1	Yes				
4	Fixed Shelf	592.0	321.0	2	Yes		Edge-010, 1....		
5	Mobile Shelf	591.0	298.0	2	Yes		Edge-010, 1....		
<b>Left Filler</b>									
1	Left Side_1	2400.0	70.0	1	Yes		Edge-010, 1....		
2	Left Side_2	448.0	70.0	1	Yes		Edge-010, 1....		
3	Filler 1 [1]_1	2400.0	50.0	1	Yes				
4	Filler 1 [1]_2	448.0	50.0	1	Yes				
<b>Plinth</b>									
1	Back	100.0	3950.0	1	Yes				
<b>rail</b>									
1	Top	3950.0	200.0	1	Yes		Edge-010, 1....		
<b>Right filler</b>									
1	Right Side_1	2400.0	70.0	1	Yes		Edge-010, 1....		
2	Right Side_2	448.0	70.0	1	Yes		Edge-010, 1....		
3	Filler 1 [1]_1	2400.0	50.0	1	Yes				
4	Filler 1 [1]_2	448.0	50.0	1	Yes				
<b>side board</b>									
1	Top	3950.0	470.0	1	Yes		Edge-010, 1....		

## Costing Report

Panel	Surface	Price (€/m²)	Price
Generic 0160, 16.0	1.05 m²	45.00	47,28€
Generic 0181, 18.0	0.35 m²	45.00	15,74€
Wood 0222 Oak, 19.0	42.86 m²	34.52	1479,63€
<b>Total</b>			<b>1542,65€</b>

Edge	Length	Price (€/m)	Price
Edge-010, 1.0 mm	116.0 m	1.00	116,04€
Edge-020, 2.0 mm	5.9 m	2.00	11,76€
<b>Total</b>			<b>127,80€</b>

Fittings	Quantity	Unit Price	Price
Häfele/foot/Axilo78-n	20	0.00	0,00€
hole/04	112	0.50	56,00€
Titus/Cam-p19/15-34-14/2x-dow/8-30/int	56	0.16	8,96€
<b>Total</b>			<b>64,96€</b>

Cabinet400 base

Height 650.0 mm  
Width 400.0 mm  
Depth 490.0 mm

FRONT VIEW

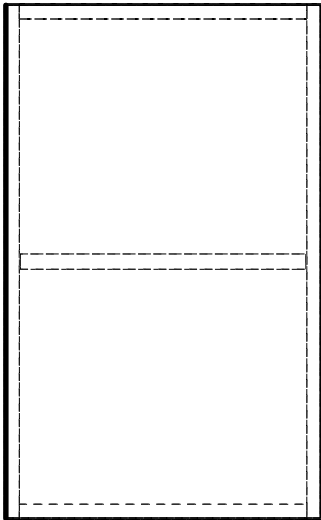

LEFT VIEW

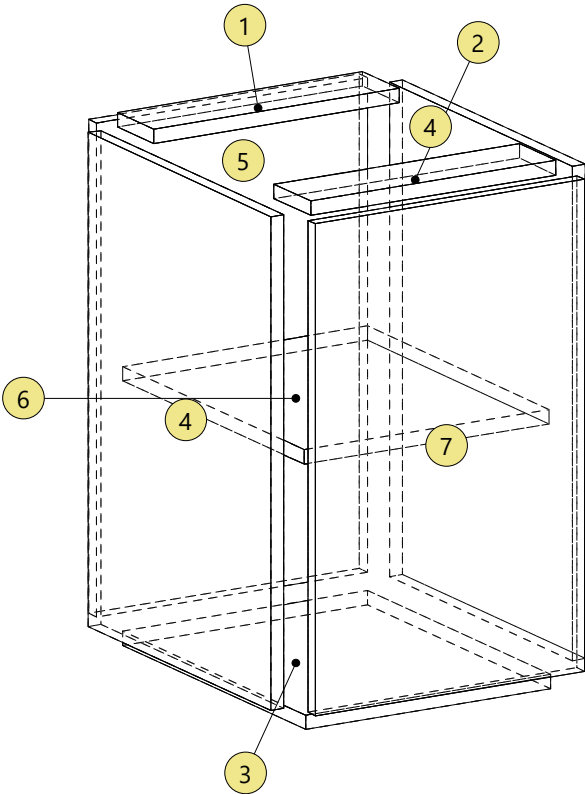
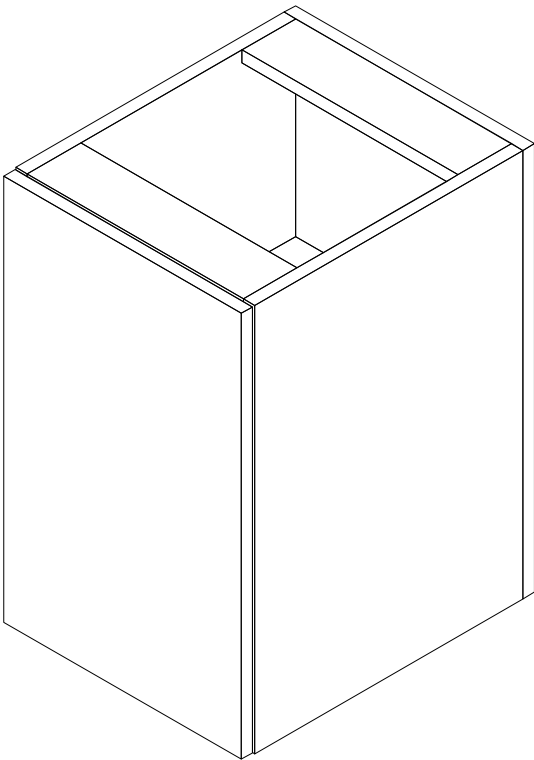
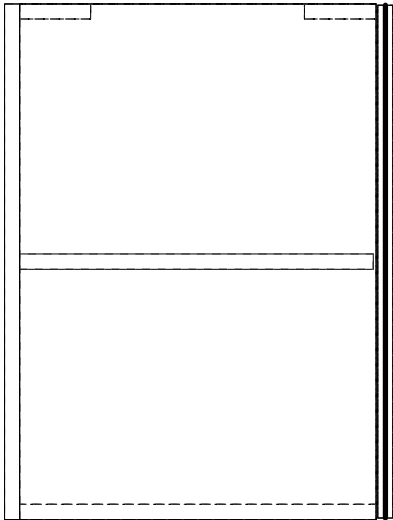

Cabinet400 base  
Top\_1      Wood 0222 Oak      Height: 362.0      Width: 89.8      Thickness: 19.0      Quantity: 2

Face 1

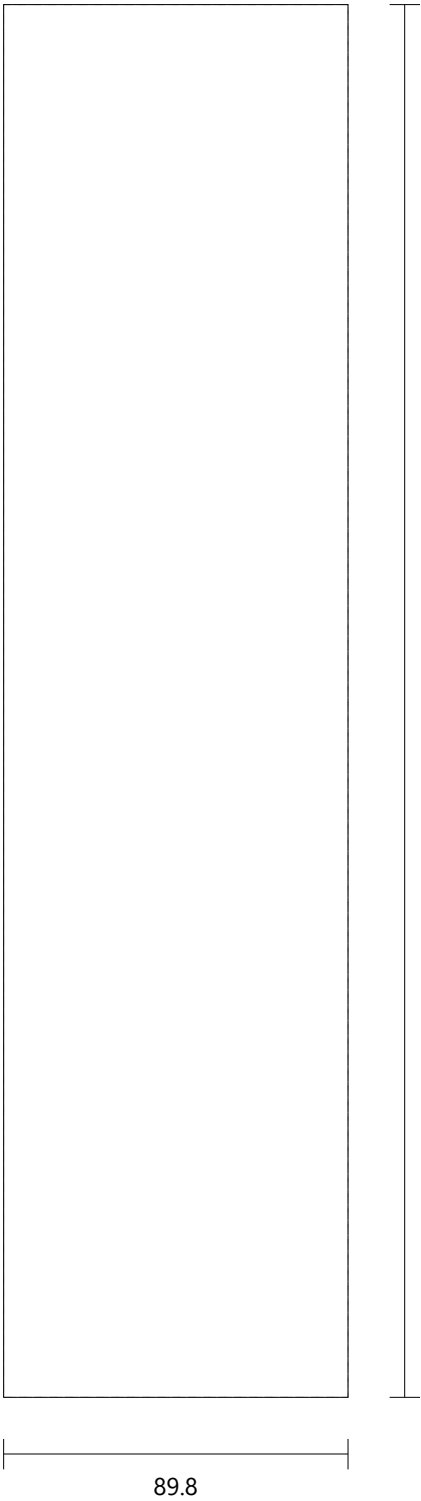

Cabinet400 base  
Top\_2      Wood 0222 Oak      Height: 362.0      Width: 89.8      Thickness: 19.0      Quantity: 2

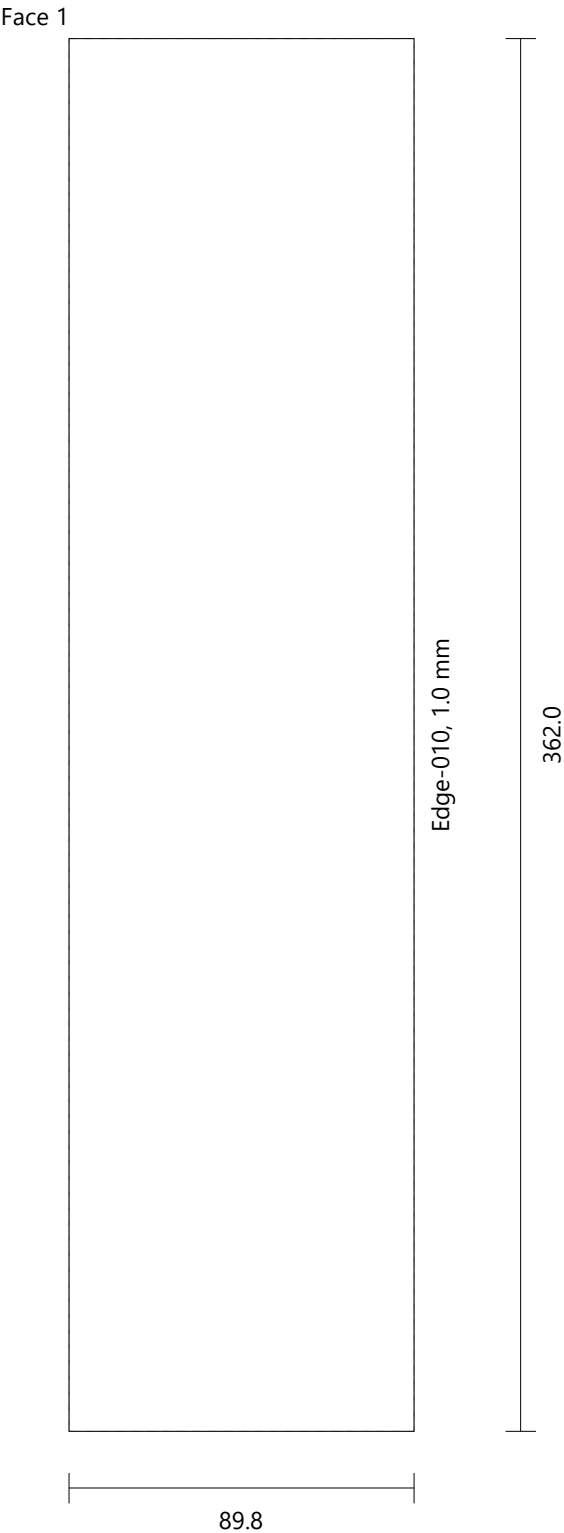

Cabinet400 base  
Bottom      Wood 0222 Oak      Height: 362.0      Width: 449.5      Thickness: 19.0      Quantity: 2

Face 1

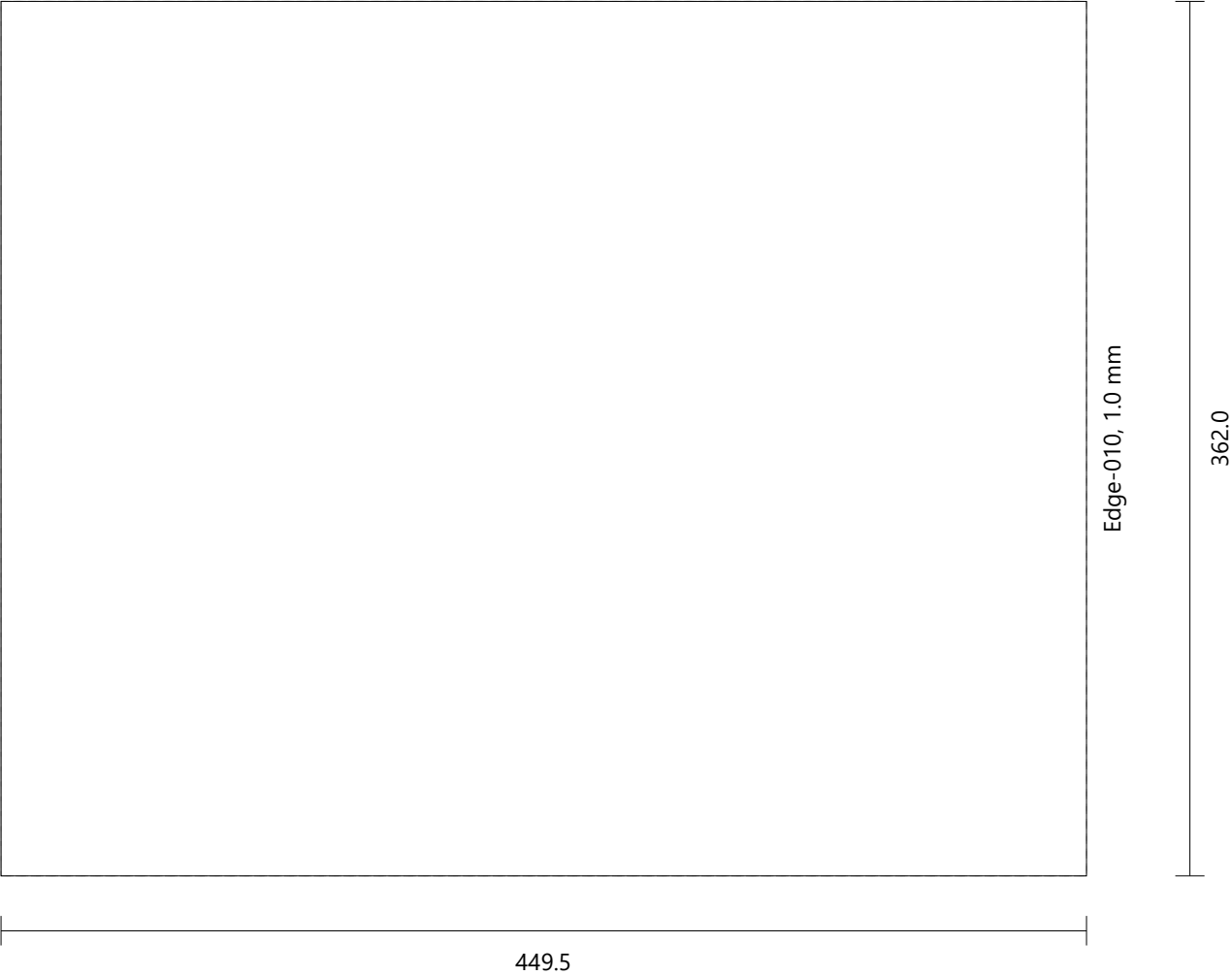



Cabinet400 base  
[Left, Right] Side    Wood 0222 Oak    Height: 650.0    Width: 449.5    Thickness: 19.0    Quantity: 4

Face 1

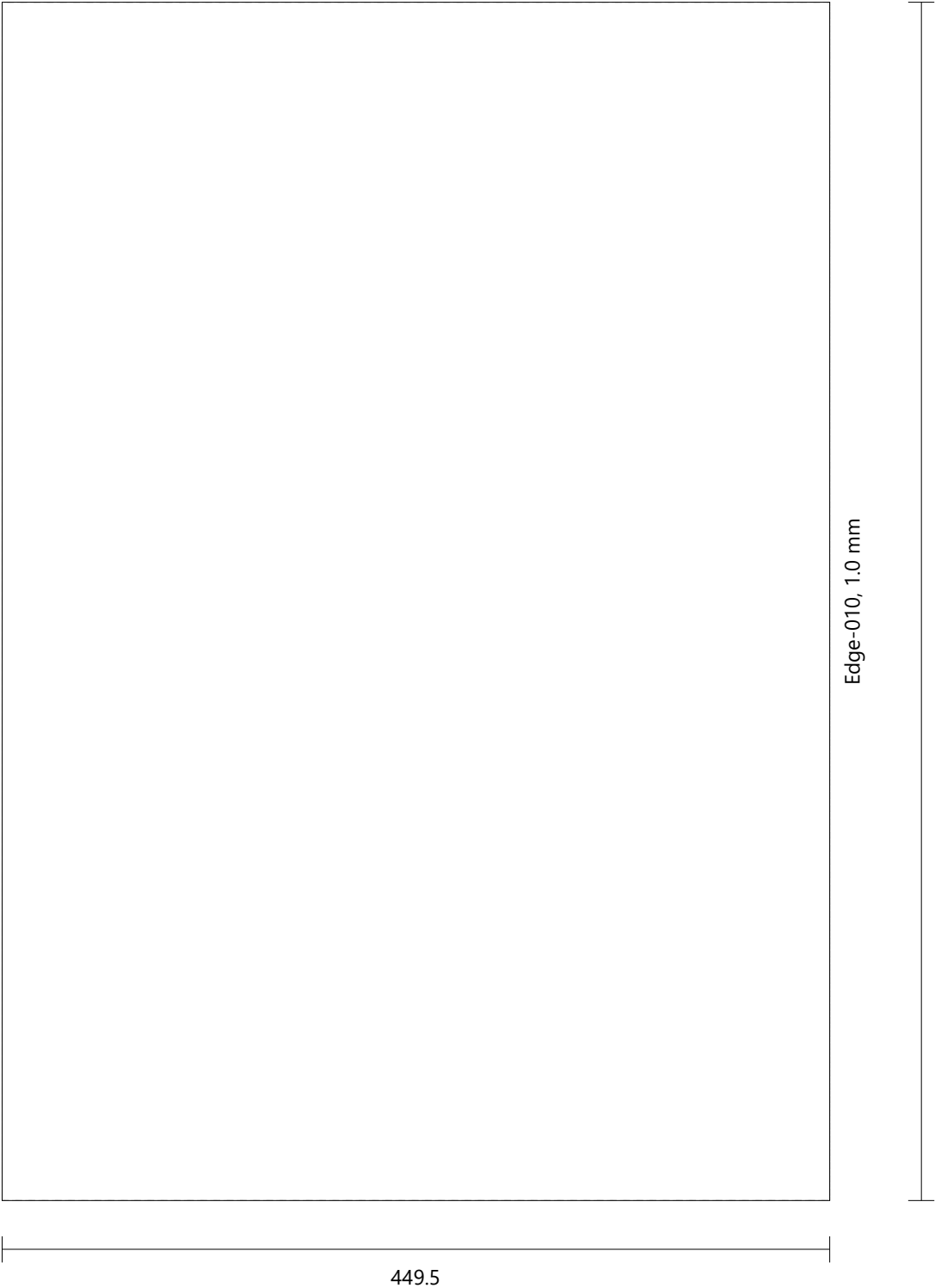

Cabinet400 base  
Back Wood 0222 Oak Height: 650.0 Width: 400.0 Thickness: 19.0 Quantity: 2

Face 1

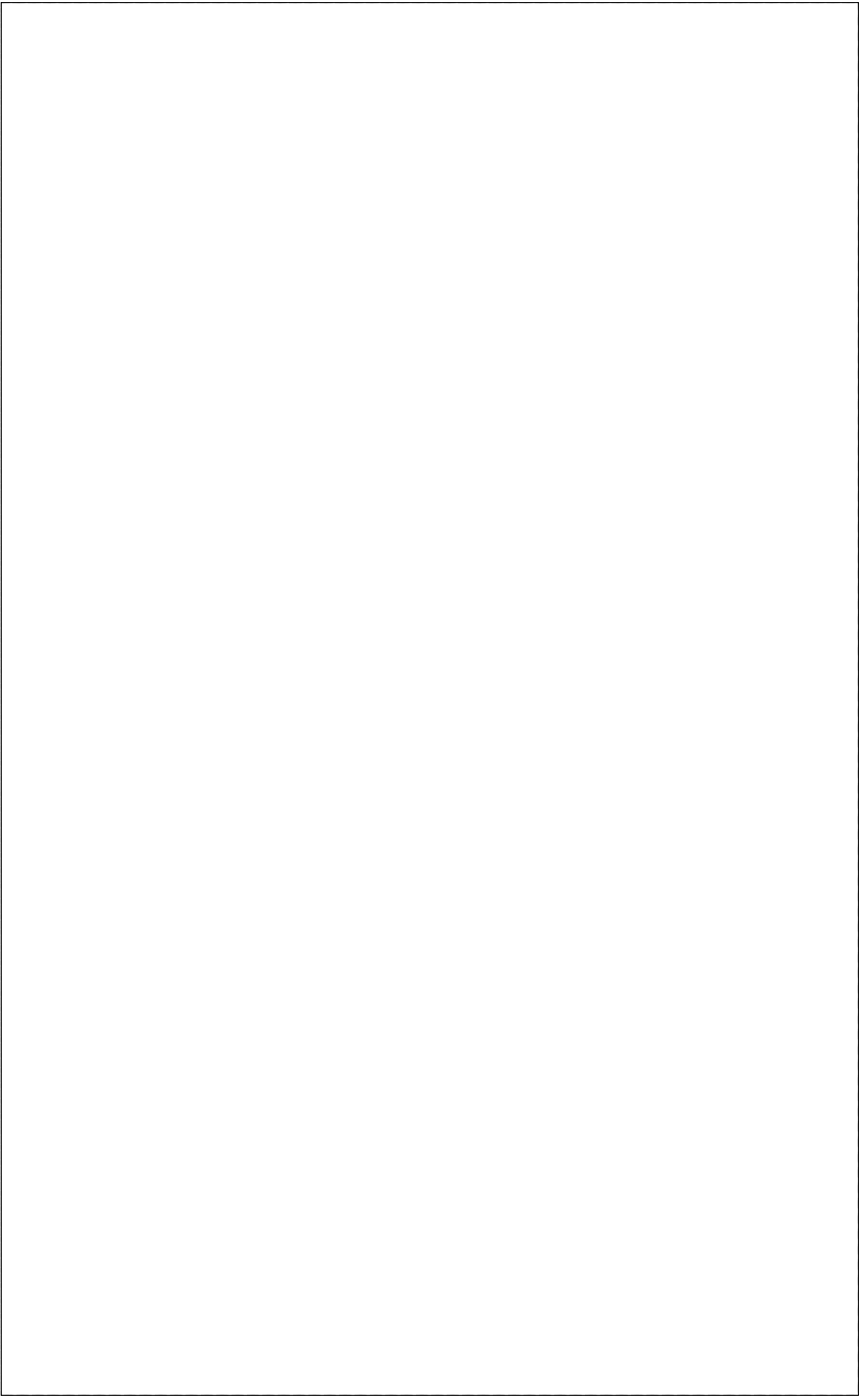

650.0

400.0

Cabinet400 base  
Mobile Shelf [1]      Wood 0222 Oak      Height: 361.0      Width: 446.5      Thickness: 19.0      Quantity: 2

Face 1

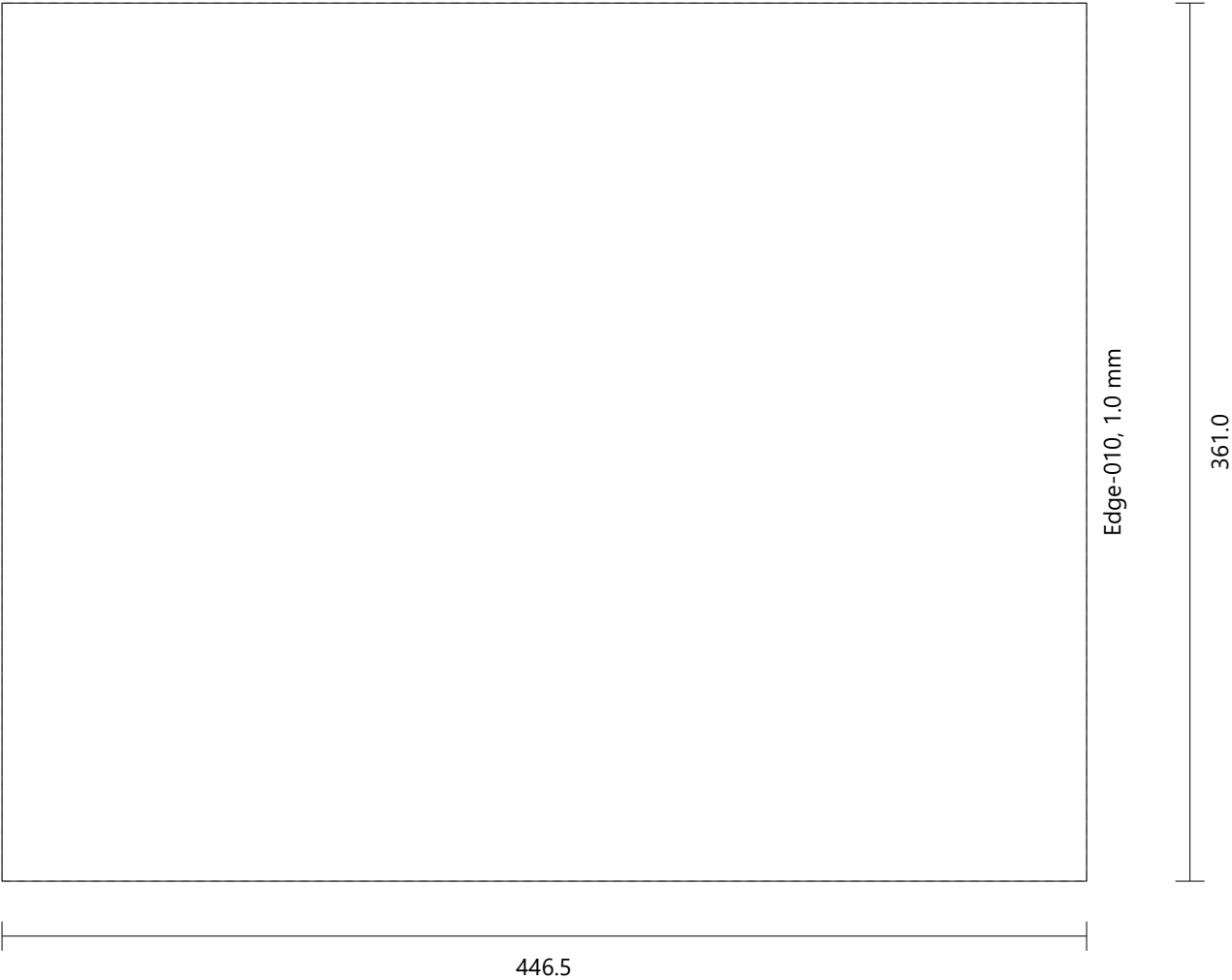

Cabinet400 base  
Door Std (Single) [1]    Wood 0222 Oak    Height: 647.0    Width: 397.0    Thickness: 19.0    Quantity: 2

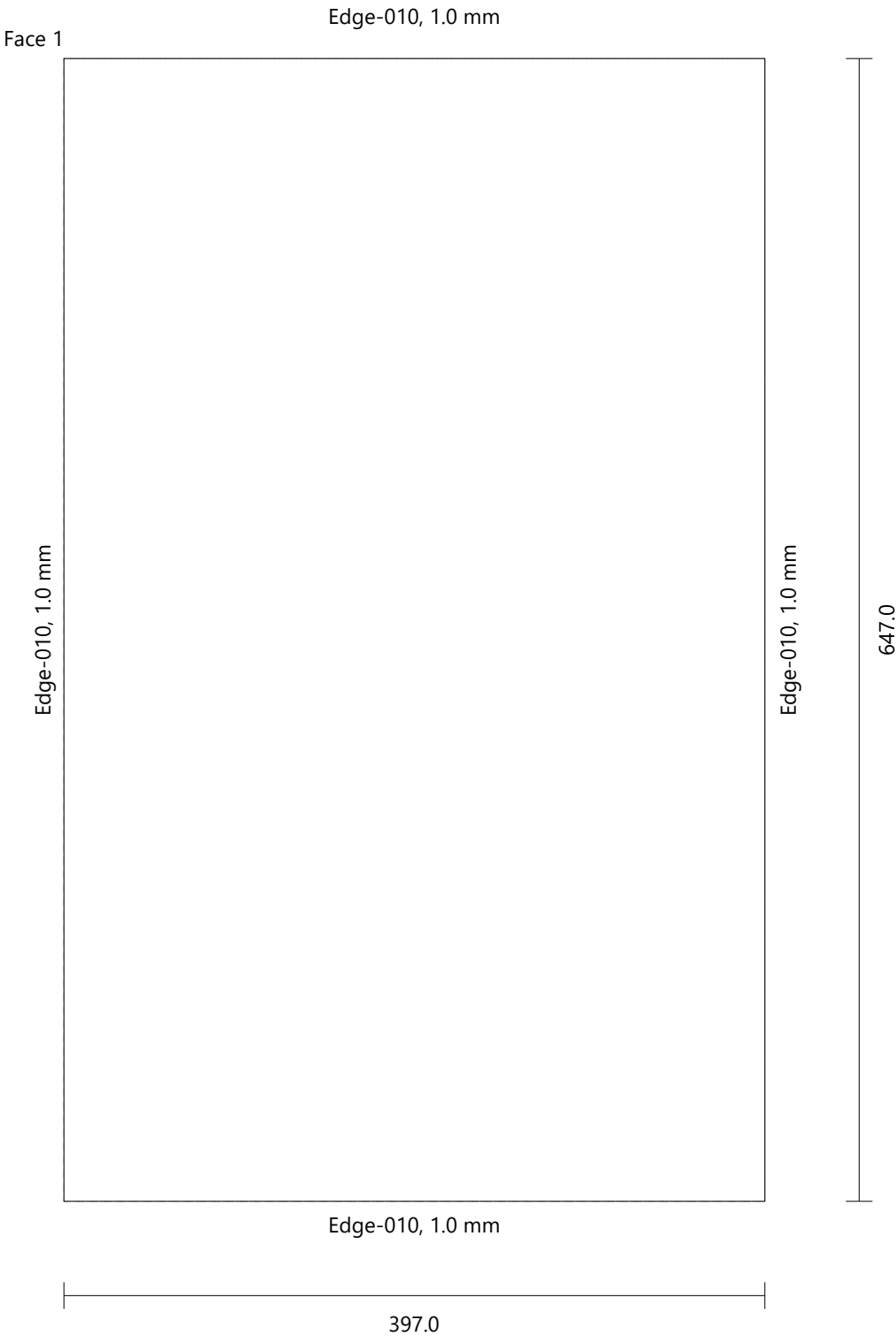

Cabinet400 Upper

Height 2060.0 mm  
Width 400.0 mm  
Depth 490.0 mm

FRONT VIEW

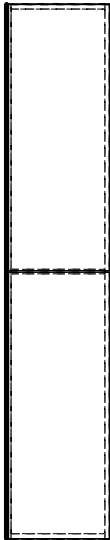

LEFT VIEW

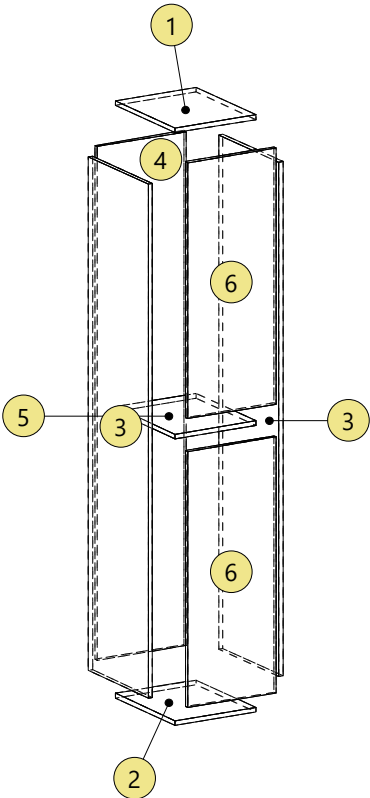
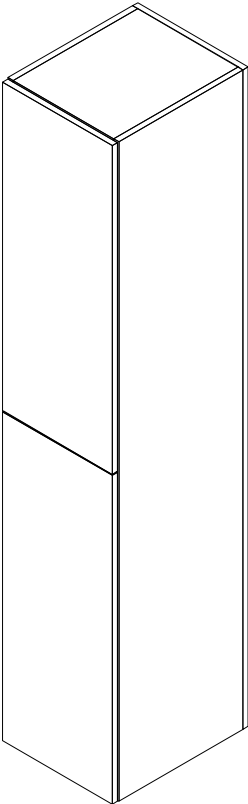
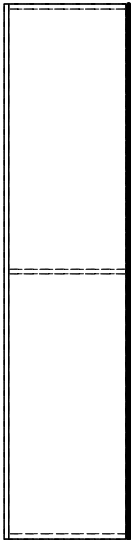

Cabinet400 Upper  
Top      Wood 0222 Oak      Height: 362.0      Width: 449.5      Thickness: 19.0      Quantity: 2

Face 1

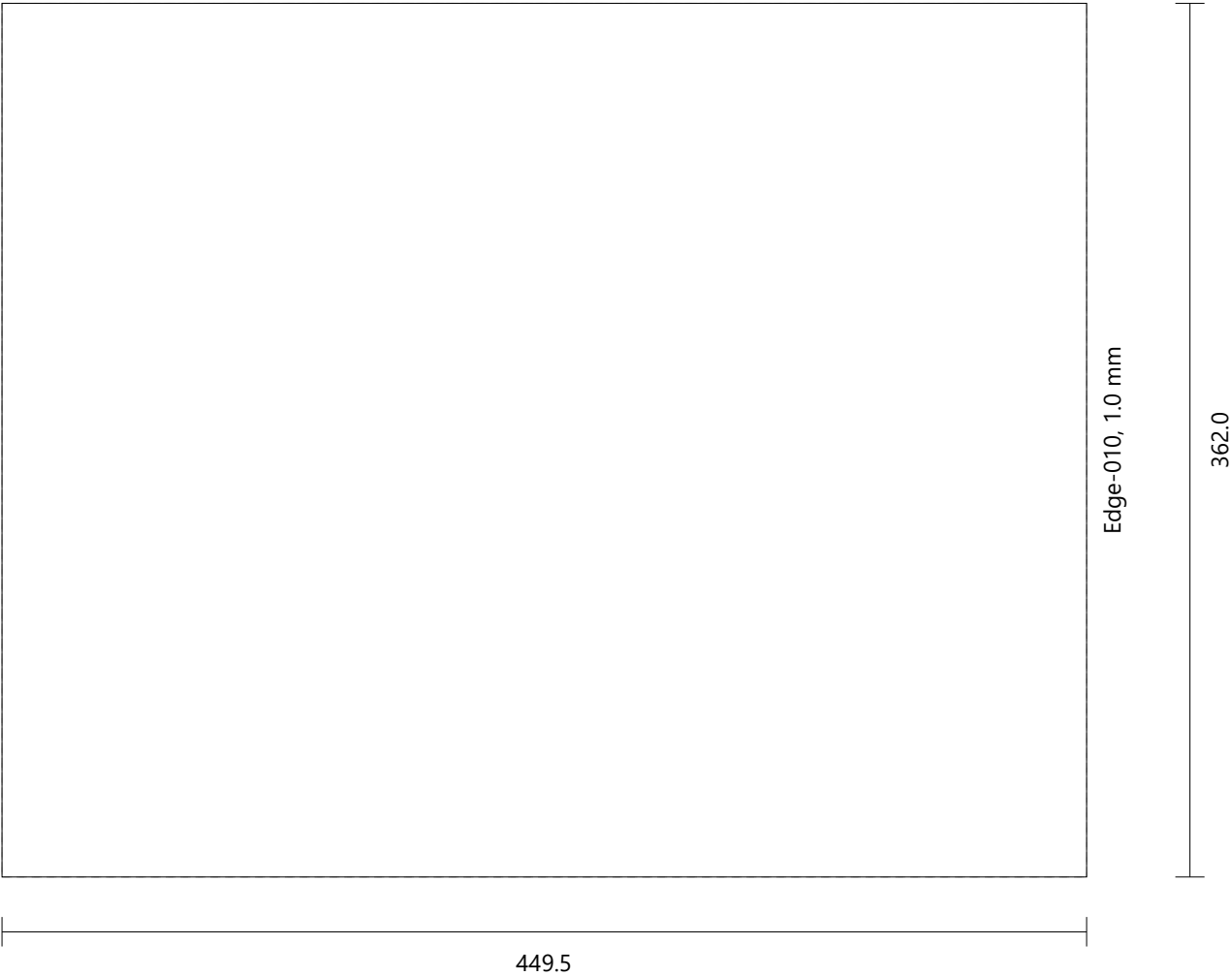

Cabinet400 Upper  
Bottom      Wood 0222 Oak      Height: 362.0      Width: 449.5      Thickness: 19.0      Quantity: 2

Face 1

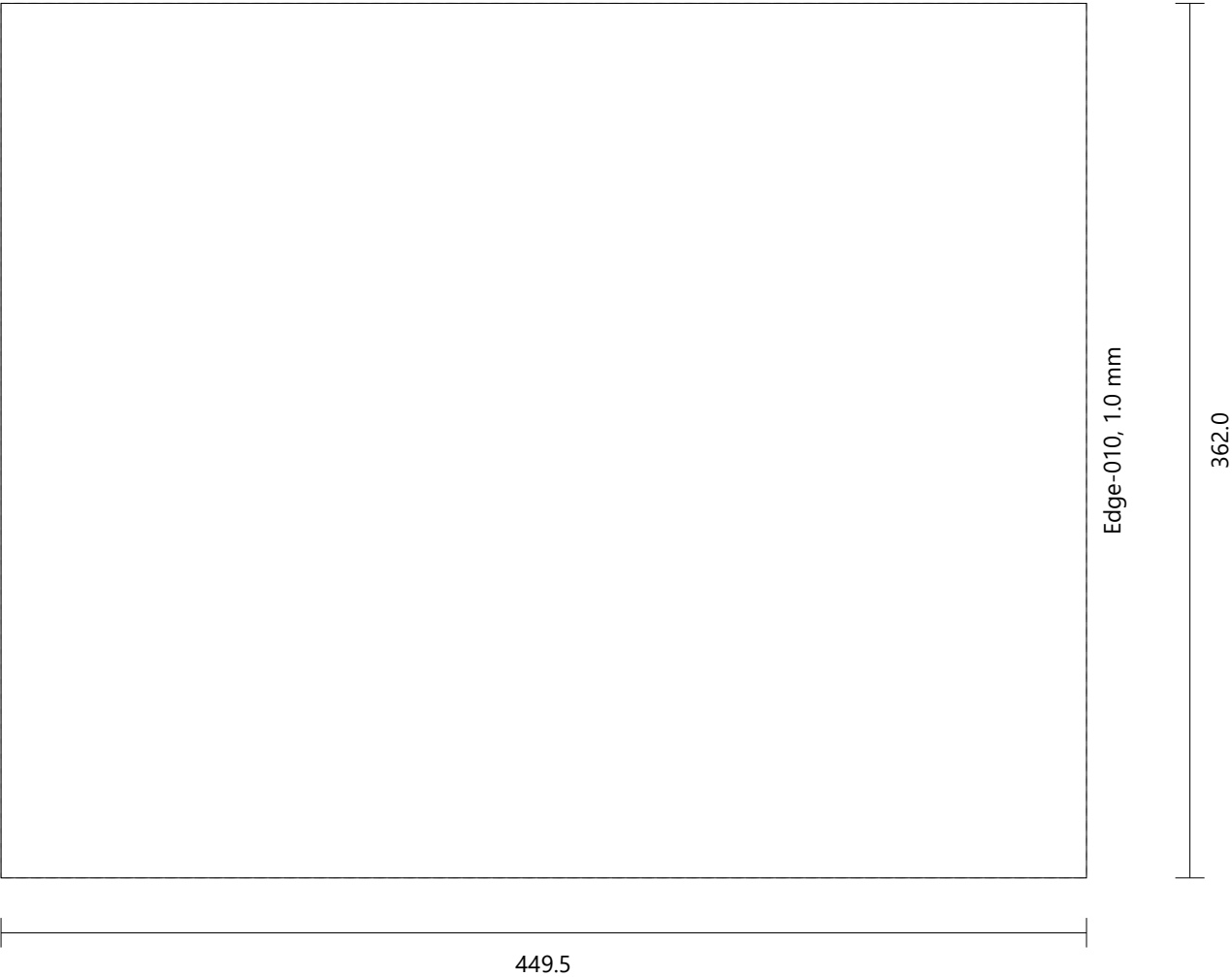

Cabinet400 Upper  
[Left, Right] Side      Wood 0222 Oak      Height: 2060.0      Width: 449.5      Thickness: 19.0      Quantity: 4

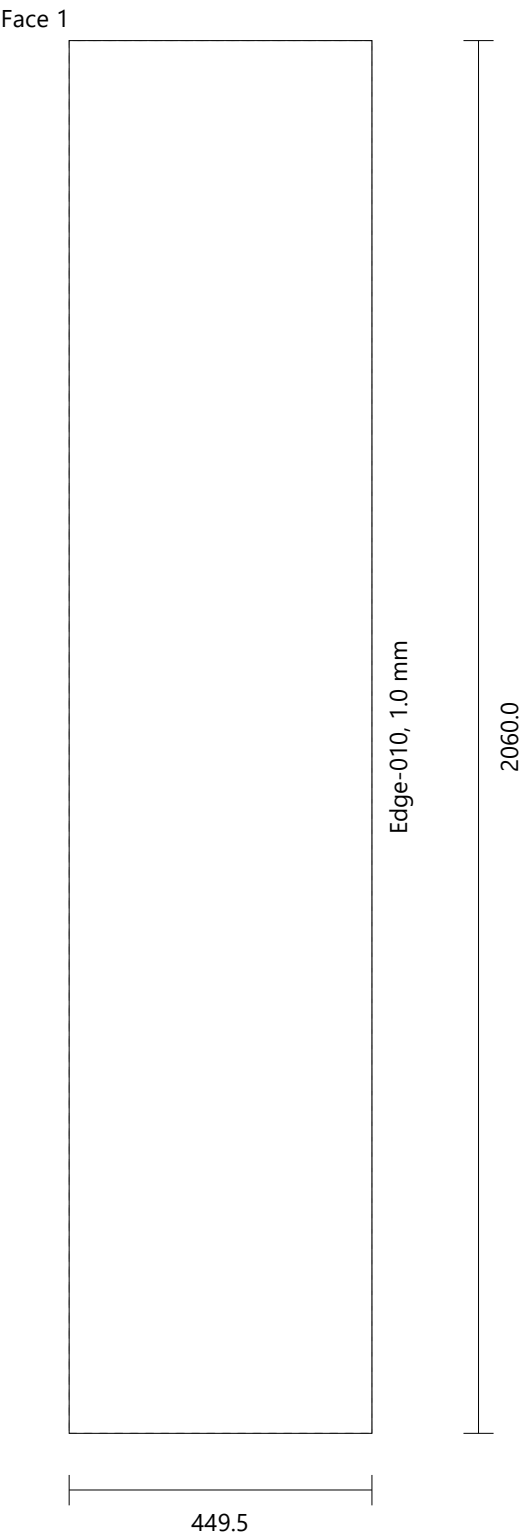



Cabinet400 Upper  
Back      Wood 0222 Oak      Height: 2060.0      Width: 400.0      Thickness: 19.0      Quantity: 2

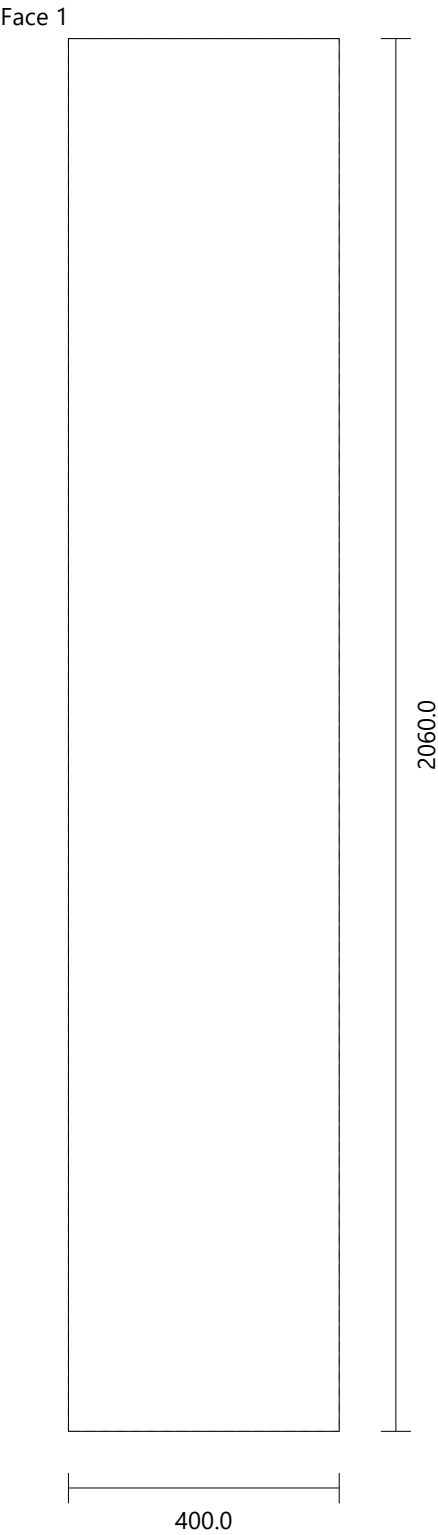

Cabinet400 Upper  
Fixed Shelf [1]      Wood 0222 Oak      Height: 362.0      Width: 449.5      Thickness: 19.0      Quantity: 2

Face 1

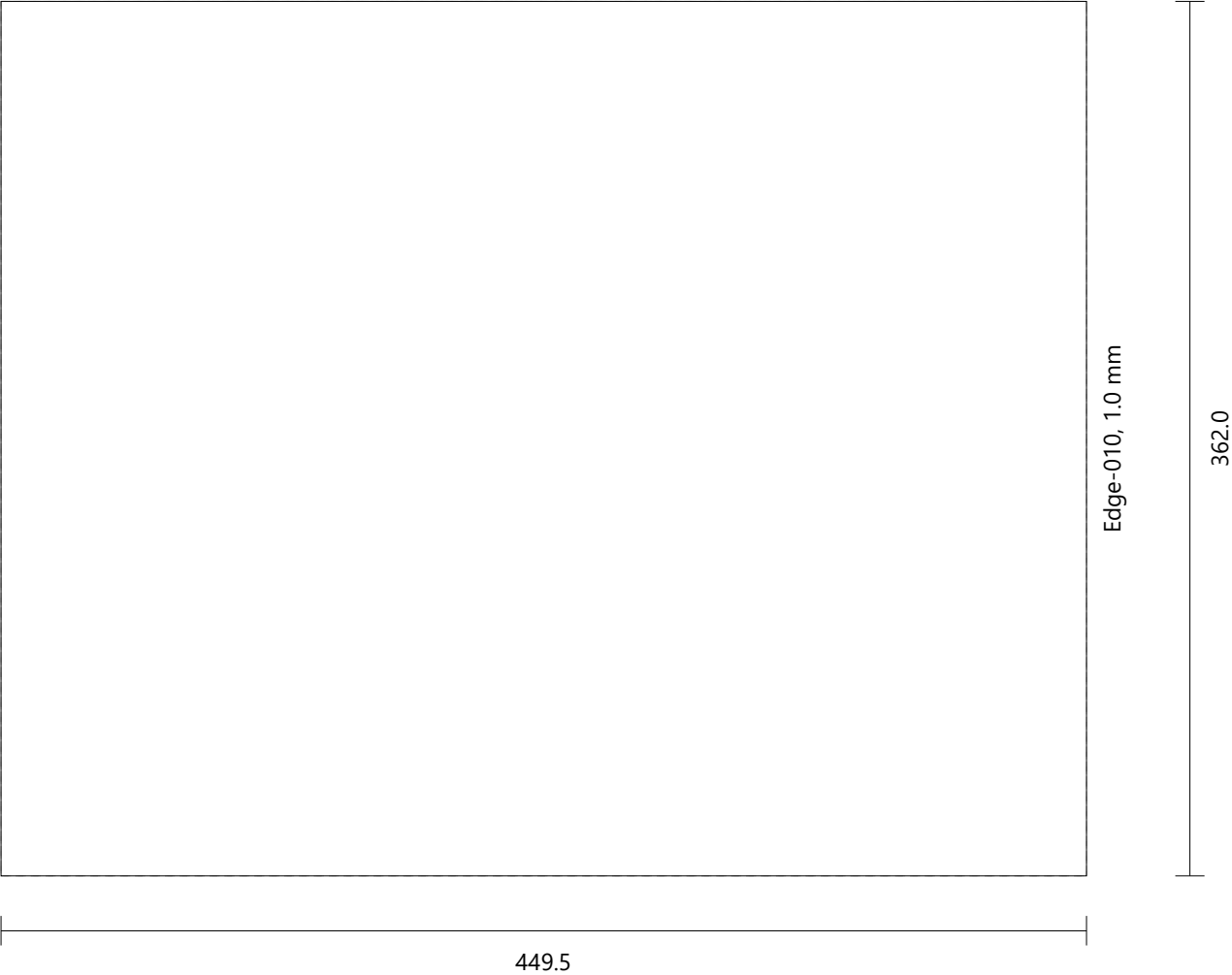

Cabinet400 Upper  
Door Std (Single)    Wood 0222 Oak    Height: 1027.0    Width: 397.0    Thickness: 19.0    Quantity: 4

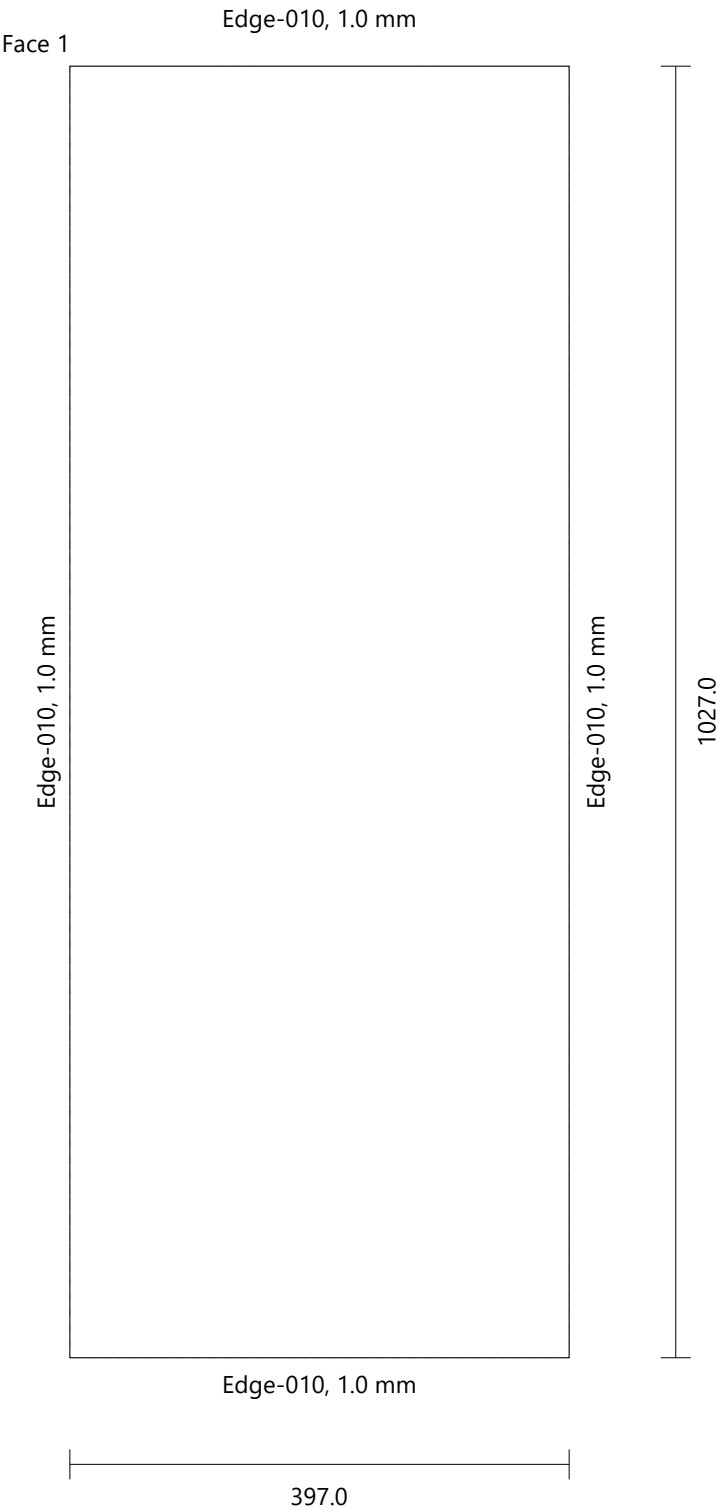

Cabinet630 base

Height 650.0 mm  
Width 630.0 mm  
Depth 490.0 mm

FRONT VIEW

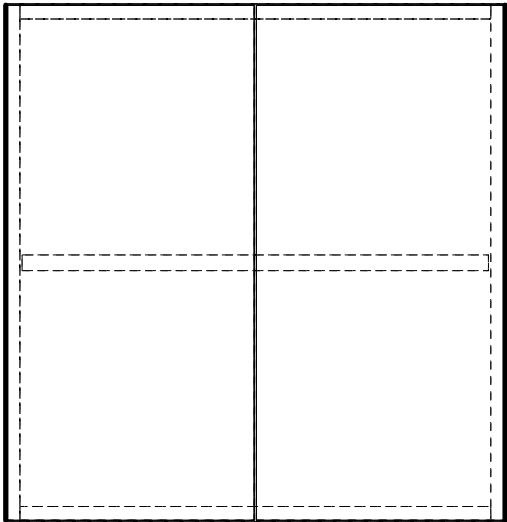

LEFT VIEW

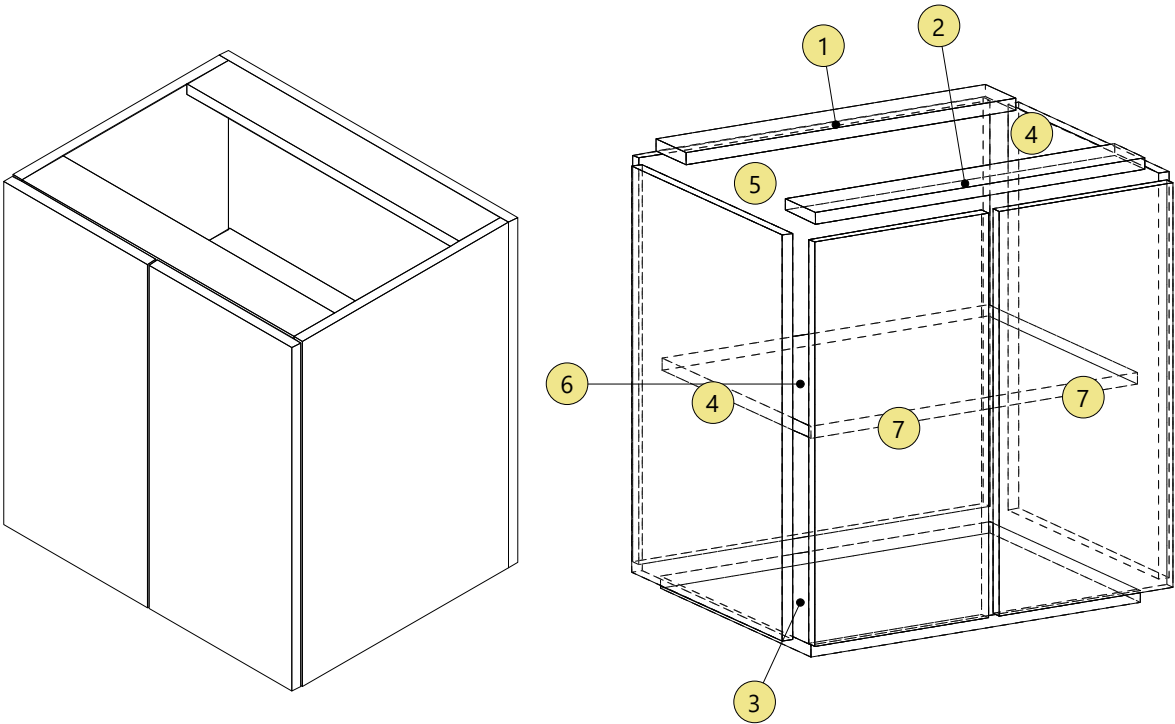
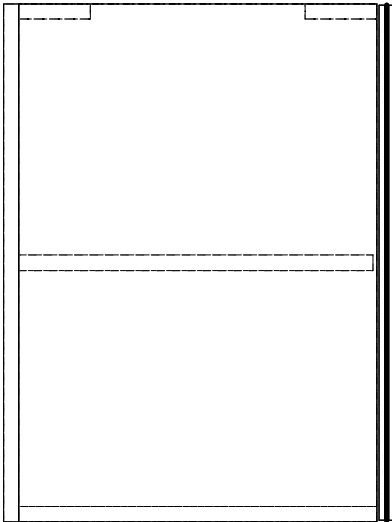

Cabinet630 base  
Top\_1      Wood 0222 Oak      Height: 592.0      Width: 89.8      Thickness: 19.0      Quantity: 4

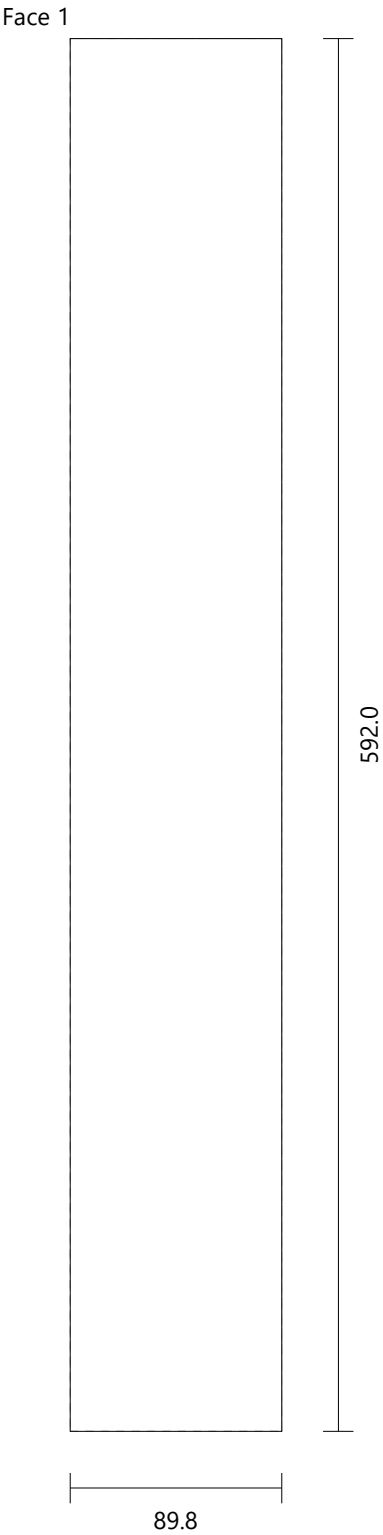

Cabinet630 base  
Top\_2      Wood 0222 Oak      Height: 592.0      Width: 89.8      Thickness: 19.0      Quantity: 4

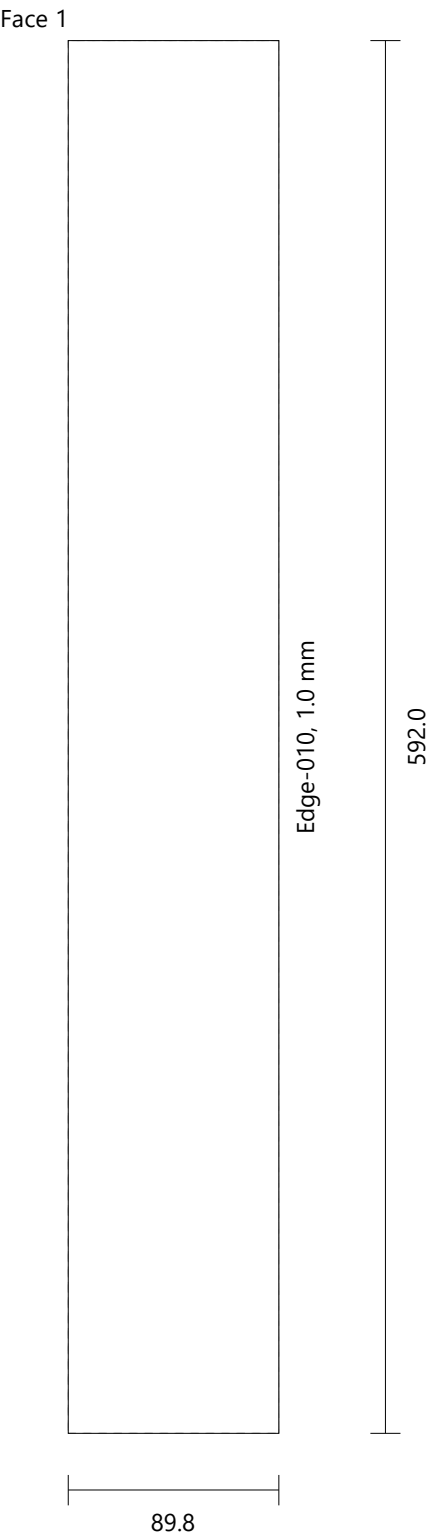

Cabinet630 base  
Bottom      Wood 0222 Oak      Height: 592.0      Width: 449.5      Thickness: 19.0      Quantity: 4

Face 1

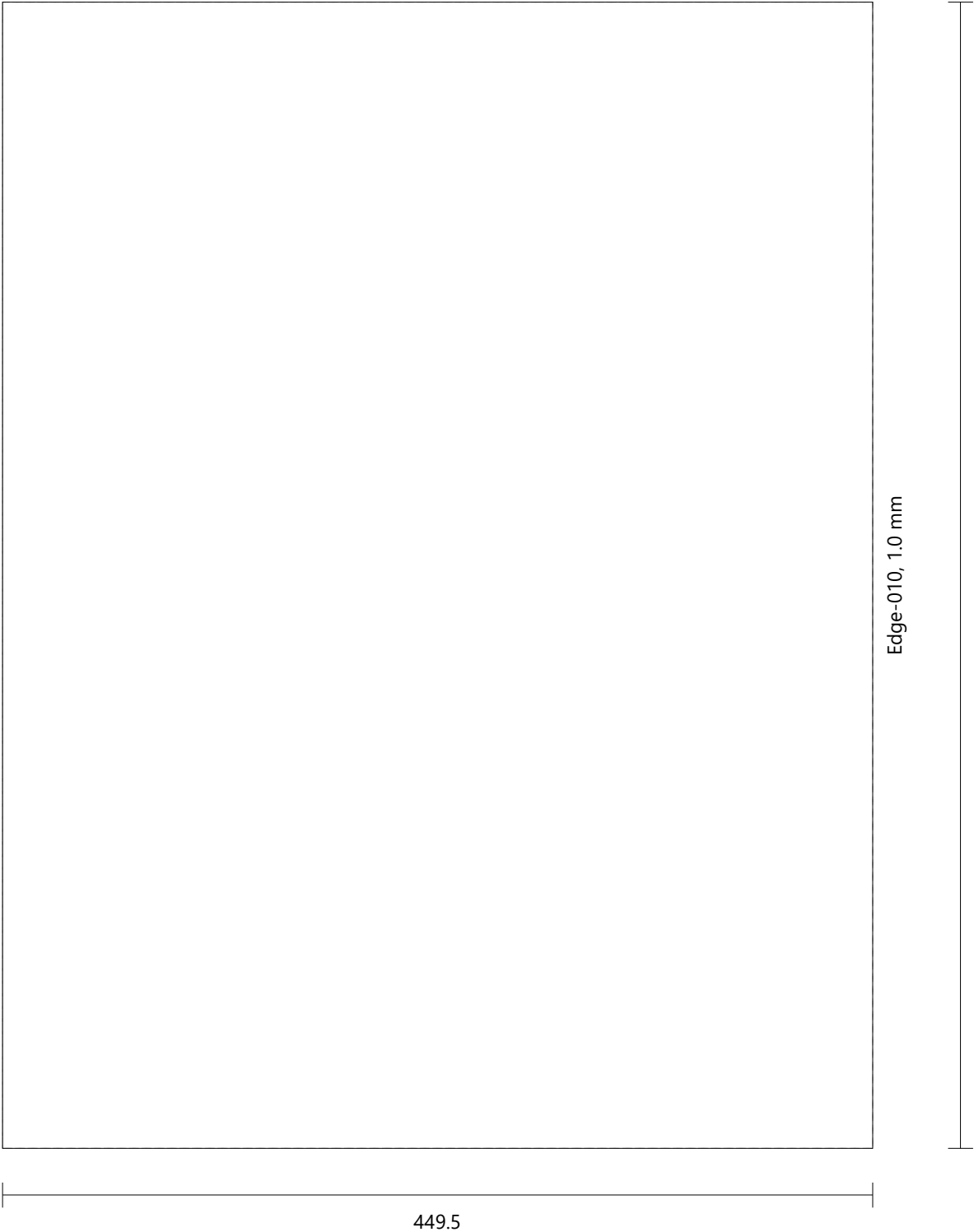

Cabinet630 base  
[Left, Right] Side    Wood 0222 Oak    Height: 650.0    Width: 449.5    Thickness: 19.0    Quantity: 8

Face 1

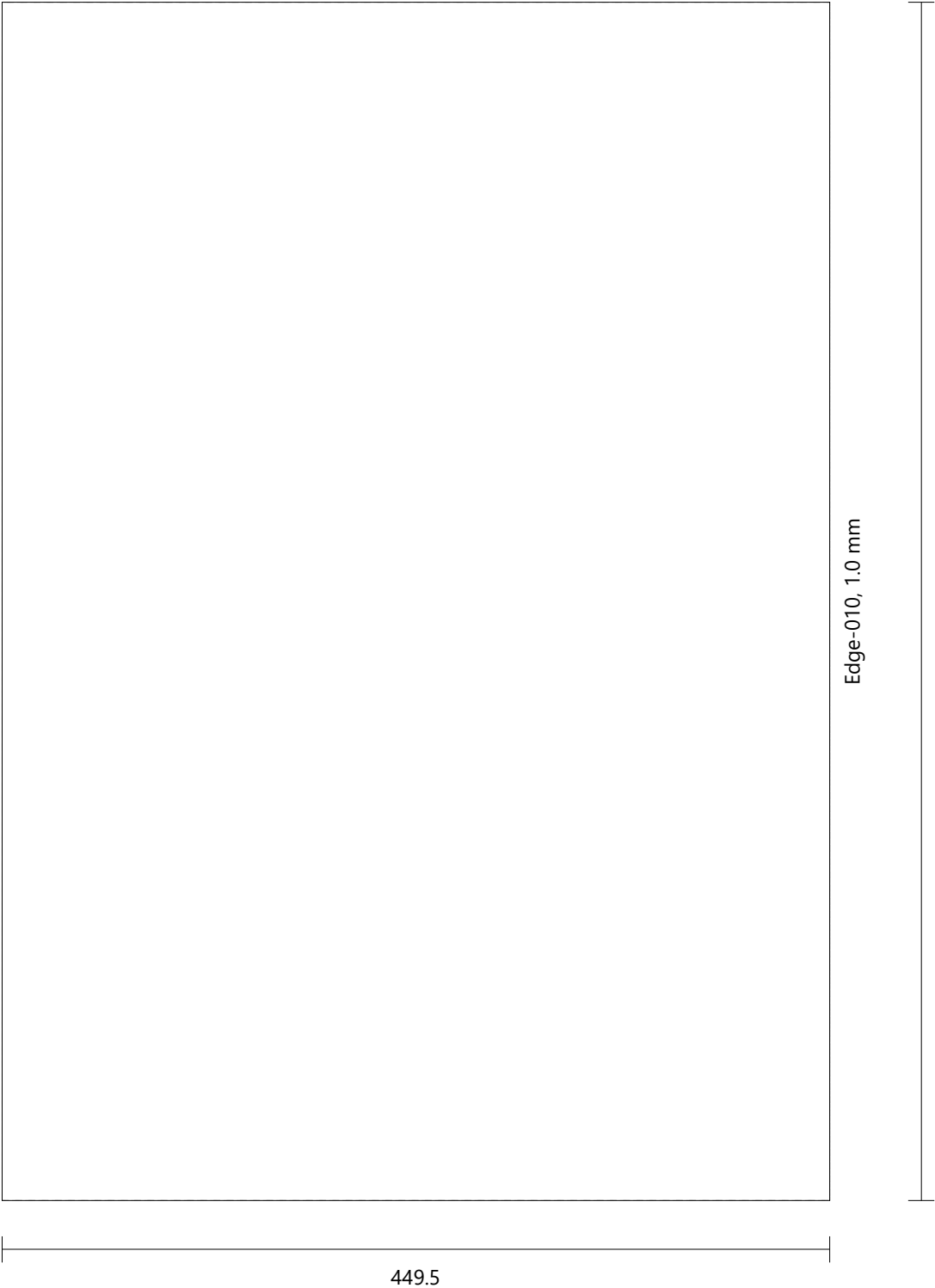



Cabinet630 base  
Back Wood 0222 Oak Height: 650.0 Width: 630.0 Thickness: 19.0 Quantity: 4

Face 1

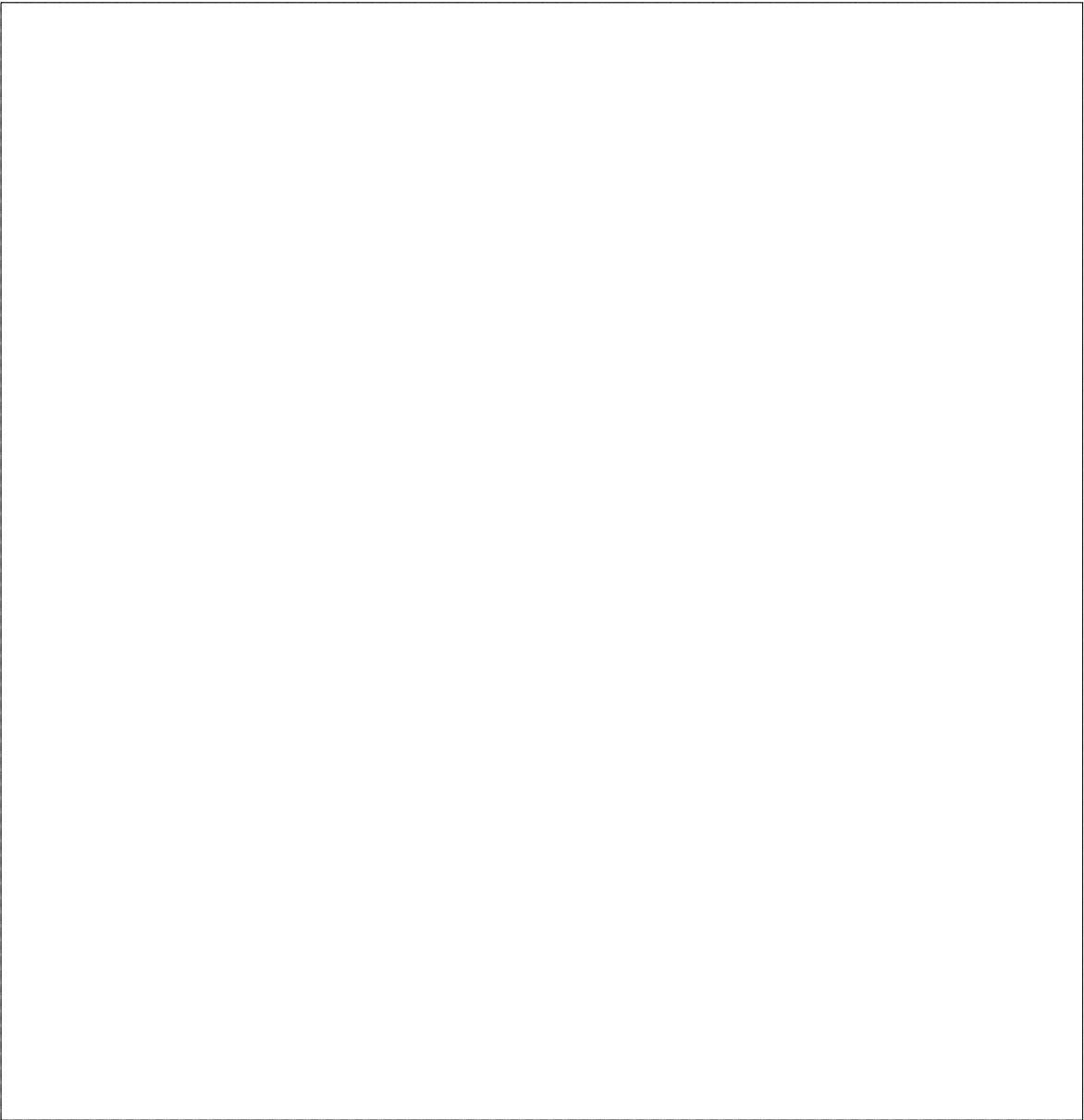

650.0

630.0

Cabinet630 base  
Mobile Shelf [1]    Wood 0222 Oak    Height: 586.0    Width: 444.5    Thickness: 19.0    Quantity: 4

Face 1

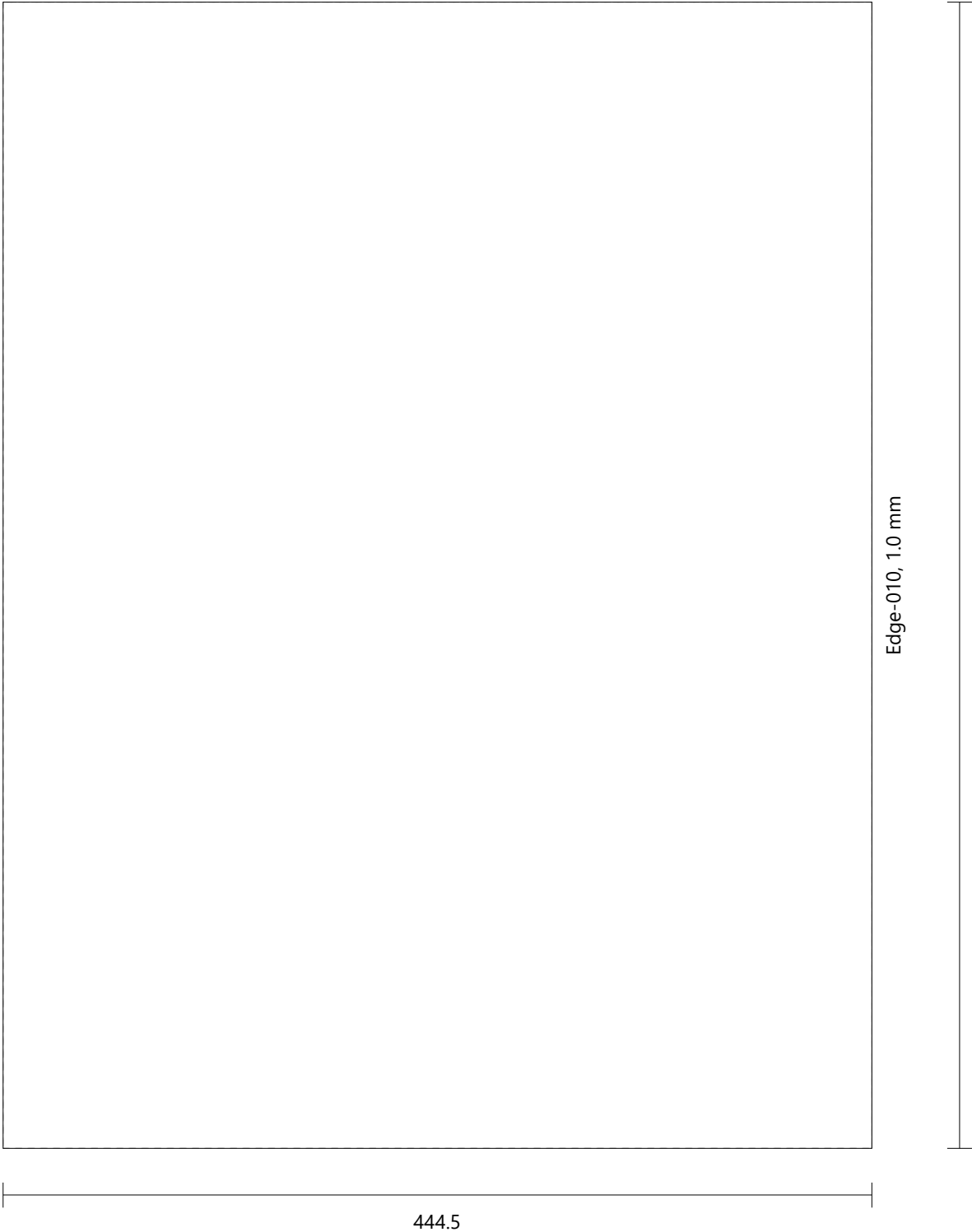

Cabinet630 base  
Door Std (Double) [1]    Wood 0222 Oak    Height: 647.0    Width: 312.0    Thickness: 19.0    Quantity: 8

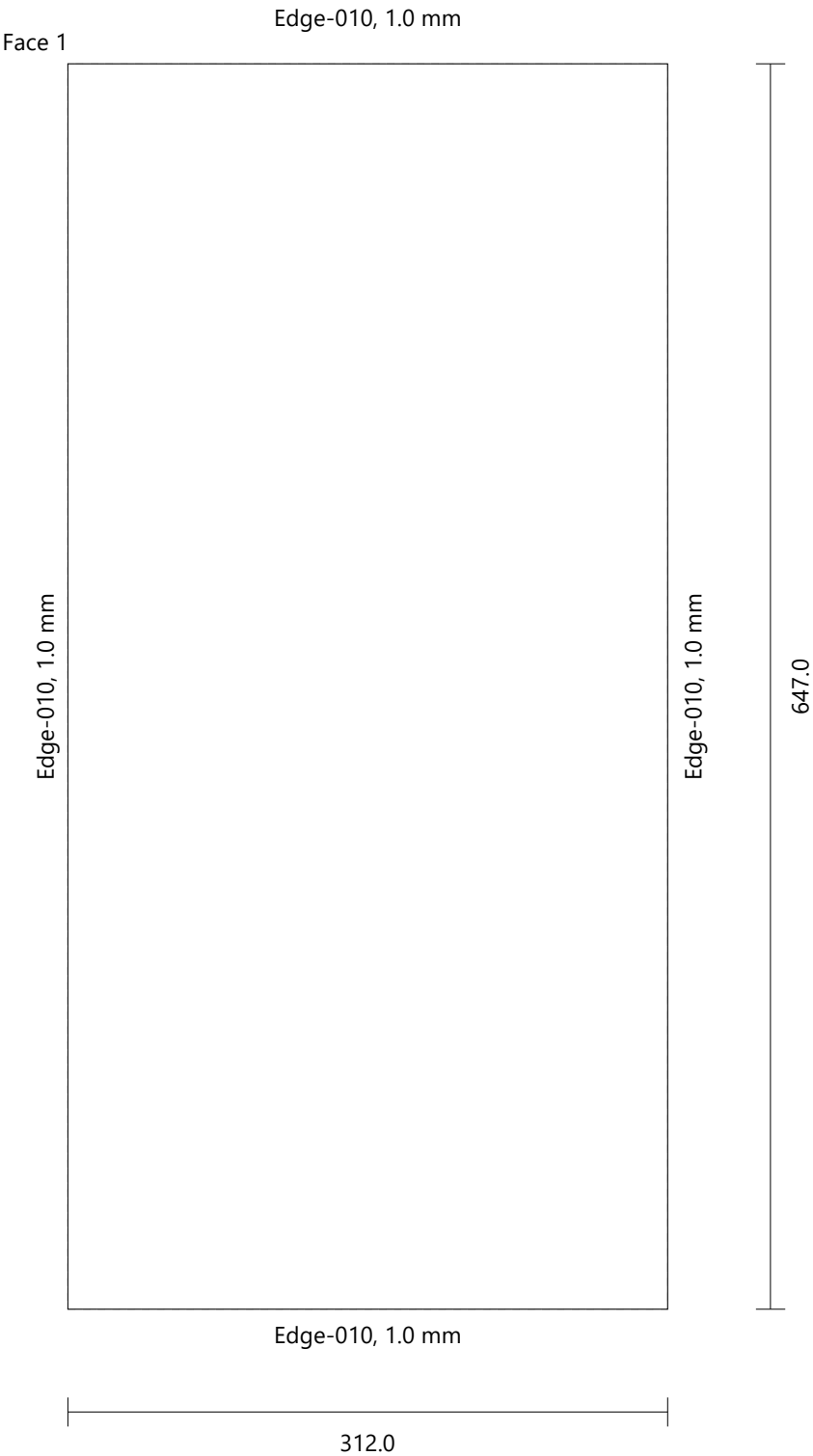

Cabinet630 Upper

Height 2060.0 mm  
Width 630.0 mm  
Depth 340.0 mm

FRONT VIEW

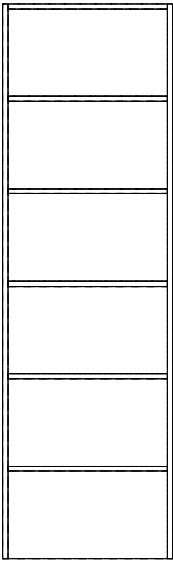

LEFT VIEW

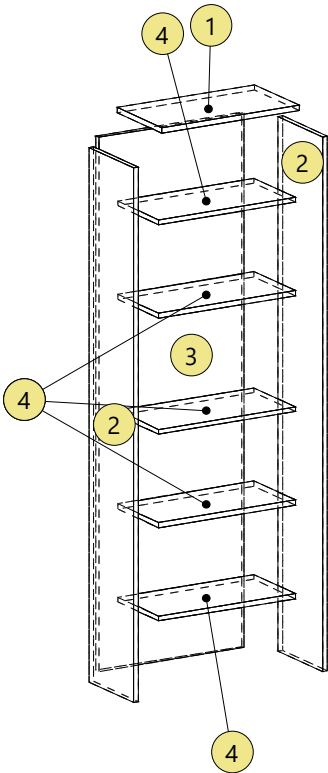
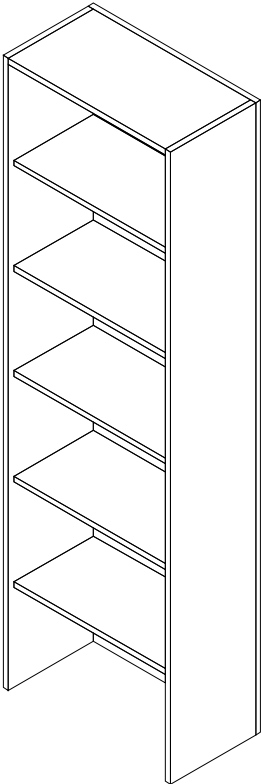
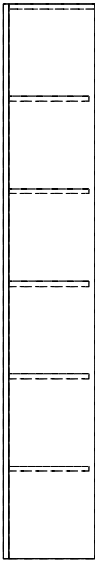

Cabinet630 Upper  
Top      Wood 0222 Oak      Height: 592.0      Width: 321.0      Thickness: 19.0      Quantity: 4

Face 1

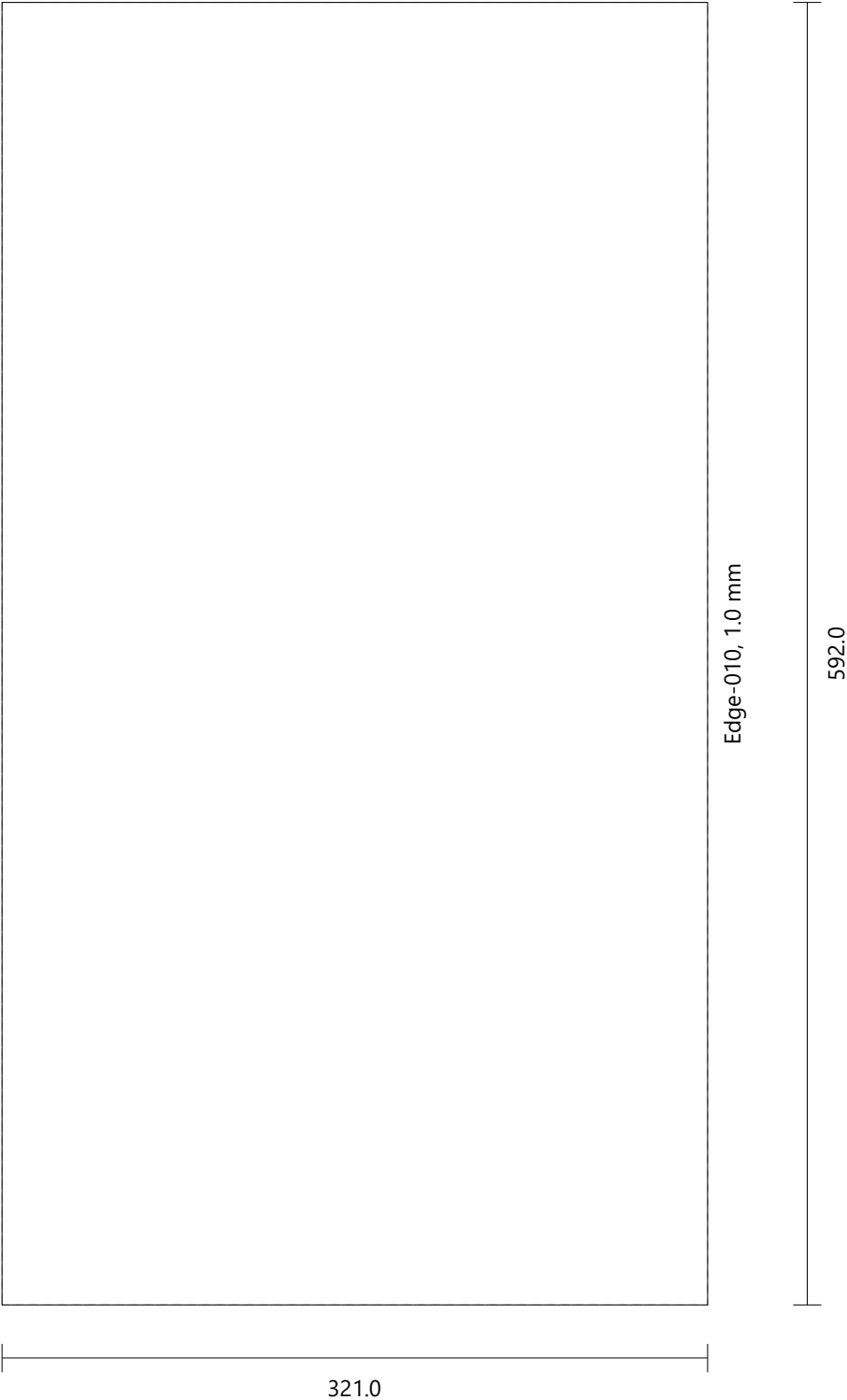

Cabinet630 Upper  
[Left, Right] Side      Wood 0222 Oak      Height: 2060.0      Width: 321.0      Thickness: 19.0      Quantity: 8

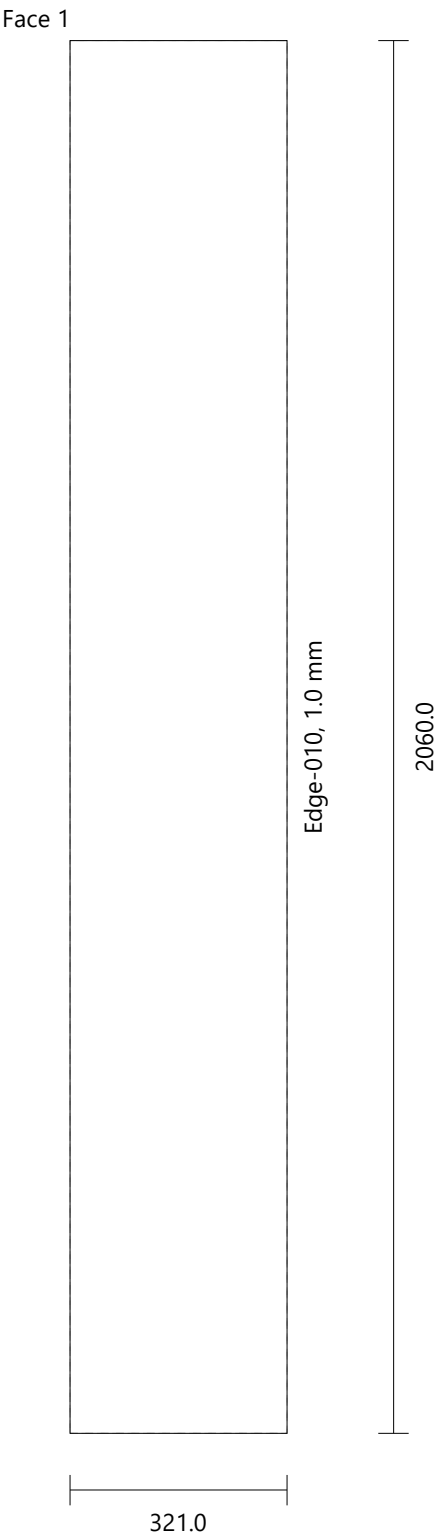

Cabinet630 Upper Back      Wood 0222 Oak      Height: 2060.0      Width: 630.0      Thickness: 19.0      Quantity: 4

Face 1

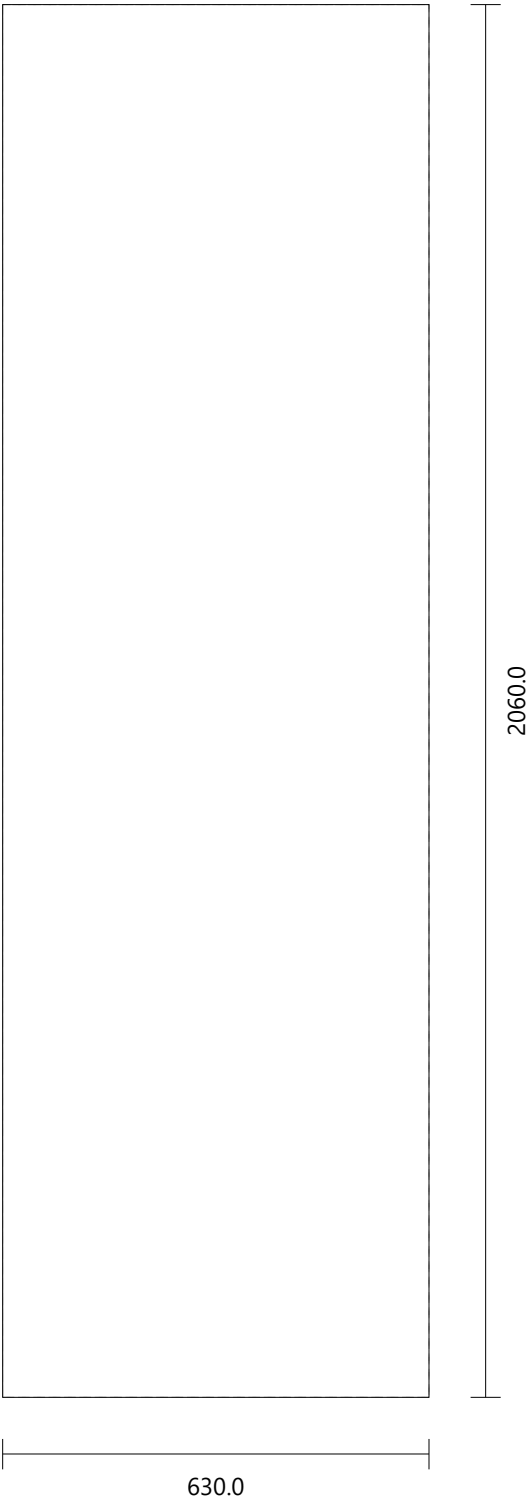

Cabinet630 Upper  
Mobile Shelf      Wood 0222 Oak      Height: 591.0      Width: 298.0      Thickness: 19.0      Quantity: 20

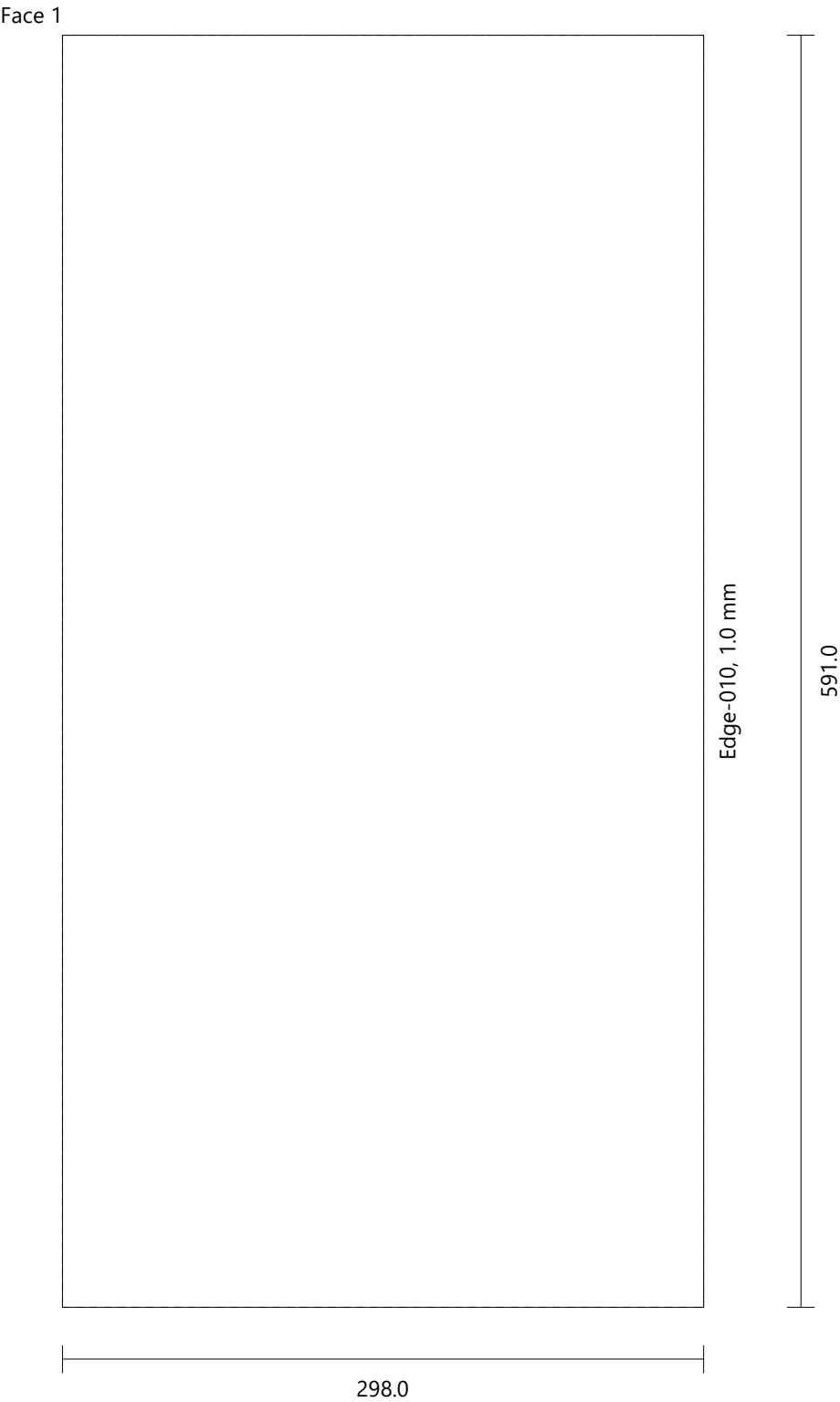



Cabinet630drawer base

Height 650.0 mm  
Width 630.0 mm  
Depth 490.0 mm

FRONT VIEW

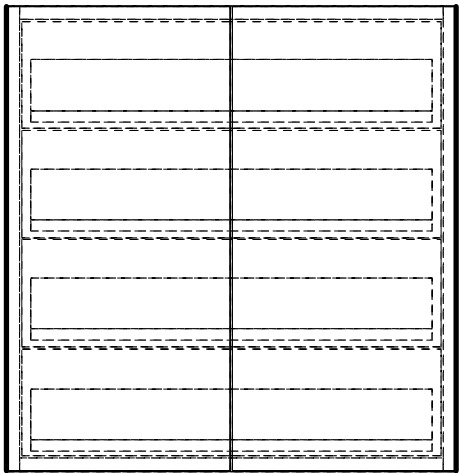

LEFT VIEW

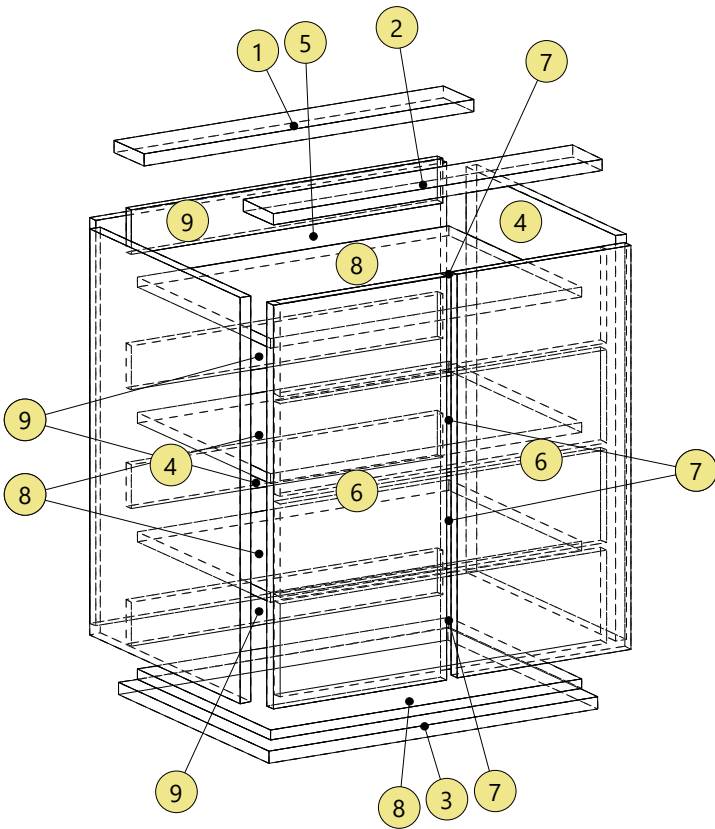
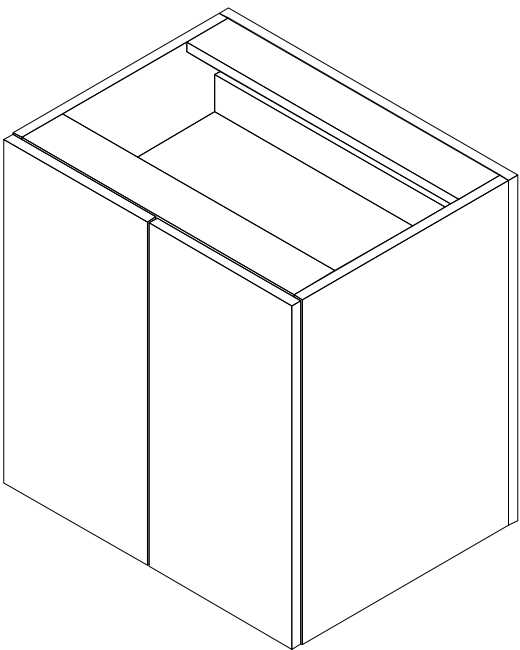
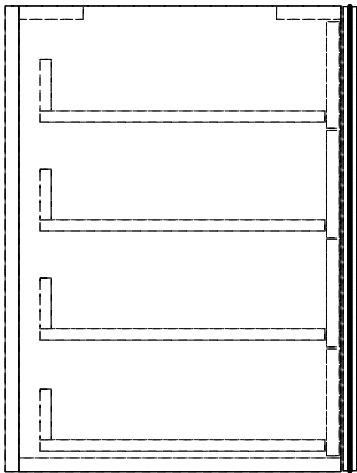

Cabinet630drawer base  
Top\_1      Wood 0222 Oak      Height: 592.0      Width: 89.8      Thickness: 19.0      Quantity: 1

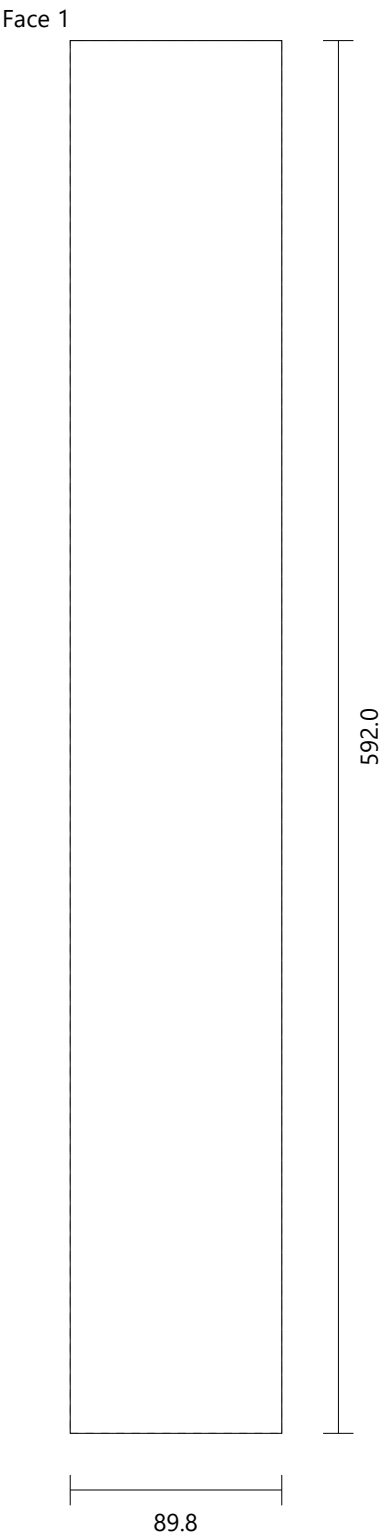

Cabinet630drawer base  
Top\_2      Wood 0222 Oak      Height: 592.0      Width: 89.8      Thickness: 19.0      Quantity: 1

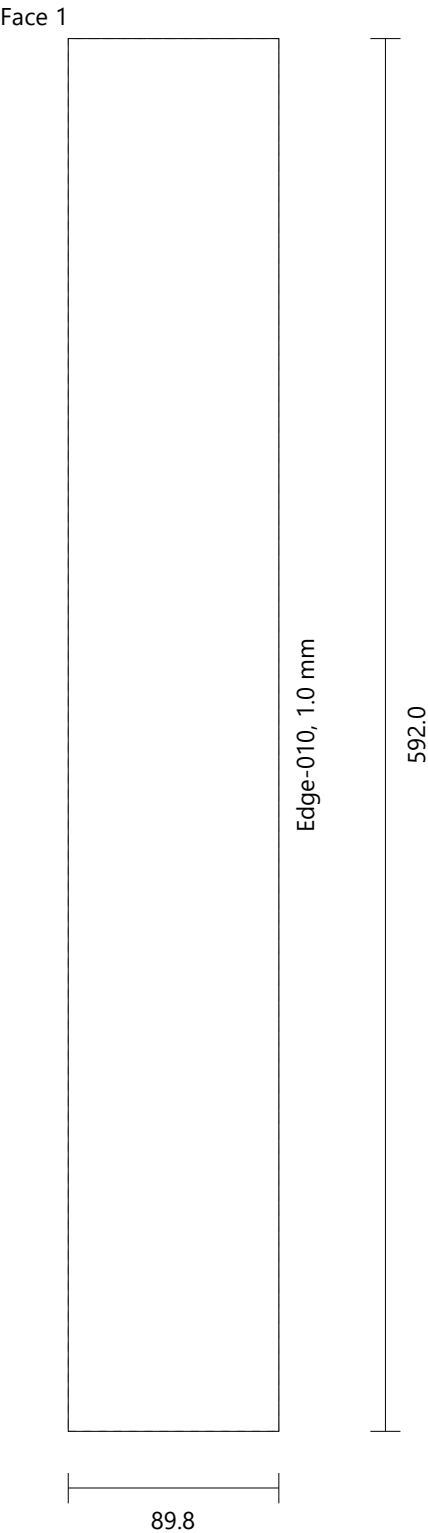

Cabinet630drawer base  
Bottom Wood 0222 Oak Height: 592.0 Width: 449.5 Thickness: 19.0 Quantity: 1

Face 1

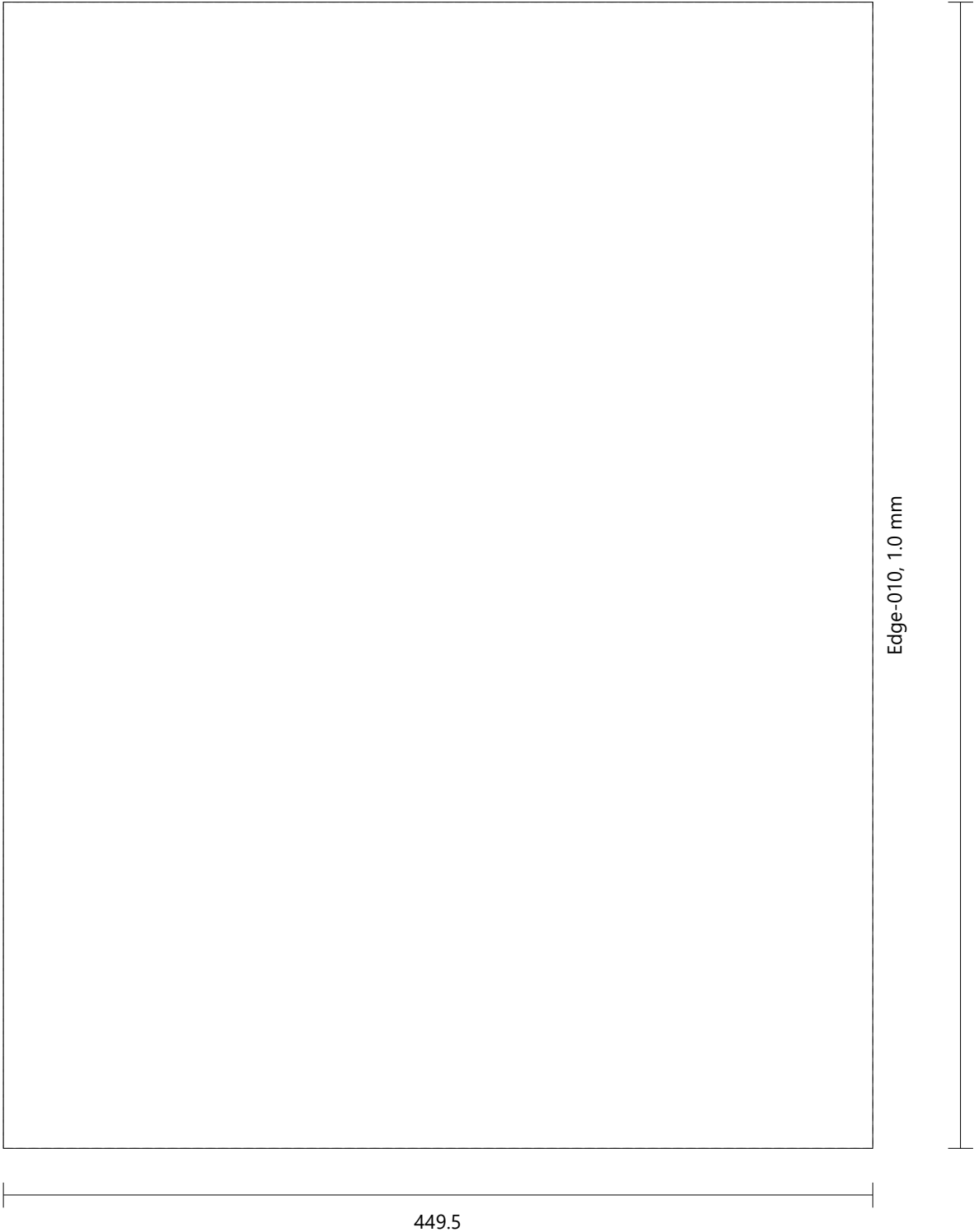

Cabinet630drawer base  
[Left, Right] Side      Wood 0222 Oak      Height: 650.0      Width: 449.5      Thickness: 19.0      Quantity: 2

Face 1

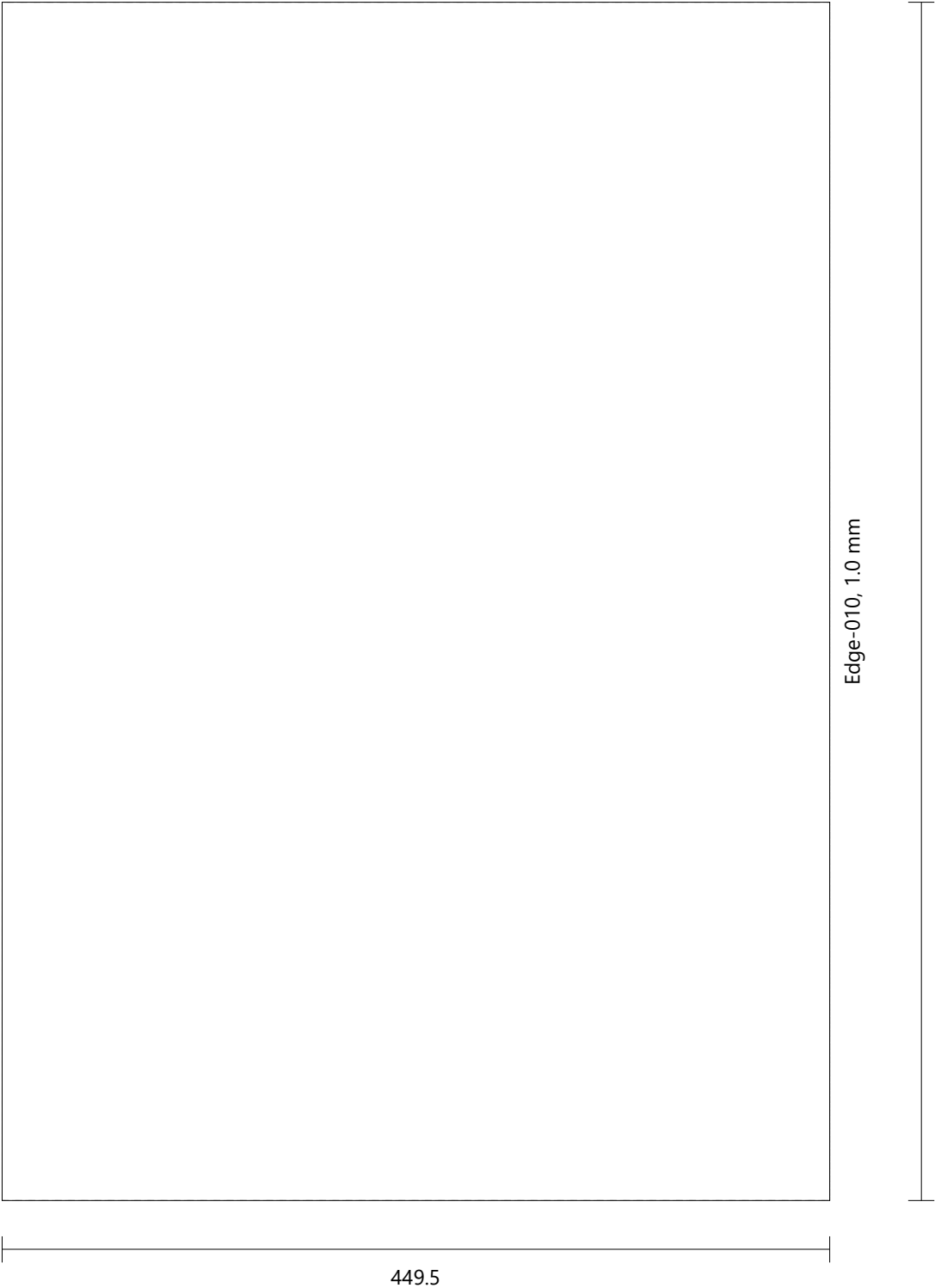

Cabinet630drawer base  
Back Wood 0222 Oak Height: 650.0 Width: 630.0 Thickness: 19.0 Quantity: 1

Face 1

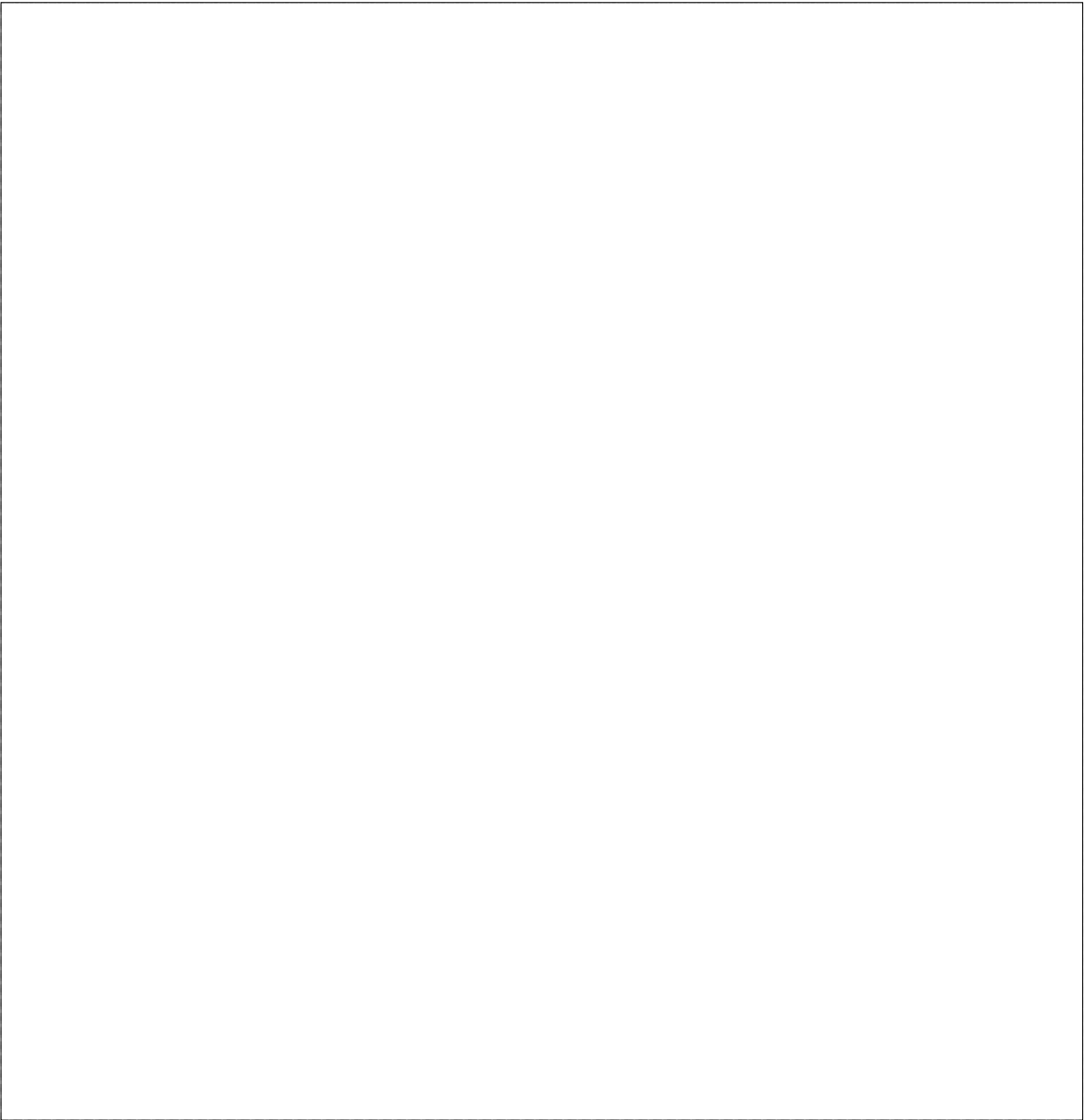

650.0

630.0

Cabinet630drawer base  
Door Std (Double) [1]      Wood 0222 Oak      Height: 647.0      Width: 312.0      Thickness: 19.0      Quantity: 2

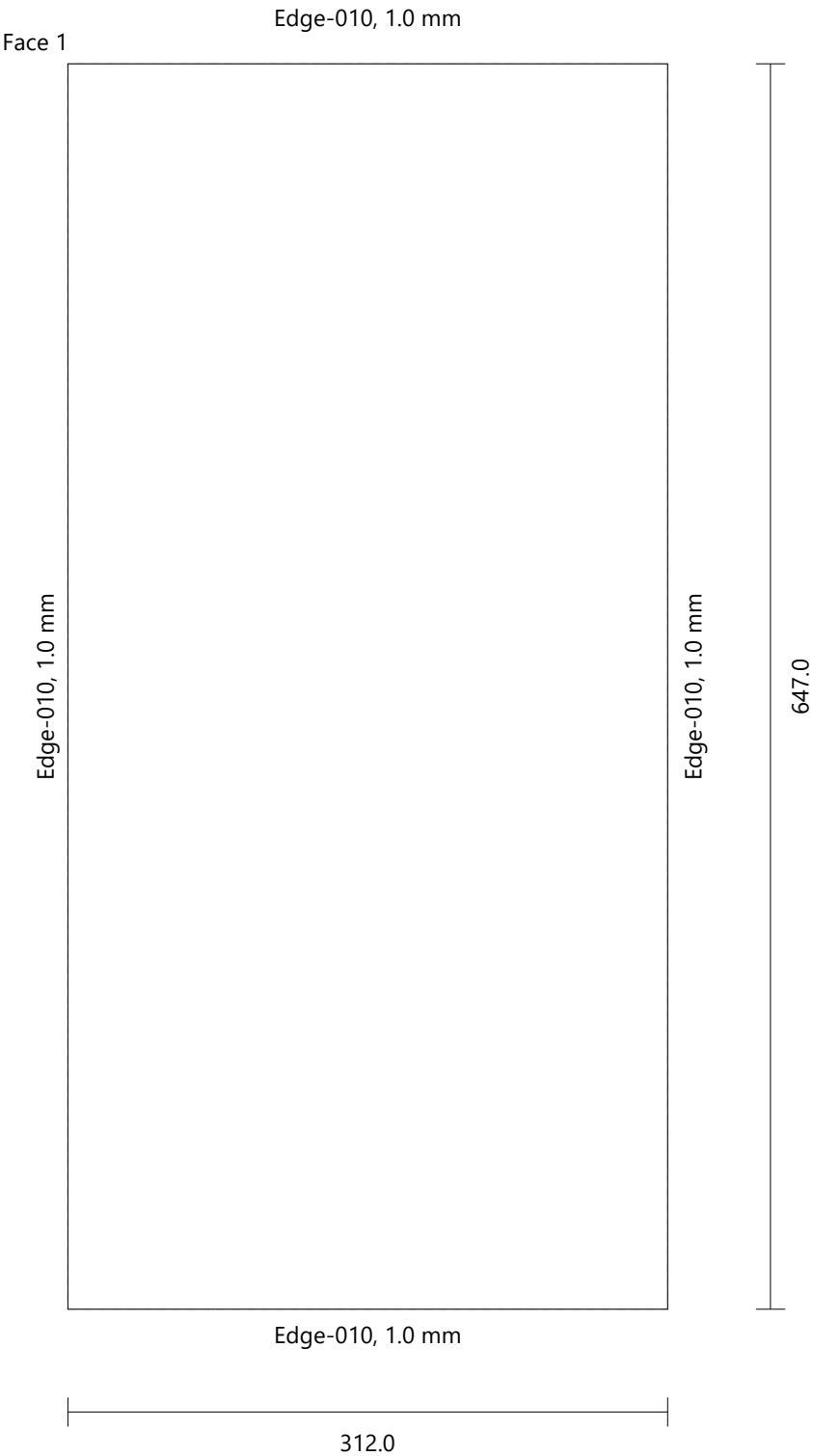

Cabinet630drawer base  
Drawer 400 [1]      Generic 0181      Height: 149.3      Width: 586.0      Thickness: 18.0      Quantity: 4

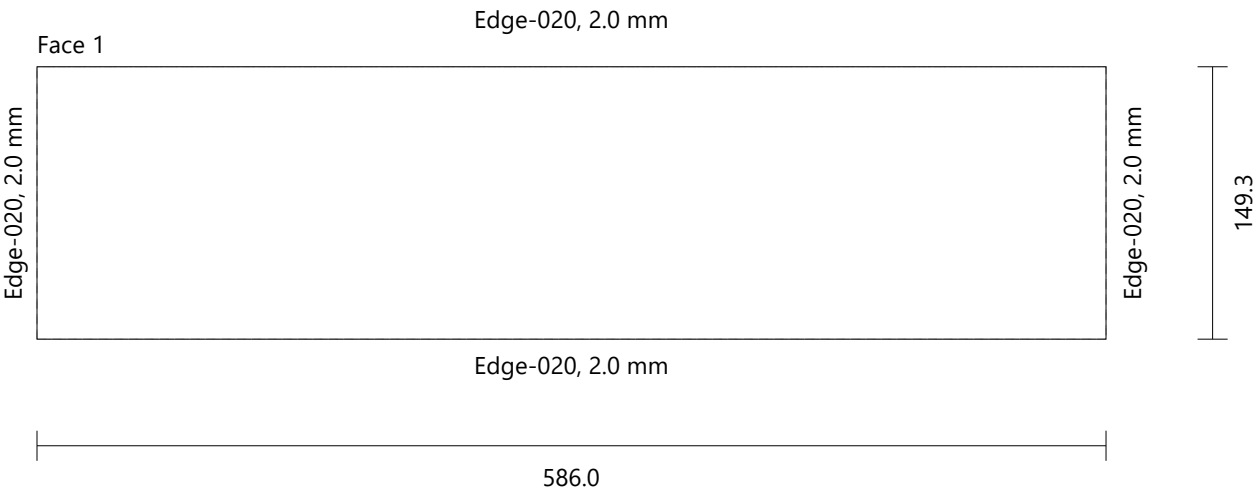



Cabinet630drawer base  
Bottom Drawer 400 [1]      Generic 0160      Height: 560.0      Width: 398.0      Thickness: 16.0      Quantity: 4

Face 1

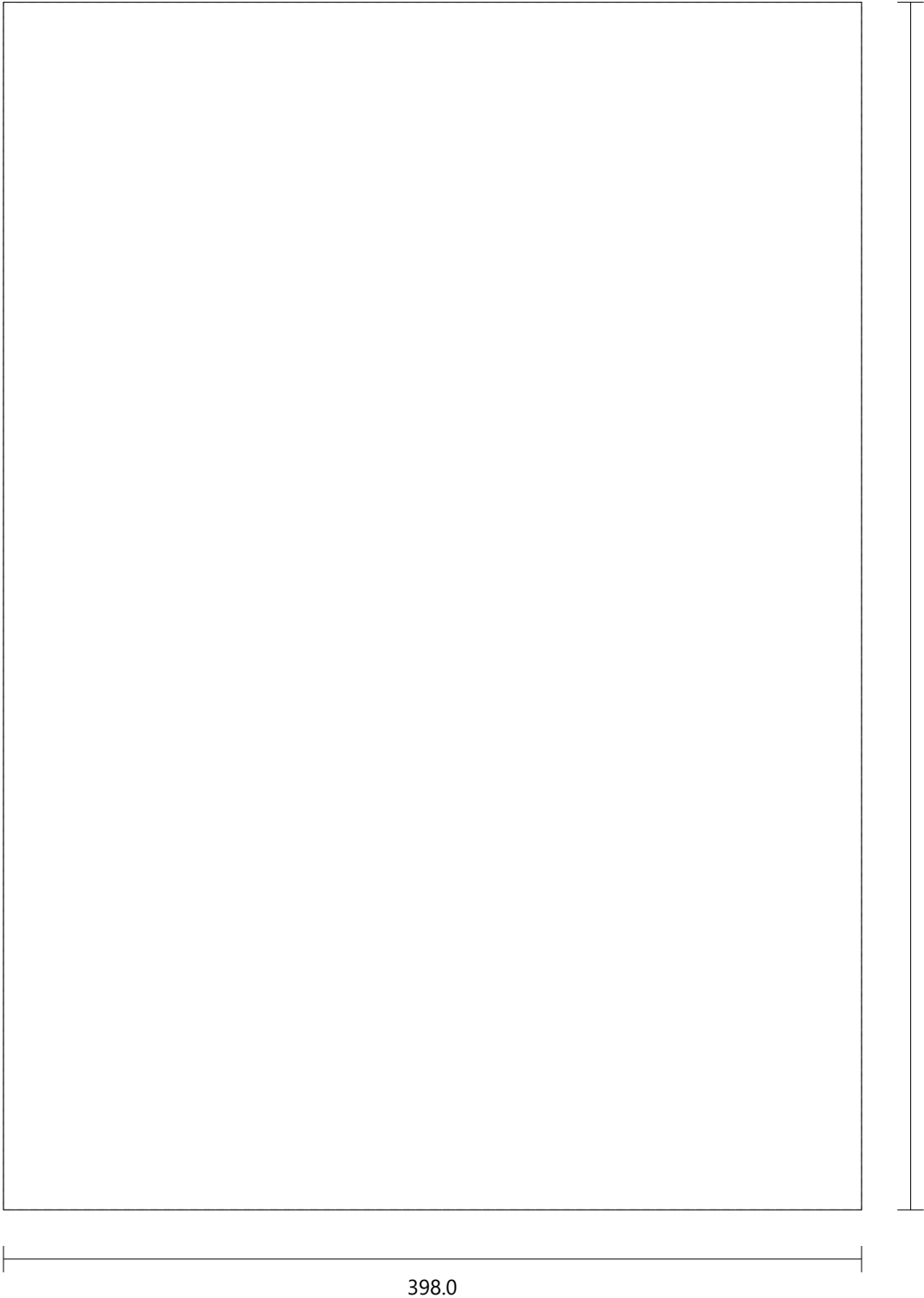

Cabinet630drawer base  
Back Drawer 400 [1]      Generic 0160      Height: 560.0      Width: 71.0      Thickness: 16.0      Quantity: 4

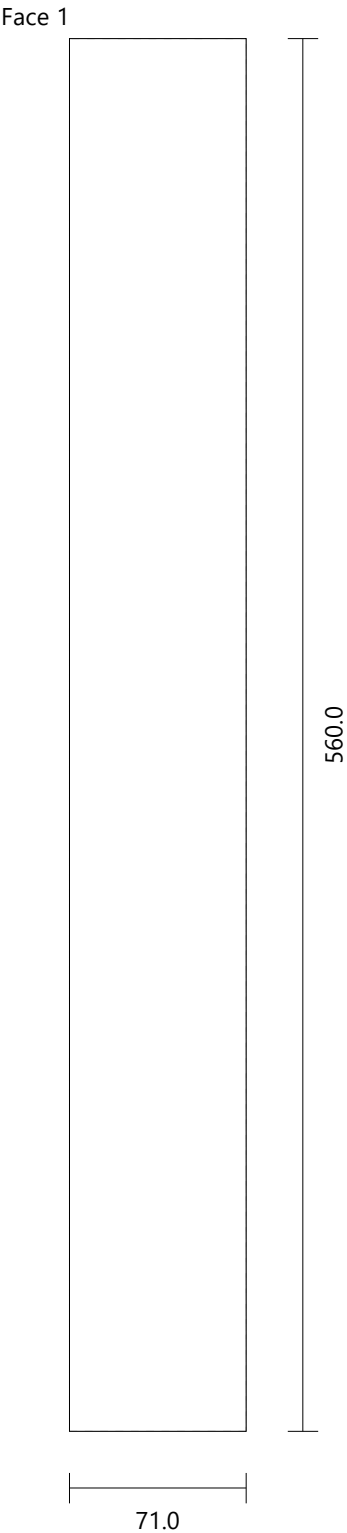

Cabinet630glass Upper

Height 2060.0 mm  
Width 630.0 mm  
Depth 340.0 mm

FRONT VIEW

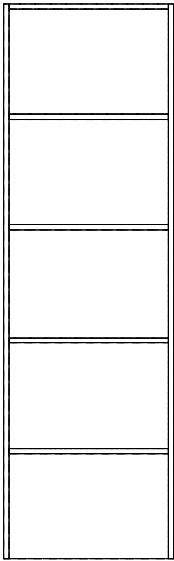

LEFT VIEW

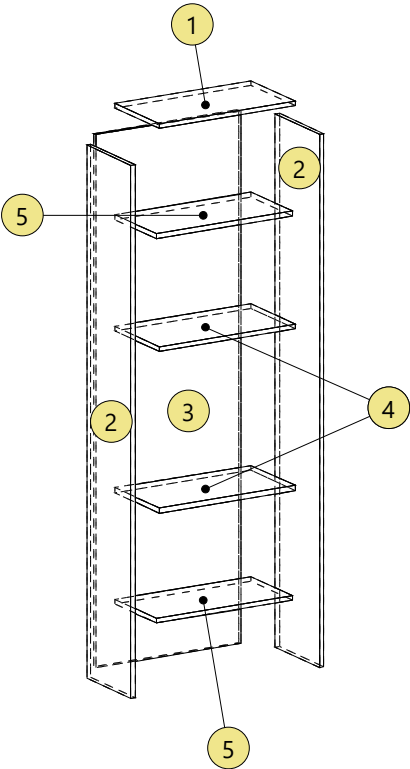
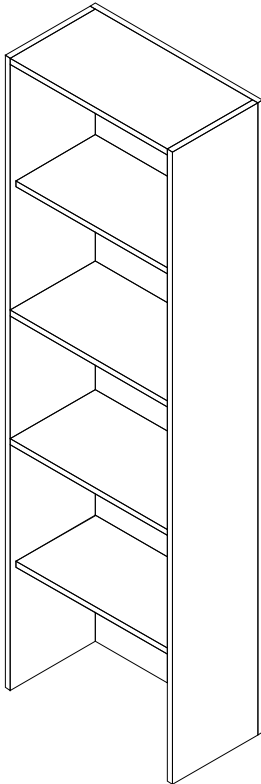

Cabinet630glass Upper  
Top Wood 0222 Oak Height: 592.0 Width: 321.0 Thickness: 19.0 Quantity: 1

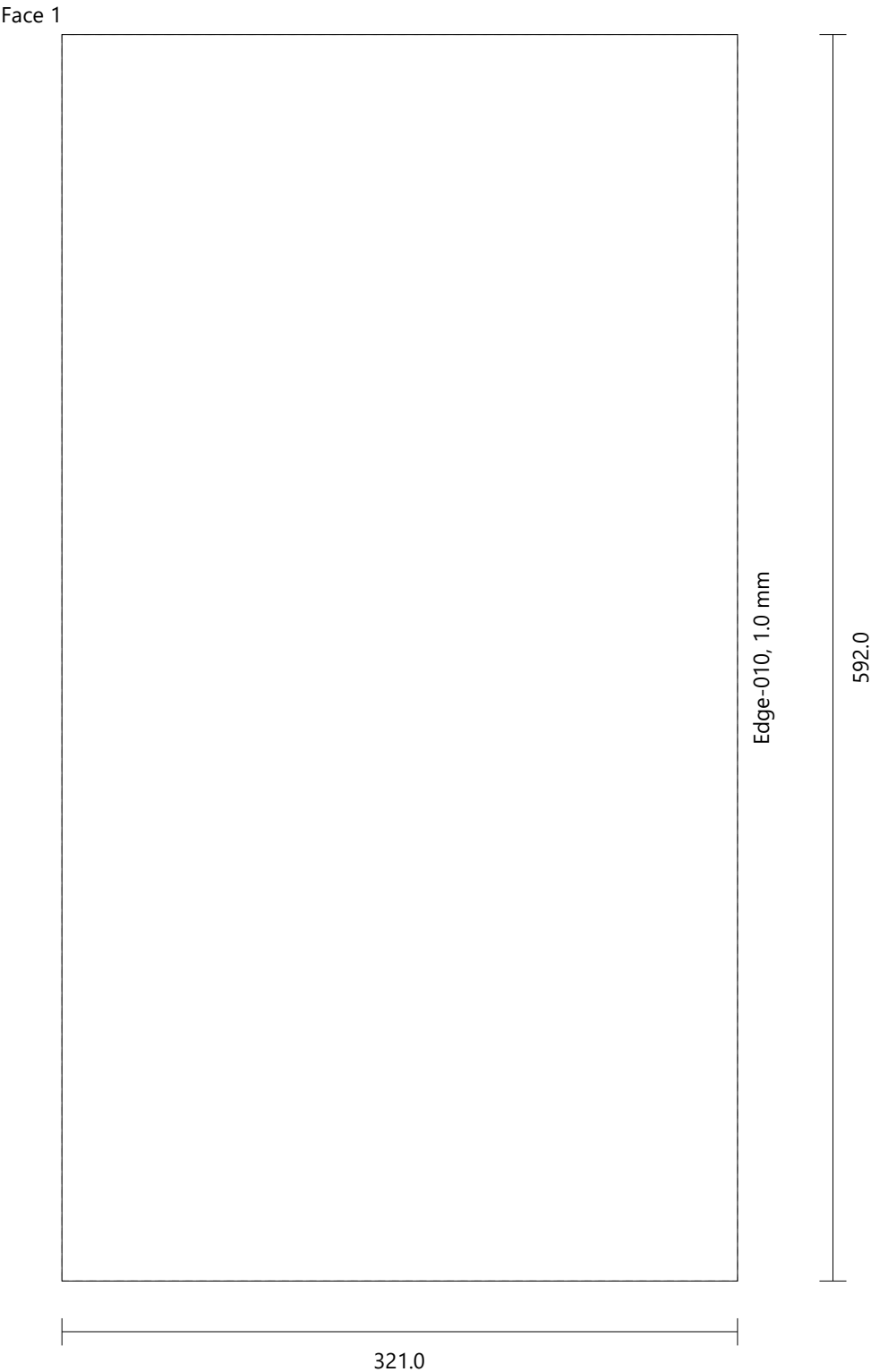

Cabinet630glass Upper  
[Left, Right] Side      Wood 0222 Oak      Height: 2060.0      Width: 321.0      Thickness: 19.0      Quantity: 2

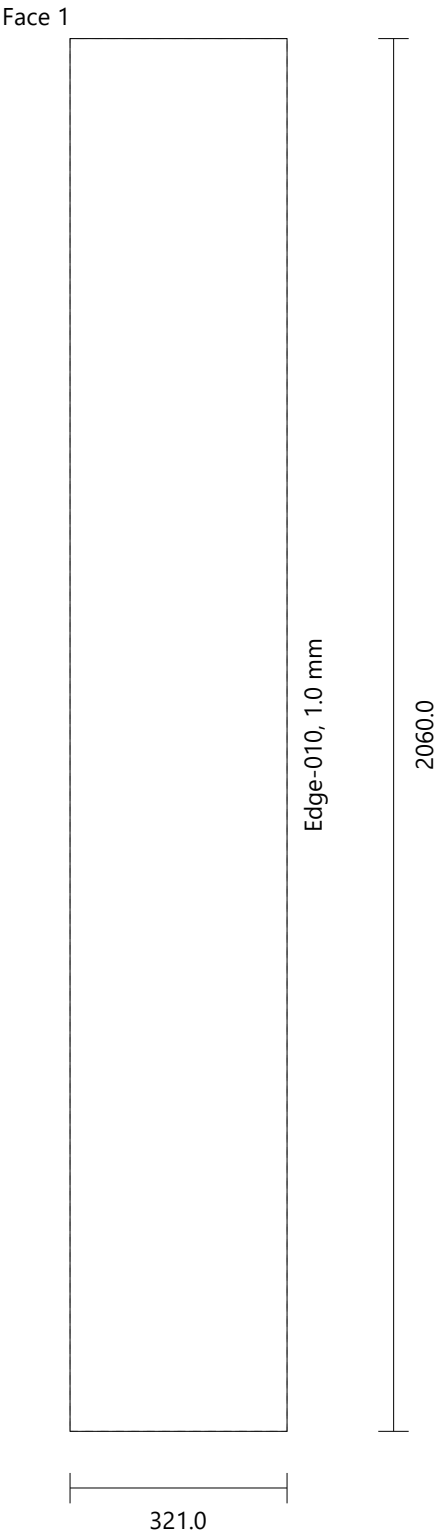

Cabinet630glass Upper  
Back Wood 0222 Oak Height: 2060.0 Width: 630.0 Thickness: 19.0 Quantity: 1

Face 1

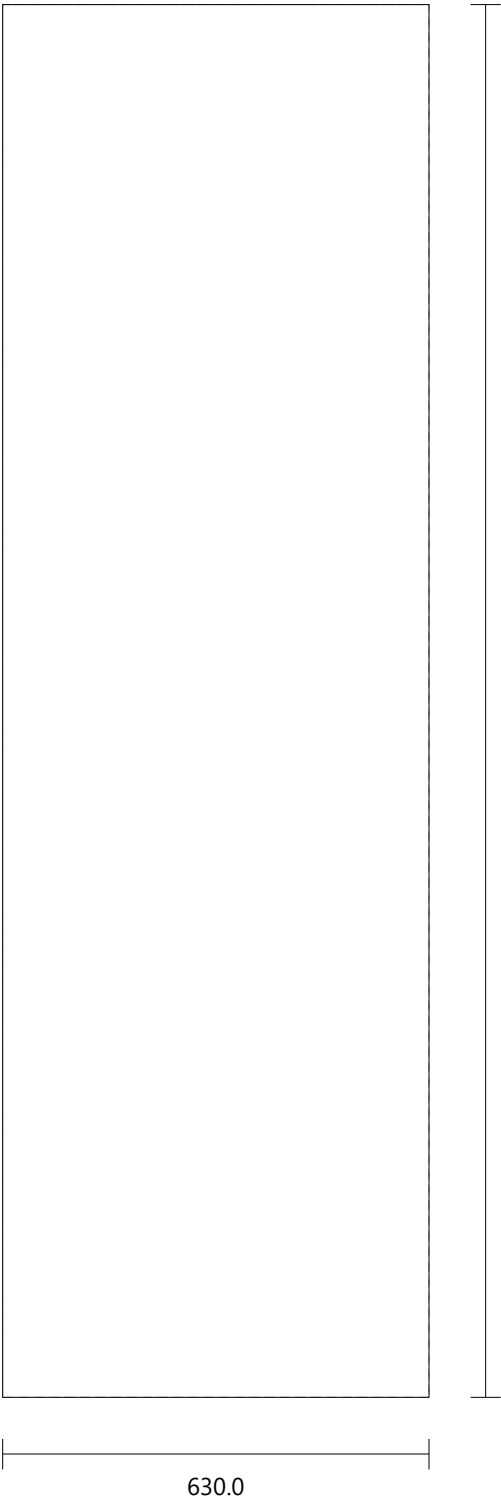

Cabinet630glass Upper  
Fixed Shelf      Wood 0222 Oak      Height: 592.0      Width: 321.0      Thickness: 19.0      Quantity: 2

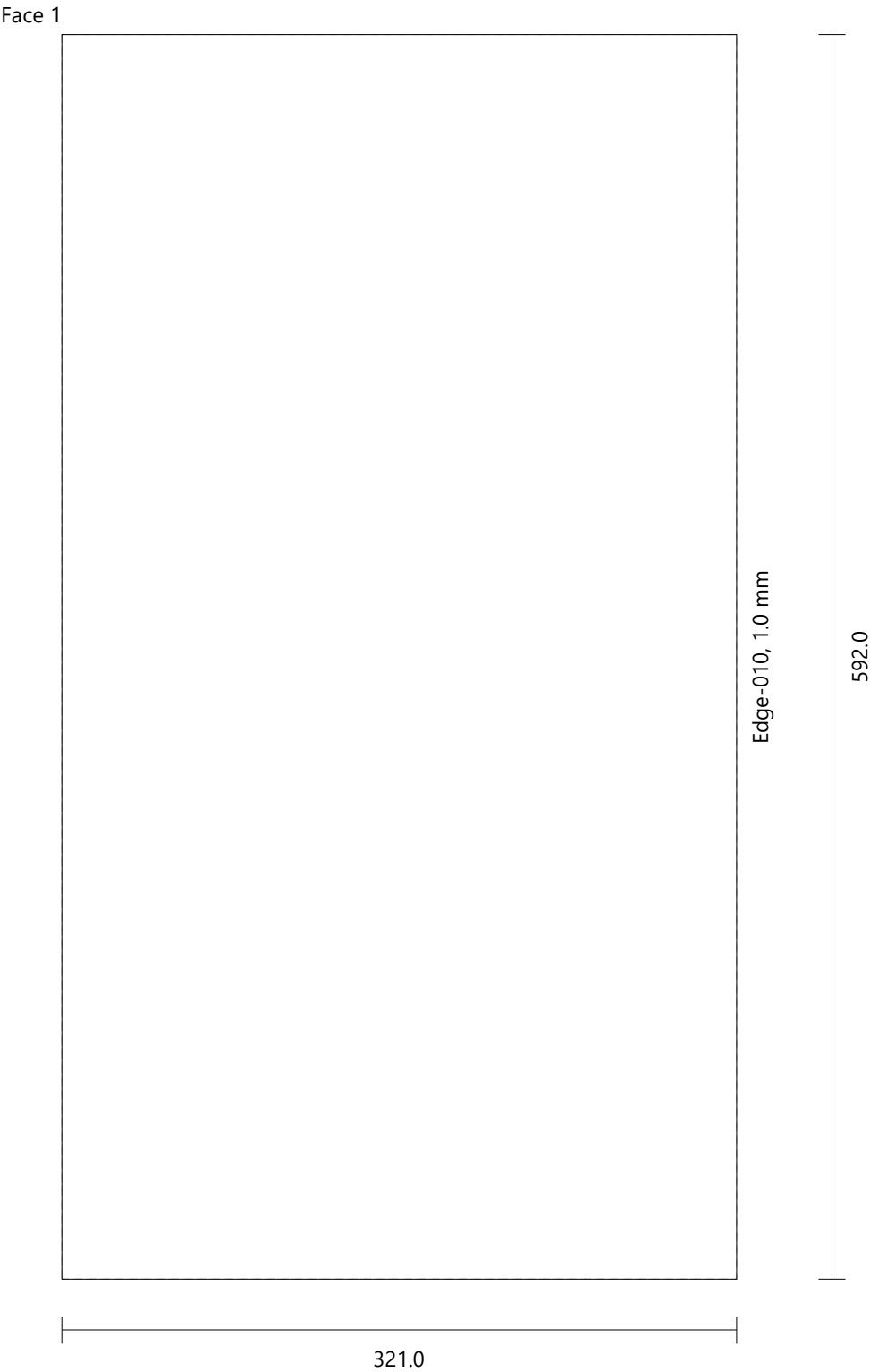

Cabinet630glass Upper  
Mobile Shelf      Wood 0222 Oak      Height: 591.0      Width: 298.0      Thickness: 19.0      Quantity: 2

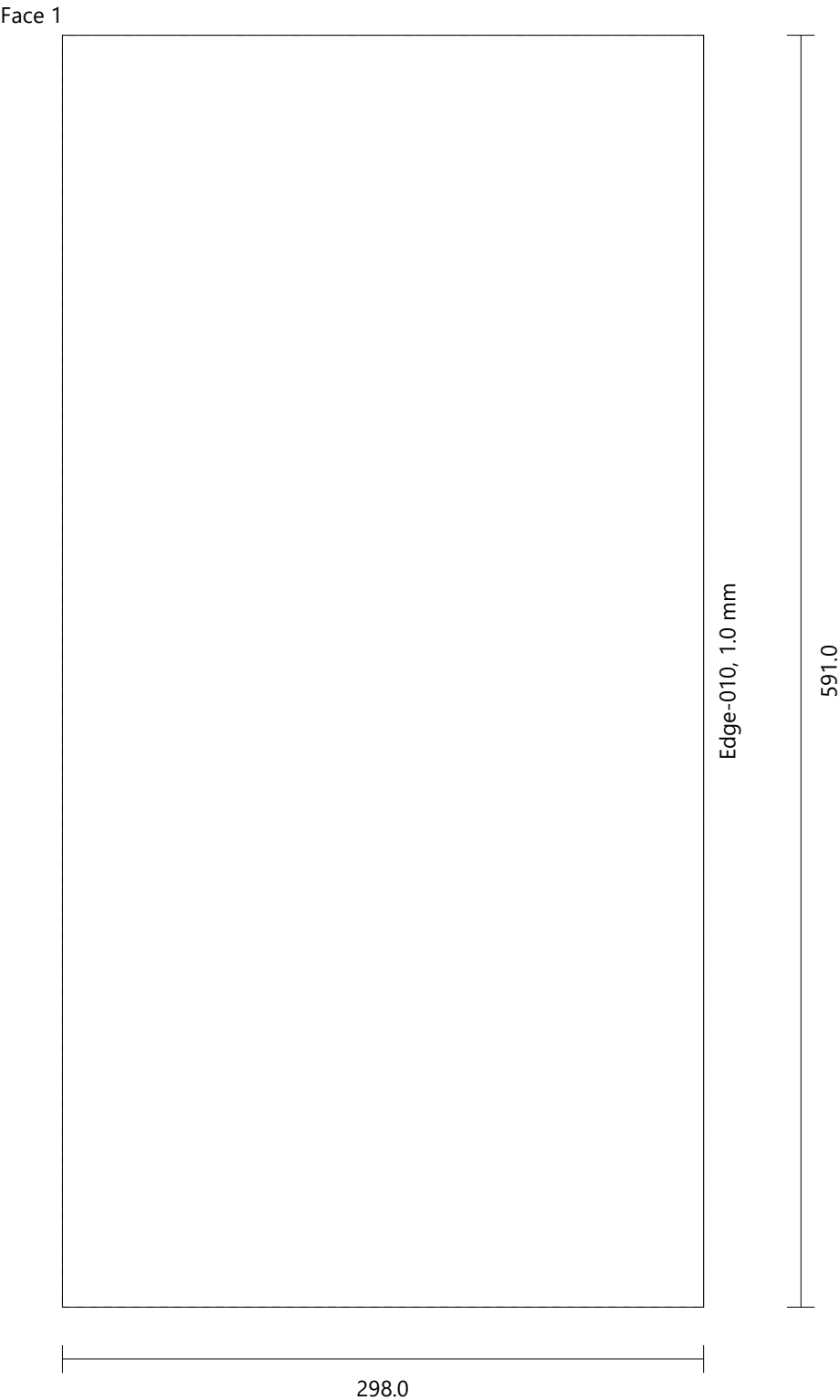



Left Filler

Height	2848.0 mm
Width	69.0 mm
Depth	70.0 mm
Height (Upper Strip)	0.0 mm
Elevation (Plinth)	0.0 mm
Width (Left Side)	50.0 mm

FRONT VIEW



LEFT VIEW

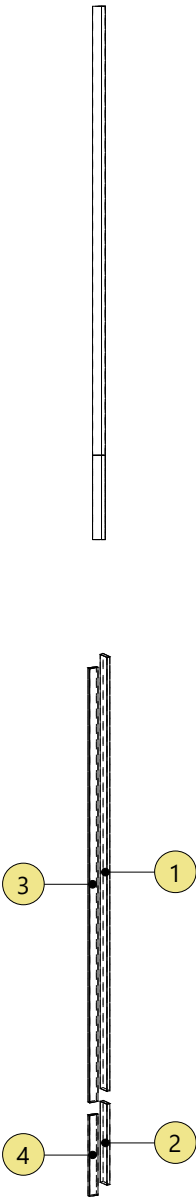

Left Filler  
Left Side\_1      Wood 0222 Oak      Height: 2400.0      Width: 70.0      Thickness: 19.0      Quantity: 1

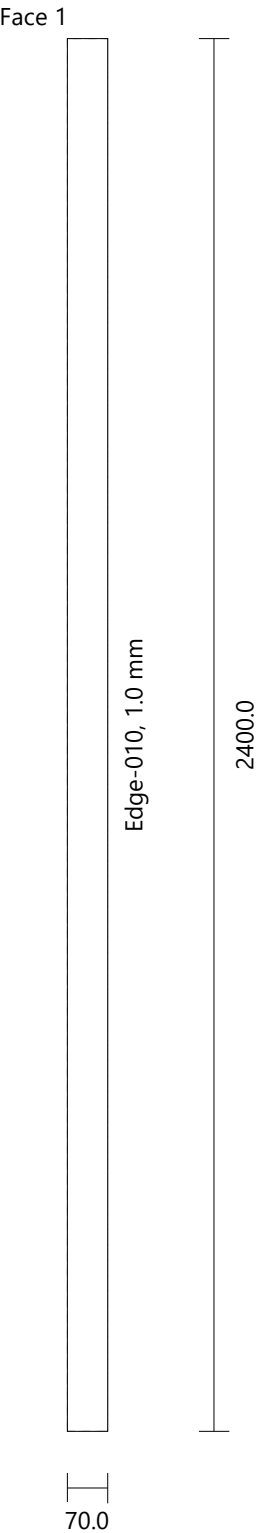

Left Filler  
Left Side\_2      Wood 0222 Oak      Height: 448.0      Width: 70.0      Thickness: 19.0      Quantity: 1

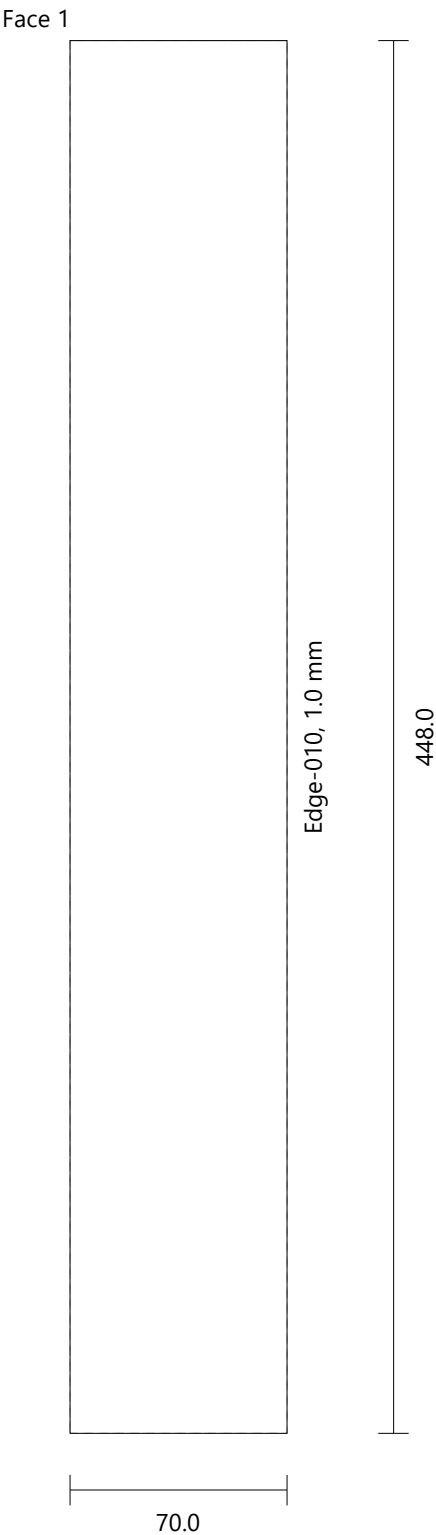

Left Filler  
Filler 1 [1]\_1      Wood 0222 Oak      Height: 2400.0      Width: 50.0      Thickness: 19.0      Quantity: 1

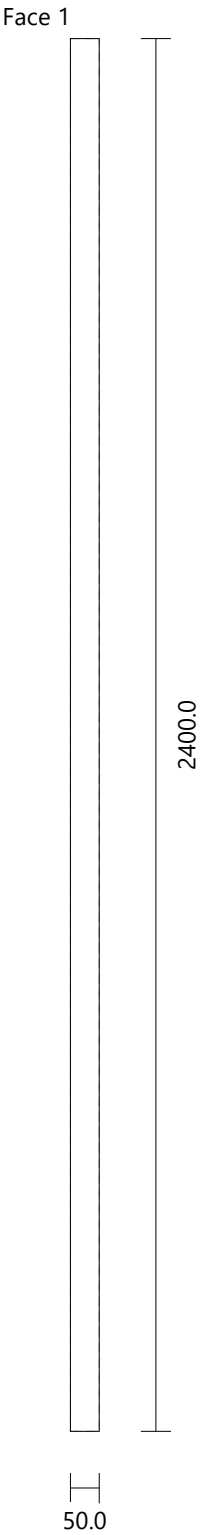

Left Filler  
Filler 1 [1]\_2      Wood 0222 Oak      Height: 448.0      Width: 50.0      Thickness: 19.0      Quantity: 1

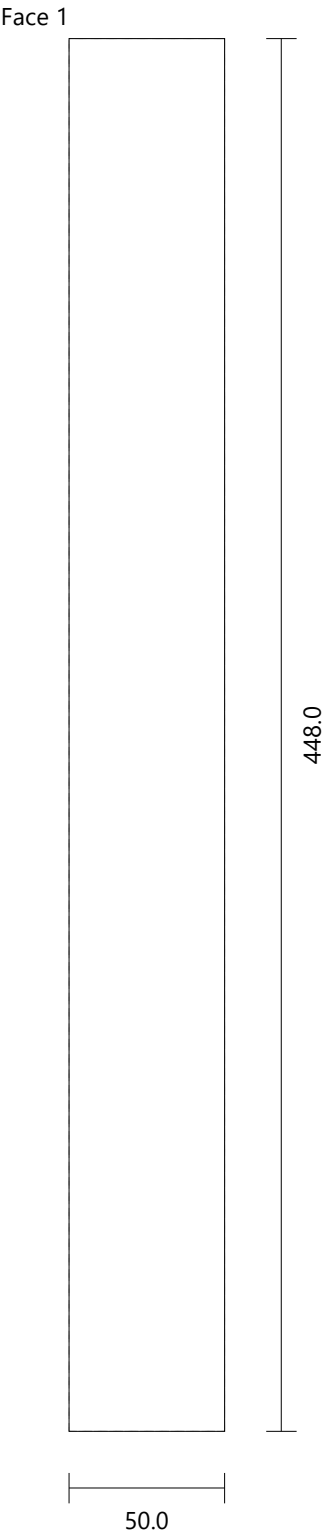

Plinth

Height 100.0 mm  
Width 3950.0 mm  
Depth 69.0 mm

FRONT VIEW

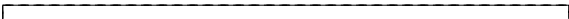

LEFT VIEW

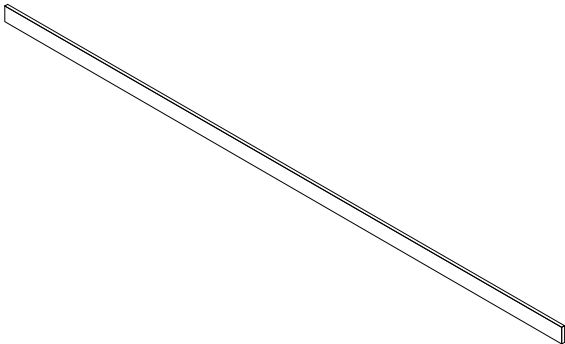

Plinth				
Back	Wood 0222 Oak	Height: 100.0	Width: 3950.0	Thickness: 19.0
Drilling	A (28)	Diameter: 4.0	Depth: Through (0.0)	Quantity: 1

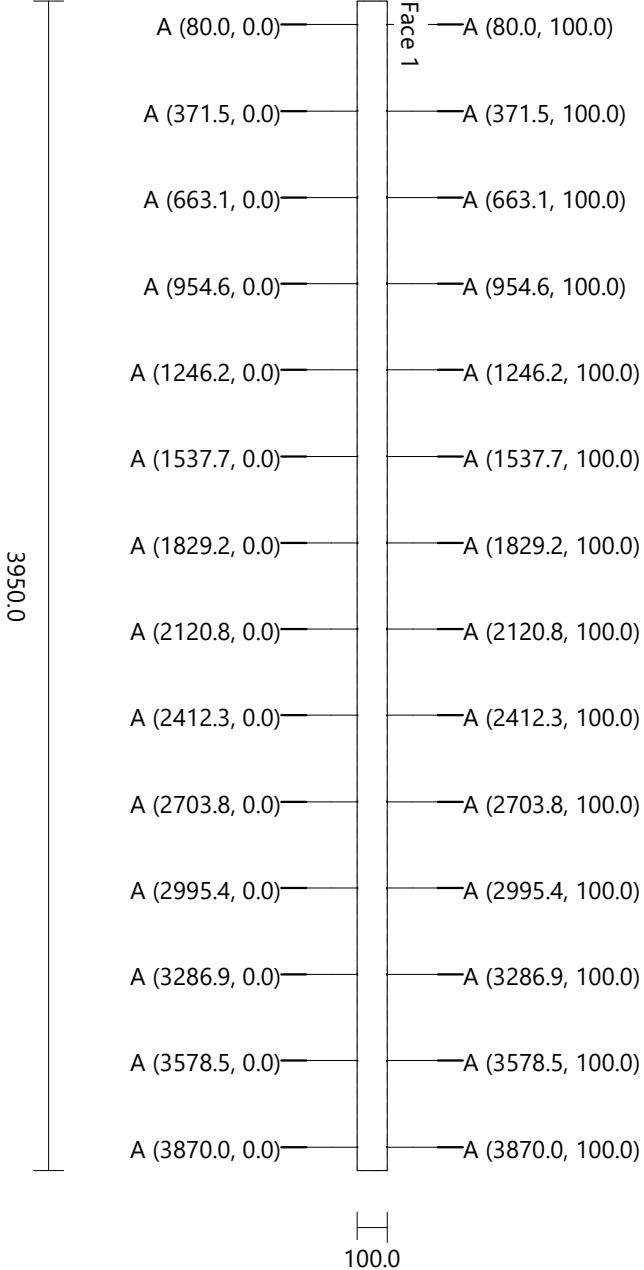

**rail**

Height 19.0 mm  
Width 3950.0 mm  
Depth 200.0 mm

FRONT VIEW



LEFT VIEW

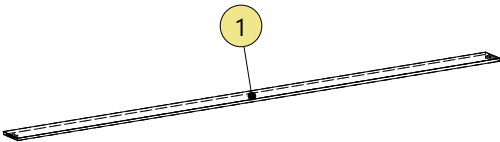
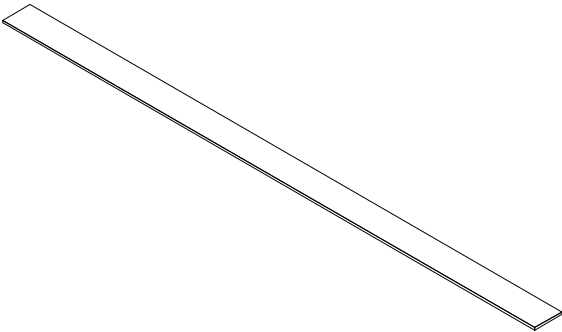



rail					
Top		Wood 0222 Oak	Height: 3950.0	Width: 200.0	Thickness: 19.0
Drilling	A (4)	Diameter: 8.0	Depth: 28.0		Quantity: 1
	B (8)	Diameter: 8.0	Depth: 21.5		
	C (4)	Diameter: 15.0	Depth: 14.0		

A (80.0, 9.5) B (112.0, 9.5) B (152.0, 9.5)  
B (48.0, 9.5) B (88.0, 9.5) A (120.0, 9.5)

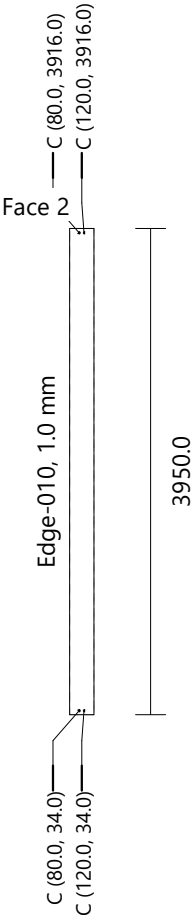

B (48.0, 9.5) B (88.0, 9.5) A (120.0, 9.5)  
A (80.0, 9.5) B (112.0, 9.5) B (152.0, 9.5)

200.0

Right filler

Height	2848.0 mm
Width	69.0 mm
Depth	70.0 mm
Height (Upper Strip)	0.0 mm
Elevation (Plinth)	0.0 mm
Width (Right Side)	50.0 mm

FRONT VIEW



LEFT VIEW

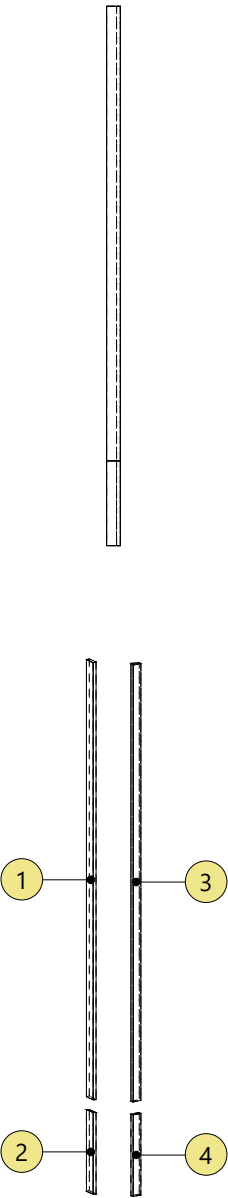

Right filler  
Right Side\_1      Wood 0222 Oak      Height: 2400.0      Width: 70.0      Thickness: 19.0      Quantity: 1

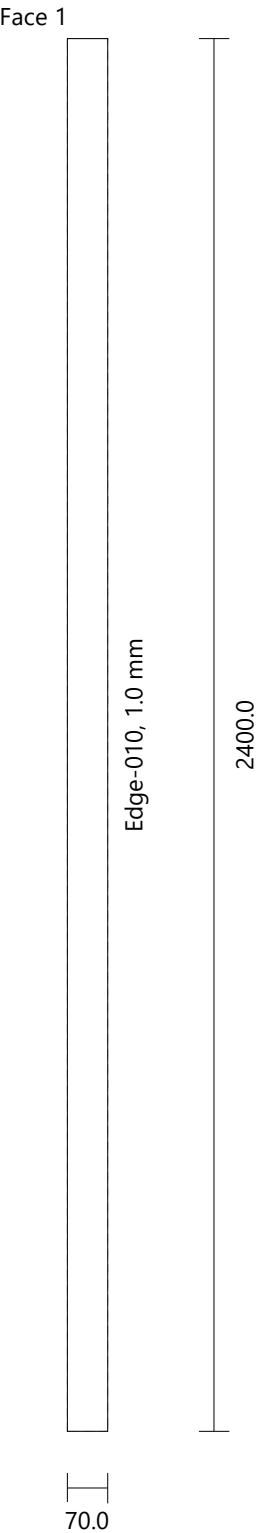

Right filler  
Right Side\_2      Wood 0222 Oak      Height: 448.0      Width: 70.0      Thickness: 19.0      Quantity: 1

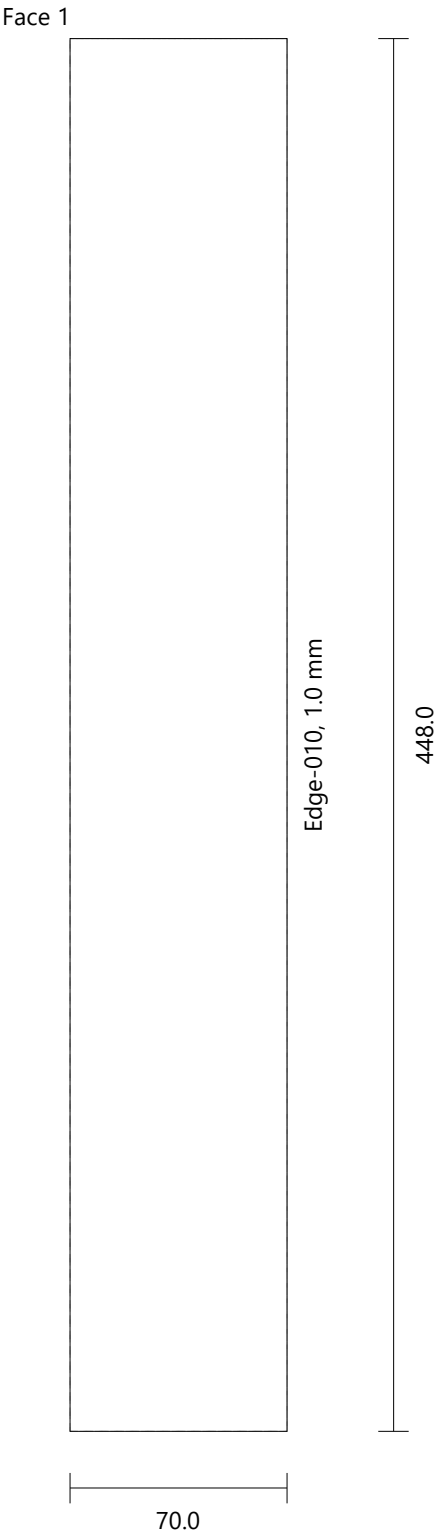

Right filler  
Filler 1 [1]\_1      Wood 0222 Oak      Height: 2400.0      Width: 50.0      Thickness: 19.0      Quantity: 1

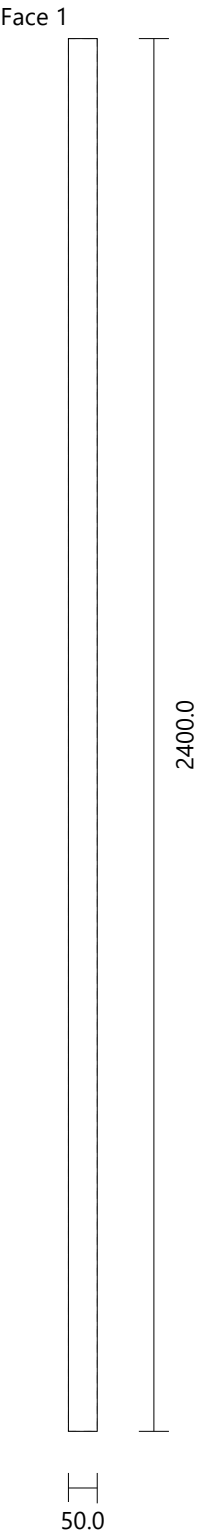

Right filler  
Filler 1 [1]\_2      Wood 0222 Oak      Height: 448.0      Width: 50.0      Thickness: 19.0      Quantity: 1

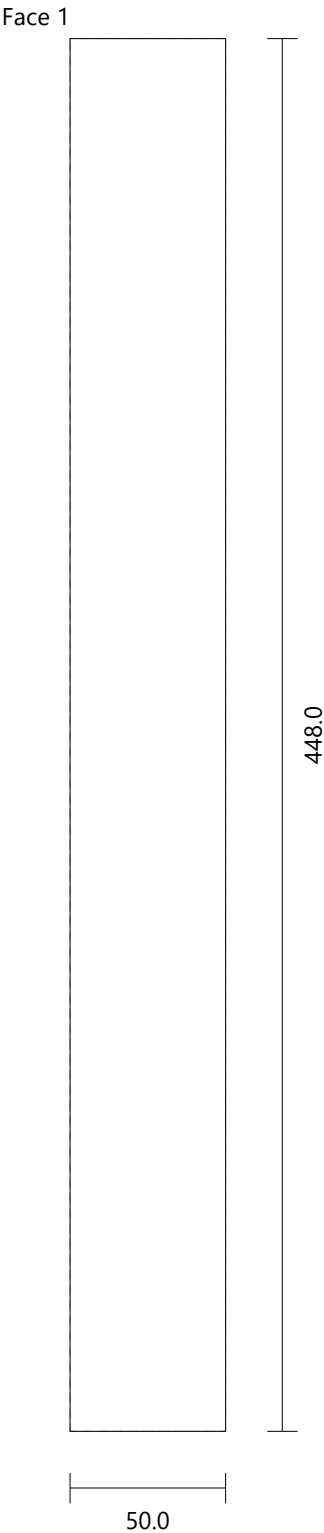

side board

Height 19.0 mm  
Width 3950.0 mm  
Depth 470.0 mm

FRONT VIEW



LEFT VIEW

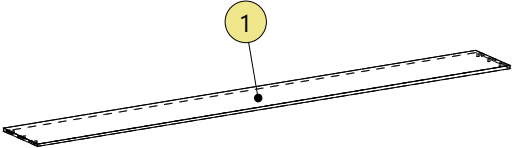
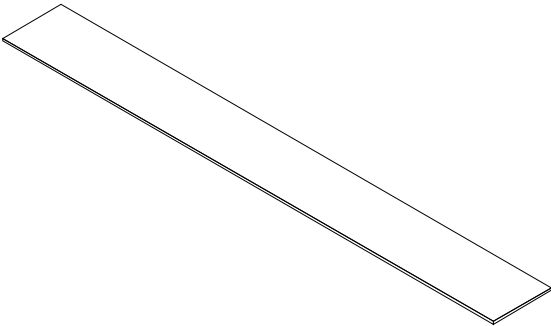

side board					
Top	Wood 0222 Oak	Height: 3950.0	Width: 470.0	Thickness: 19.0	Quantity: 1
Drilling	A (6)	Diameter: 8.0	Depth: 28.0		
	B (12)	Diameter: 8.0	Depth: 21.5		
	C (6)	Diameter: 15.0	Depth: 14.0		

A (80.0, 9.5) B (203.0, 9.5) B (267.0, 9.5) A (390.0, 9.5)  
B (48.0, 9.5) B (112.0, 9.5) A (235.0, 9.5) B (358.0, 9.5) B (422.0, 9.5)

