

StairDesigner

Landen

landen01v02

Scale : 1/18

Multi-Flight Stair

Risers : 14

Floor Height : 100 3/8"

Riser Height

: 7 3/16"

Tread Width

: 9 1/2"

Stair Rule

: 23 13/16"

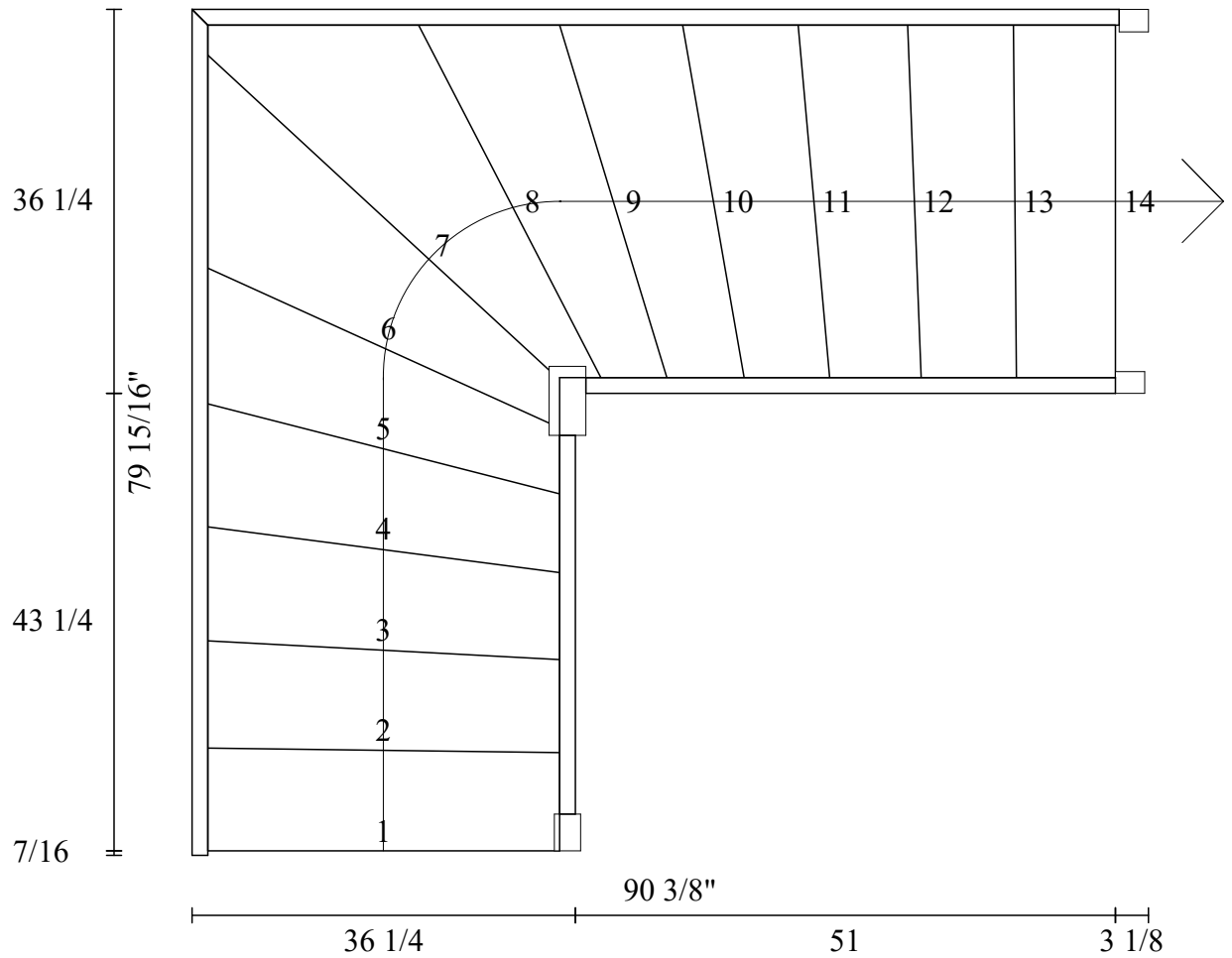

StairDesigner
Step : 1

Landen

landen01v02
Scale : 1/12

Step : $33 \frac{1}{4} \times 10 \frac{13}{16}$

Riser

Width : $33 \frac{1}{4}$ Height : $6 \frac{1}{16}$ Thickness : $\frac{3}{4}$ Angle : 0.00

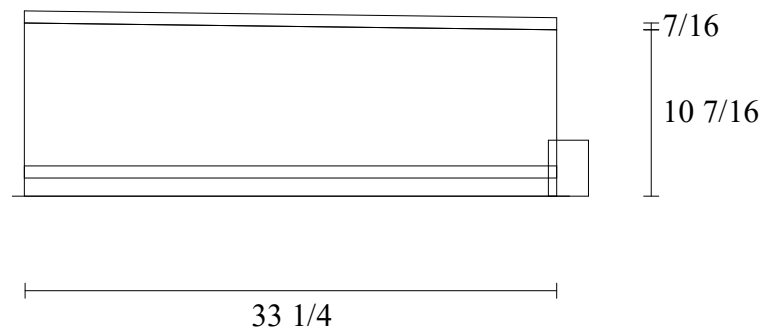

StairDesigner
Step : 2

Landen

landen01v02
Scale : 1/12

Step : $33 \frac{3}{8} \times 11 \frac{5}{16}$

Riser

Width : $33 \frac{1}{4}$ Height : $7 \frac{9}{16}$ Thickness : $\frac{3}{4}$ Angle : 0.71

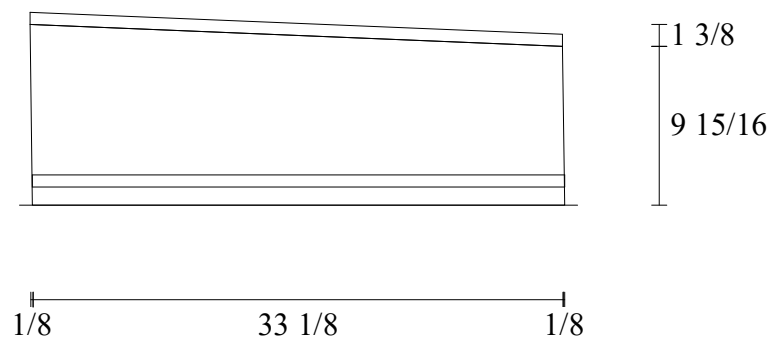

StairDesigner
Step : 3

Landen

landen01v02
Scale : 1/12

Step : $33 \frac{15}{16} \times 11 \frac{7}{8}$

Riser

Width : $33 \frac{5}{16}$ Height : $7 \frac{9}{16}$ Thickness : $\frac{3}{4}$ Angle : 3.06

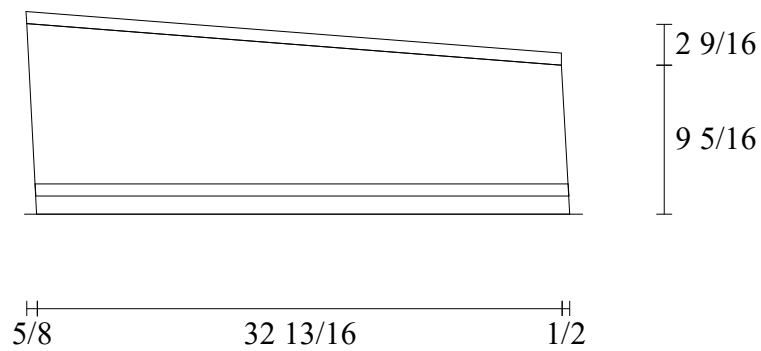

StairDesigner
Step : 4

Landen

landen01v02
Scale : 1/12

Step : $35 \frac{3}{16} \times 12 \frac{5}{8}$

Riser

Width : $33 \frac{5}{8}$ Height : $7 \frac{9}{16}$ Thickness : $\frac{3}{4}$ Angle : 7.45

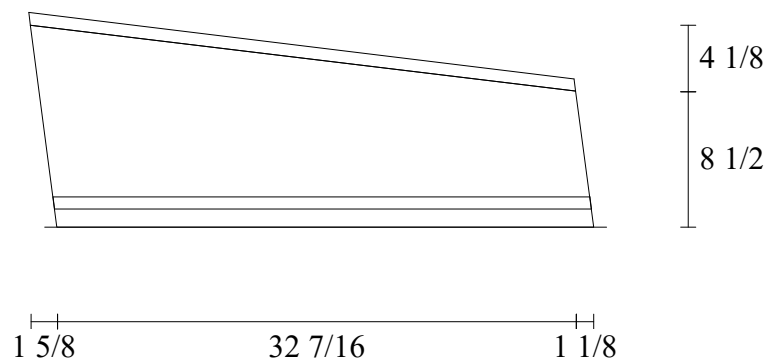

StairDesigner
Step : 5

Landen

landen01v02
Scale : 1/12

Step : $37 \frac{13}{16} \times 13 \frac{11}{16}$

Riser

Width : $34 \frac{1}{2}$ Height : $7 \frac{9}{16}$ Thickness : $\frac{3}{4}$ Angle : 14.37

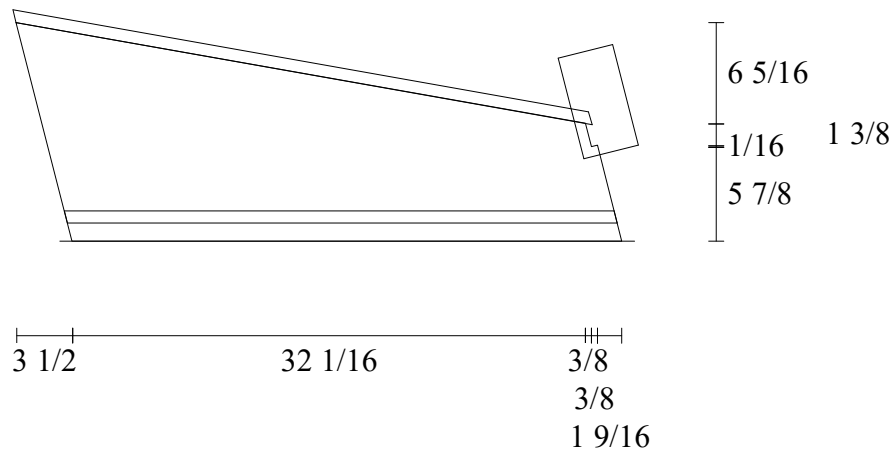

StairDesigner
Step : 6

Landen

landen01v02
Scale : 1/12

Step : $45 \frac{1}{16} \times 19 \frac{11}{16}$

Riser

Width : $36 \frac{7}{8}$ Height : $7 \frac{9}{16}$ Thickness : $\frac{3}{4}$ Angle : 24.45

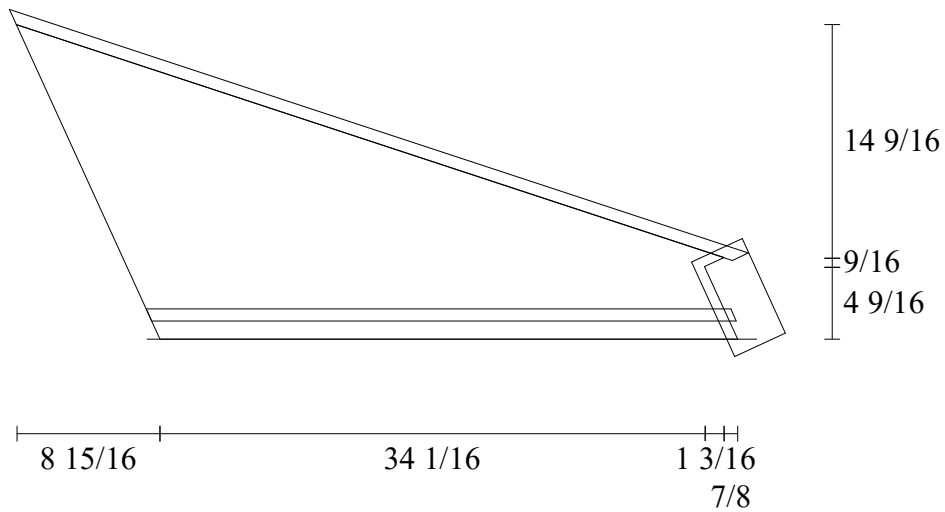

StairDesigner
Step : 7

Landen

landen01v02
Scale : 1/12

Step : $50 \frac{13}{16} \times 16 \frac{1}{2}$

Riser

Width : $48 \frac{5}{8}$ Height : $7 \frac{9}{16}$ Thickness : $\frac{3}{4}$ Angle R:-47.29 ; L:42.71

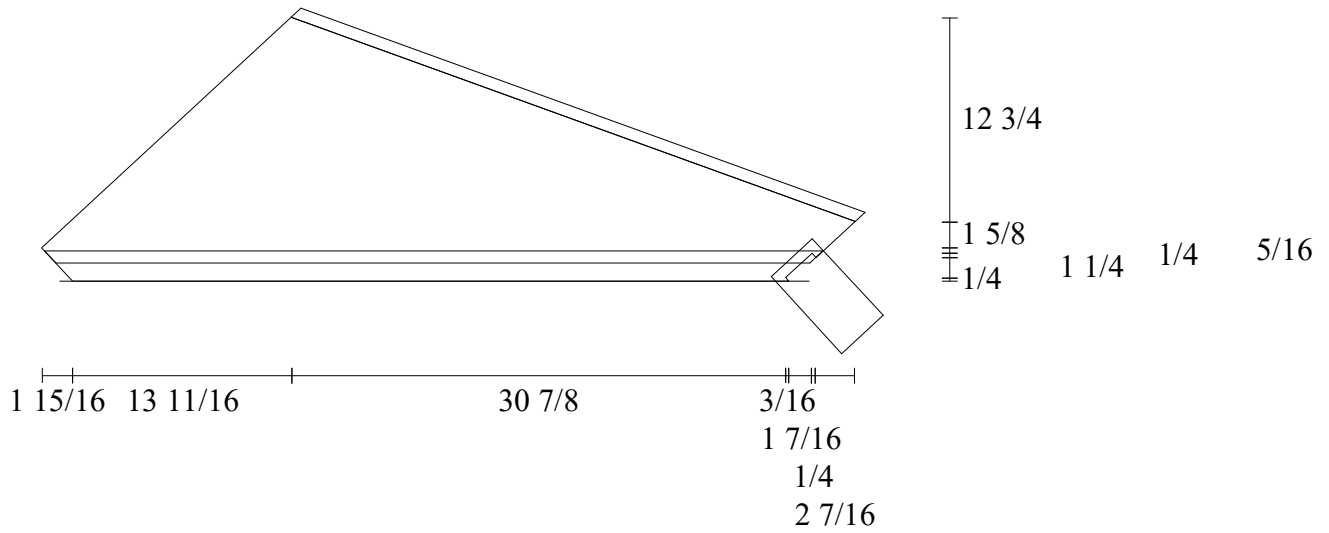

StairDesigner
Step : 8

Landen

landen01v02
Scale : 1/12

Step : 40 $7/8$ x 12 $13/16$

Riser

Width : 37 $13/16$ Height : 7 $9/16$ Thickness : $3/4$ Angle : -27.40

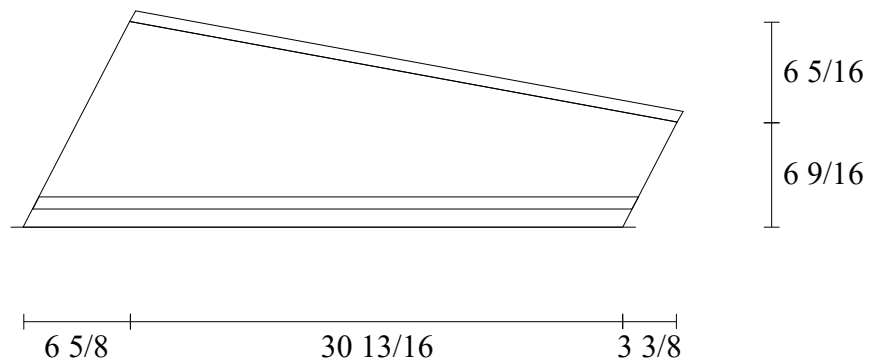

StairDesigner
Step : 9

Landen

landen01v02
Scale : 1/12

Step : $37 \frac{1}{4} \times 12 \frac{1}{4}$

Riser

Width : 35 Height : $7 \frac{9}{16}$ Thickness : $\frac{3}{4}$ Angle : -16.99

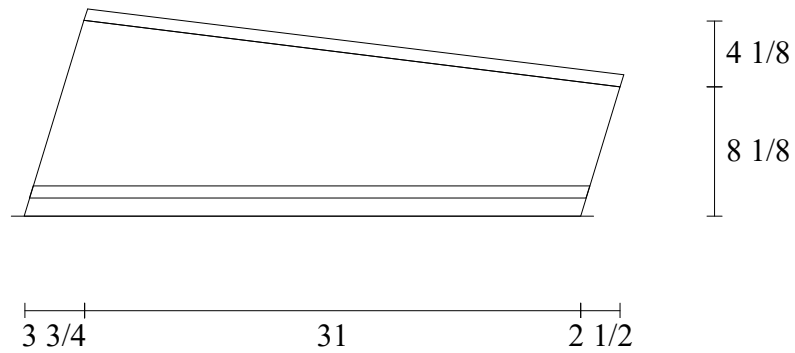

StairDesigner
Step : 10

Landen

landen01v02
Scale : 1/12

Step : $35 \frac{3}{8} \times 11 \frac{7}{8}$

Riser

Width : $33 \frac{7}{8}$ Height : $7 \frac{9}{16}$ Thickness : $\frac{3}{4}$ Angle : -9.96

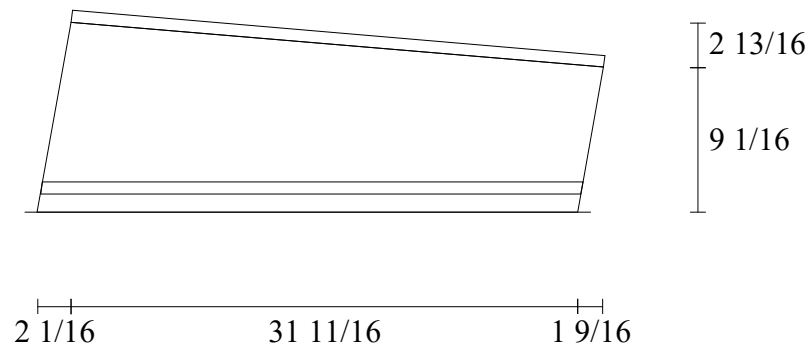

StairDesigner
Step : 11

Landen

landen01v02
Scale : 1/12

Step : $34 \frac{1}{4} \times 11 \frac{7}{16}$

Riser

Width : $33 \frac{7}{16}$ Height : $7 \frac{9}{16}$ Thickness : $\frac{3}{4}$ Angle : -5.15

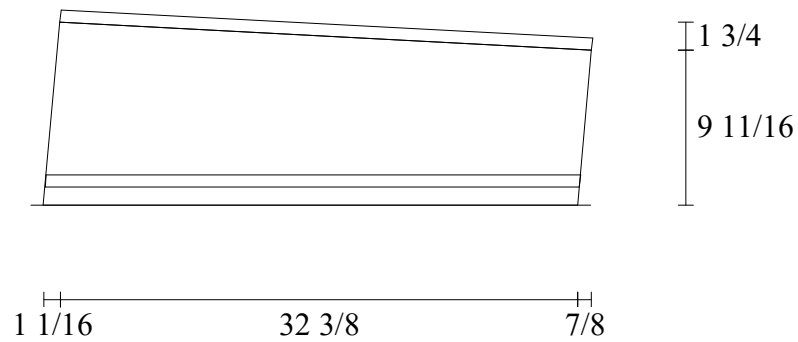

StairDesigner
Step : 12

Landen

landen01v02
Scale : 1/12

Step : $33 \frac{5}{8} \times 11 \frac{1}{16}$

Riser

Width : $33 \frac{5}{16}$ Height : $7 \frac{9}{16}$ Thickness : $\frac{3}{4}$ Angle : -2.12

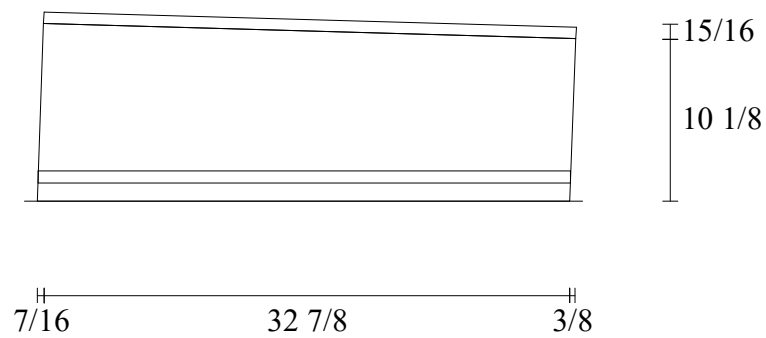

StairDesigner
Step : 13

Landen

landen01v02
Scale : 1/12

Step : $33 \frac{5}{16} \times 9 \frac{5}{8}$

Riser

Width : $33 \frac{1}{4}$ Height : $7 \frac{9}{16}$ Thickness : $\frac{3}{4}$ Angle : -0.49

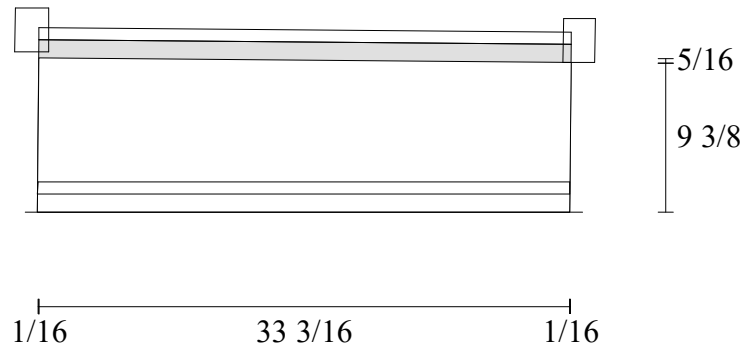

StairDesigner
Step : 14

Landen

landen01v02
Scale : 1/12

Landing Step

Riser

Width : $33 \frac{1}{4}$ Height : $7 \frac{9}{16}$ Thickness : $\frac{3}{4}$ Angle : 0.00

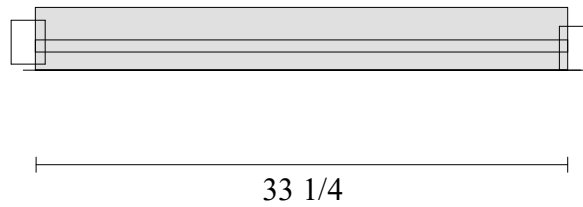

StairDesigner
Left Stringboard

Landen

landen01v02
Scale : 1/28

Dimensions : 192 15/16 x 18 5/8 (27.9°)

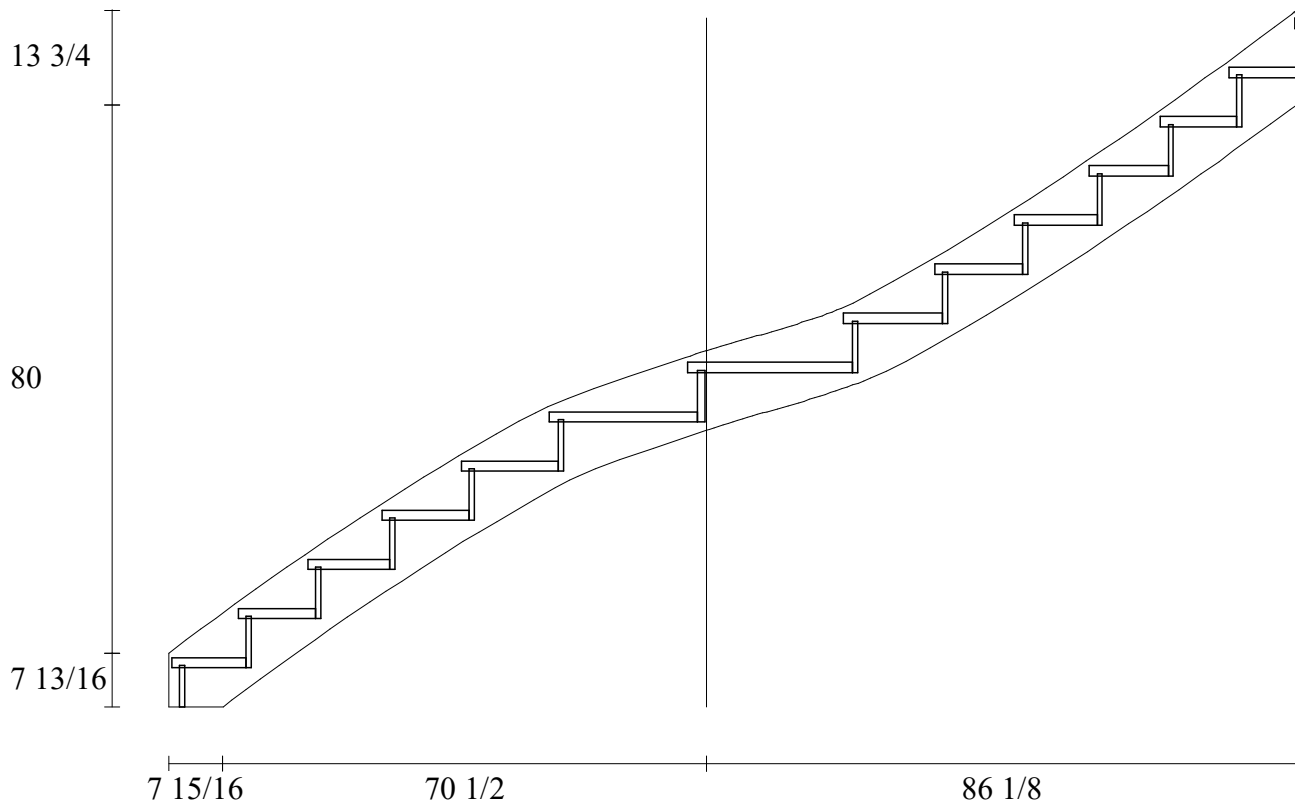

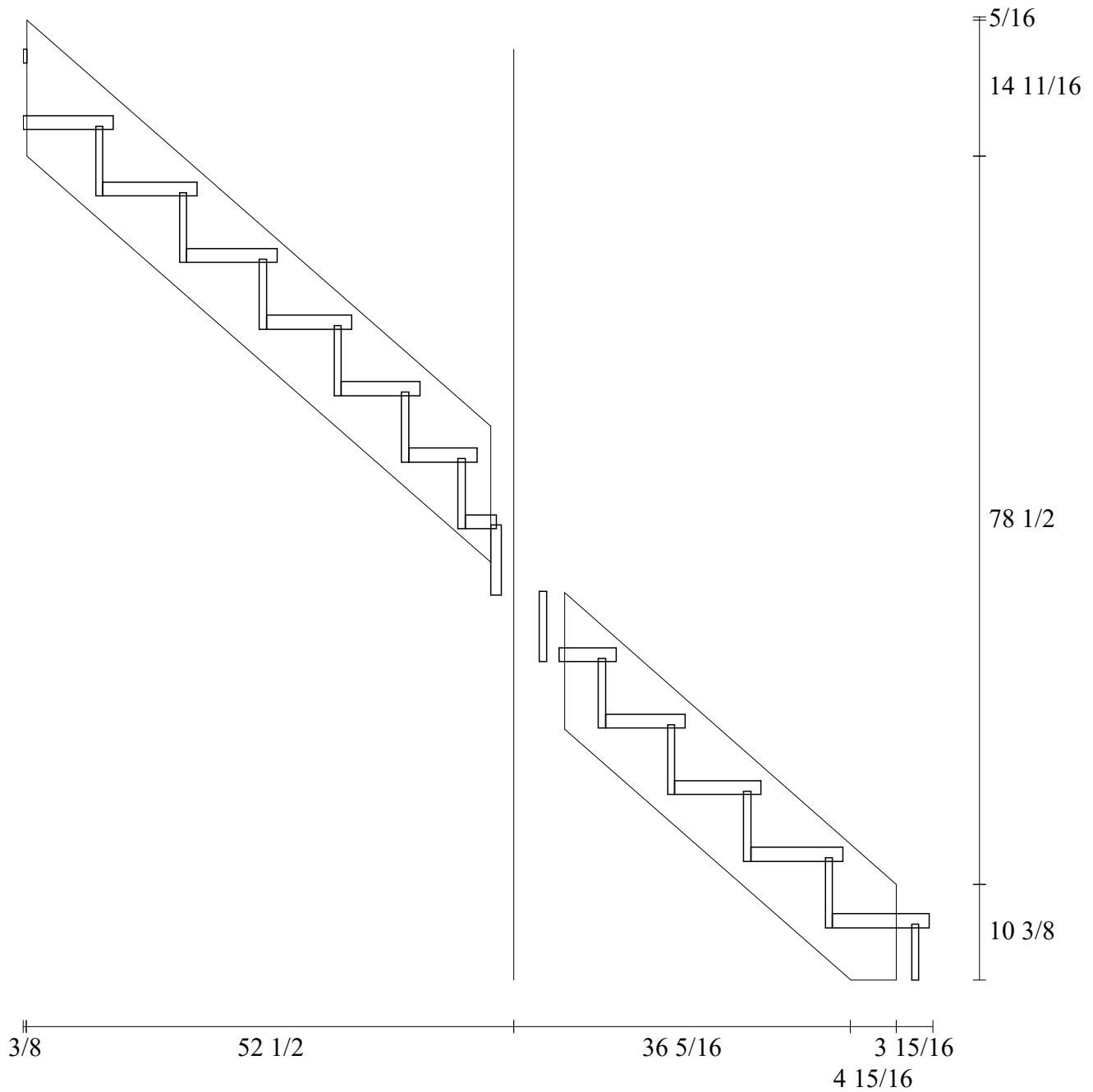
Dimensions : $142 \frac{13}{16}$ x $17 \frac{3}{8}$ (47.3°)

StairDesigner
Newel Post : 1

Landen

landen01v02
Scale : 1/19

Extremity Newel Post Right Stringboard Flight : 1

Top View

Height : $46 \frac{1}{4}$

Step 1 Height : $7 \frac{3}{16}$



Front 2 : Stringboard : 0.00 / 41.31 Handrail : 43.27

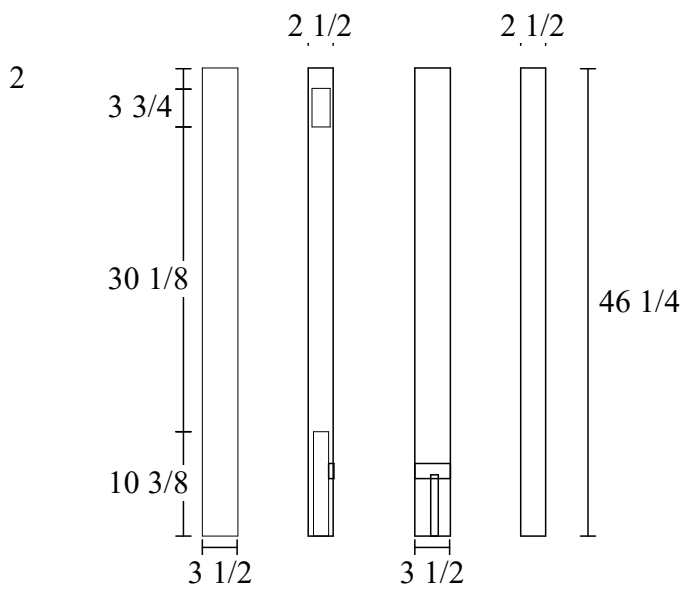

StairDesigner
Newel Post : 2

Landen

landen01v02
Scale : 1/19

Corner Newel Post Right Stringboard Flight : 1-2

Top View

Height : 100

Angle : 90.00

Step 5 Height : $35 \frac{7}{8}$



Step 6 Height : 43

Step 7 Height : $50 \frac{3}{16}$

Front 1 : Stringboard : 41.19 Handrail : 41.16

Front 4 : Stringboard : 41.31 Handrail : 43.27

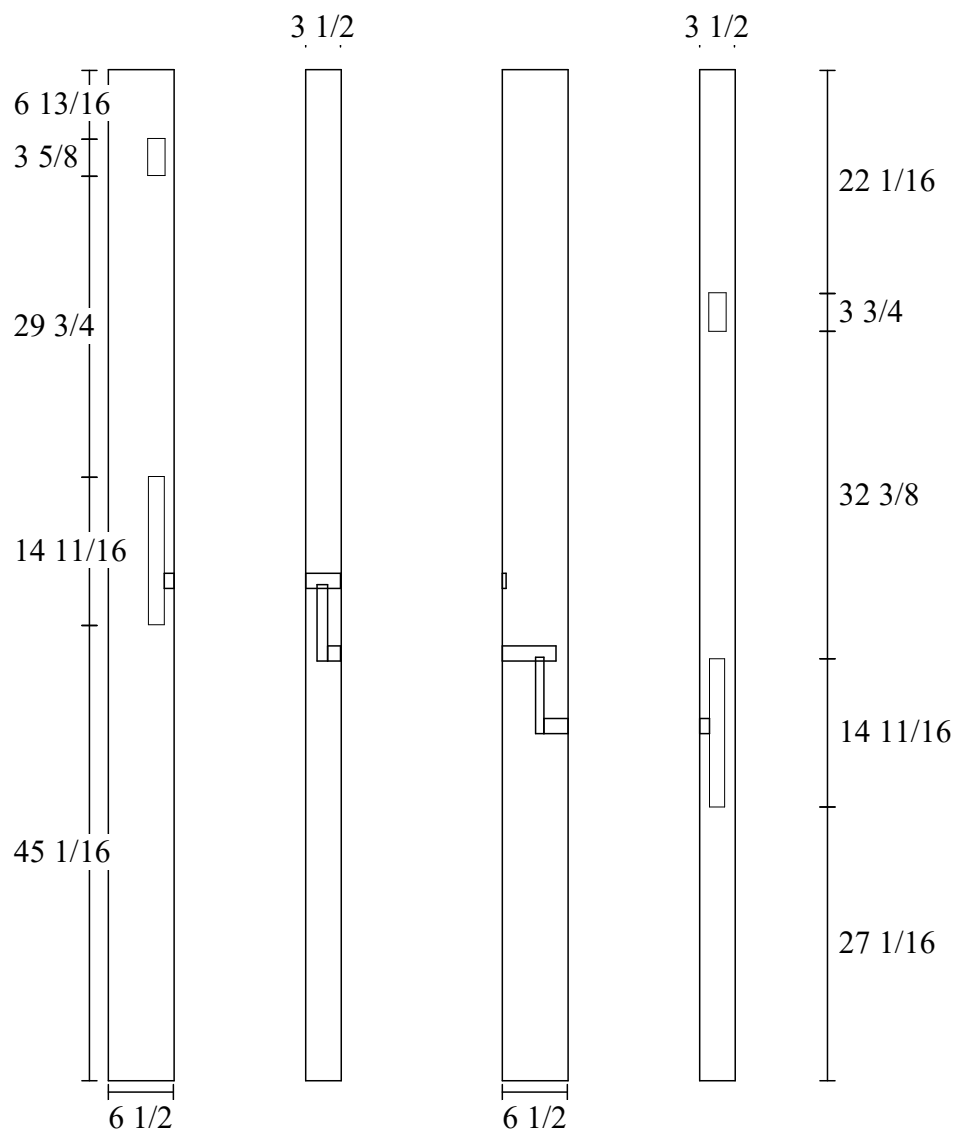

StairDesigner
Newel Post : 3

Landen

landen01v02
Scale : 1/19

Extremity Newel Post Right Stringboard Flight : 2

Top View

Height : 52 1/16

Step 13 Height : 6 3/8

Step 14 Height : 13 1/2



Front 1 : Stringboard : 41.19 Handrail : 41.16

Front 4 : Stringboard : 41.19 Handrail : 41.16

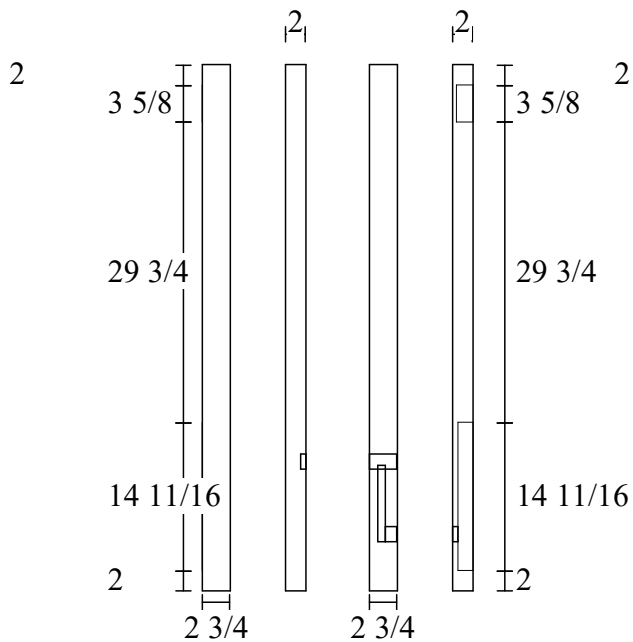

StairDesigner
Newel Post : 4

Landen

landen01v02
Scale : 1/19

Extremity Newel Post Left Stringboard Flight : 2

Top View

Height : $55 \frac{1}{8}$

Step 13 Height : $7 \frac{5}{16}$

Step 14 Height : $14 \frac{1}{2}$

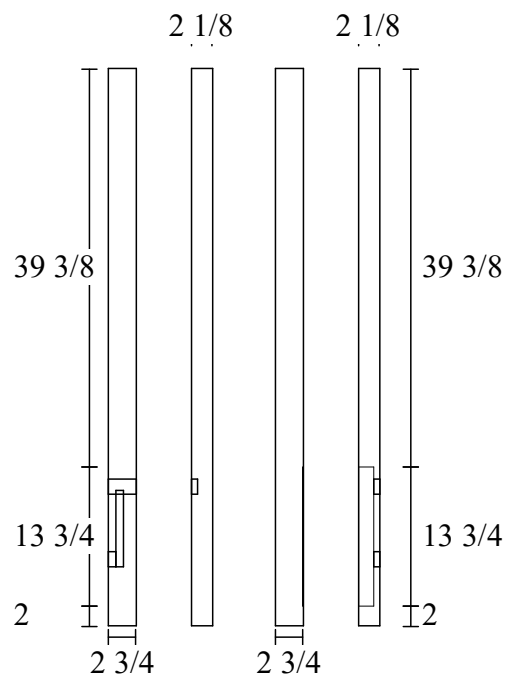

Dimensions : 139 1/4 x 8 15/16 (46.5°)

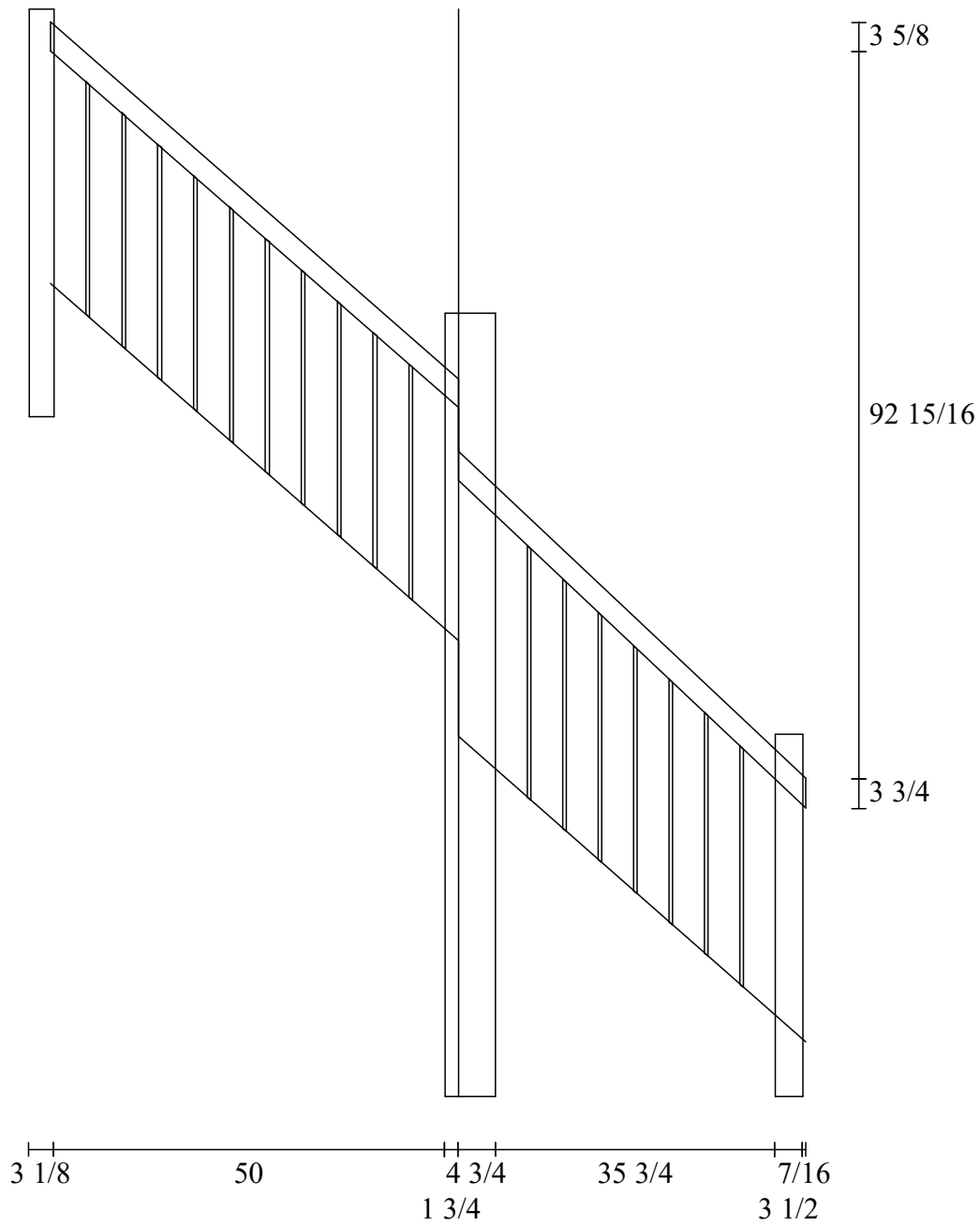

StairDesigner
Banister : 1-3

Landen

landen01v02

Banister : 1

Flight : 1

Position : 8 3/16

Height from Ground Level : 13 15/16

Angle : 43.27 / 41.31

Height : 32 7/16

Shaft Diameter : 1/2

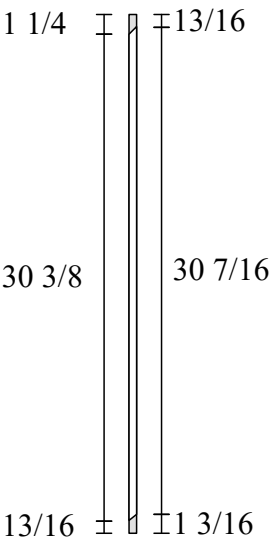

Banister : 2

Flight : 1

Position : 12 3/4

Height from Ground Level : 17 7/8

Angle : 43.27 / 41.31

Height : 32 11/16

Shaft Diameter : 1/2

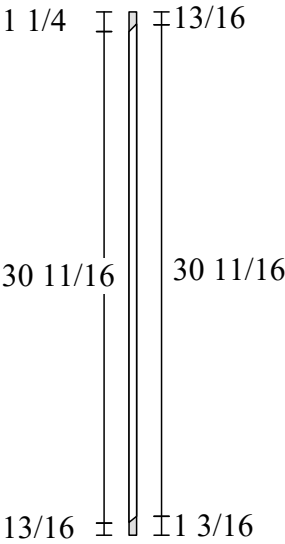

Banister : 3

Flight : 1

Position : 17 1/4

Height from Ground Level : 21 7/8

Angle : 43.27 / 41.31

Height : 33

Shaft Diameter : 1/2

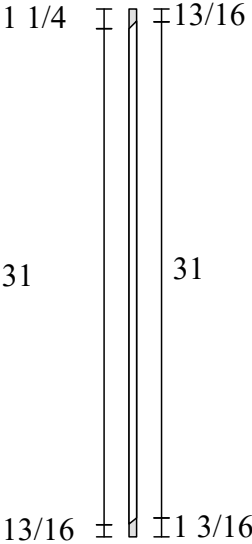

StairDesigner Banister : 4-6	Landen	landen01v02
---------------------------------	--------	-------------

Banister : 4

Flight : 1

Position : 21 13/16

Height from Ground Level : 25 7/8

Angle : 43.27 / 41.31

Height : 33 1/4

Shaft Diameter : 1/2

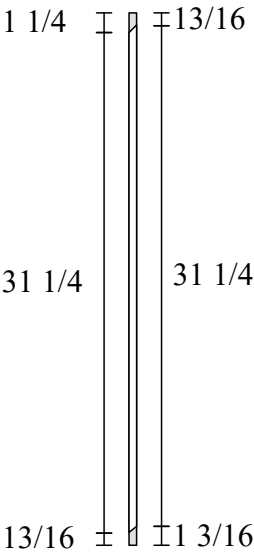

Banister : 5

Flight : 1

Position : 26 5/16

Height from Ground Level : 29 13/16

Angle : 43.27 / 41.31

Height : 33 9/16

Shaft Diameter : 1/2

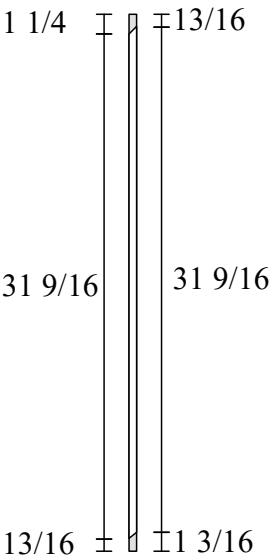

Banister : 6

Flight : 1

Position : 30 13/16

Height from Ground Level : 33 13/16

Angle : 43.27 / 41.31

Height : 33 13/16

Shaft Diameter : 1/2

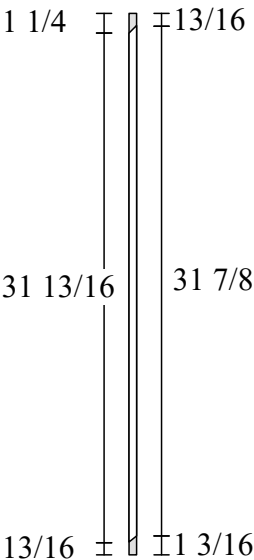

StairDesigner
Banister : 7-9

Landen

landen01v02

Banister : 7

Flight : 1

Position : 35 3/8

Height from Ground Level : 37 13/16

Angle : 43.27 / 41.31

Height : 34 1/8

Shaft Diameter : 1/2

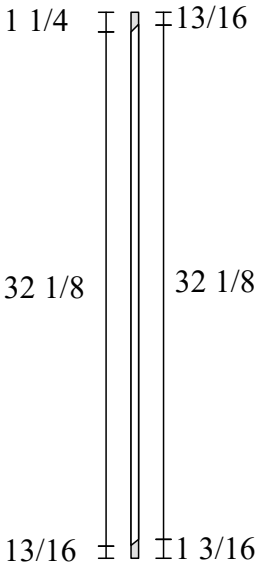

Banister : 8

Flight : 2

Position : 6 1/8

Height from Ground Level : 63 3/8

Angle : 41.16 / 41.19

Height : 31 3/4

Shaft Diameter : 1/2

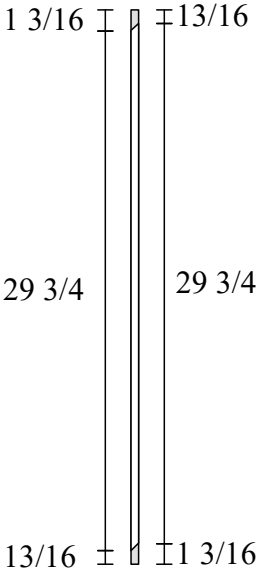

Banister : 9

Flight : 2

Position : 10 11/16

Height from Ground Level : 67 3/8

Angle : 41.16 / 41.19

Height : 31 3/4

Shaft Diameter : 1/2

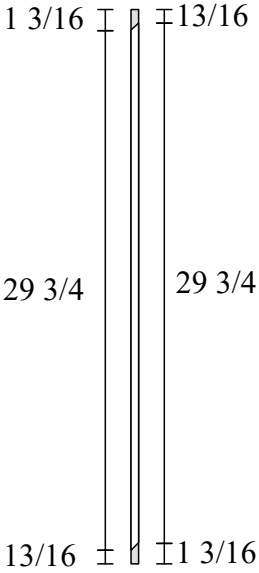

StairDesigner
Banister : 10-12

Landen

landen01v02

Banister : 10
Flight : 2
Position : 15 1/4
Height from Ground Level : 71 3/8
Angle : 41.16 / 41.19
Height : 31 3/4
Shaft Diameter : 1/2

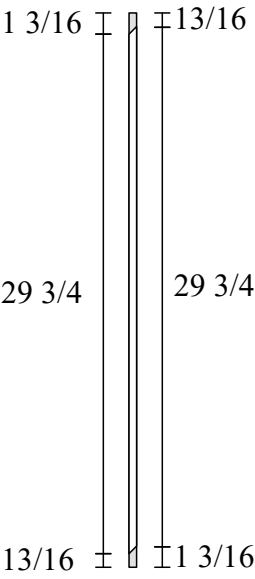

Banister : 11
Flight : 2
Position : 19 7/8
Height from Ground Level : 75 3/8
Angle : 41.16 / 41.19
Height : 31 3/4
Shaft Diameter : 1/2

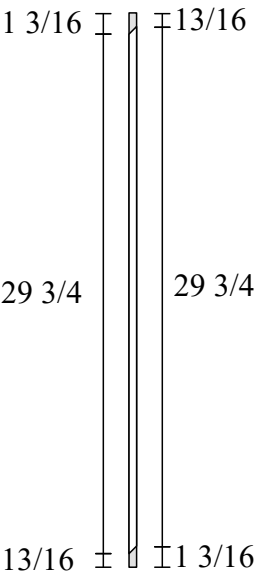

Banister : 12
Flight : 2
Position : 24 7/16
Height from Ground Level : 79 7/16
Angle : 41.16 / 41.19
Height : 31 3/4
Shaft Diameter : 1/2

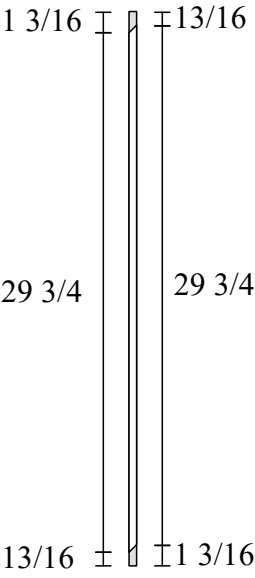

StairDesigner
Banister : 13-15

Landen

landen01v02

Banister : 13
Flight : 2
Position : 29 1/16
Height from Ground Level : 83 7/16
Angle : 41.16 / 41.19
Height : 31 3/4
Shaft Diameter : 1/2

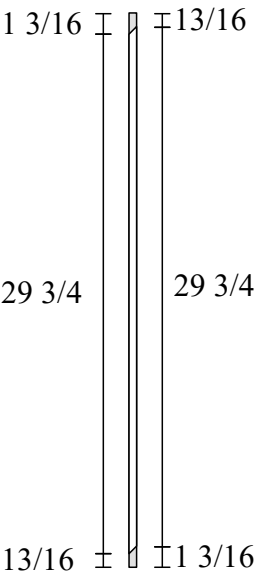

Banister : 14
Flight : 2
Position : 33 5/8
Height from Ground Level : 87 7/16
Angle : 41.16 / 41.19
Height : 31 3/4
Shaft Diameter : 1/2

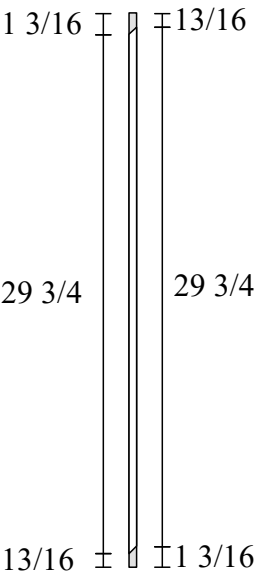

Banister : 15
Flight : 2
Position : 38 1/4
Height from Ground Level : 91 7/16
Angle : 41.16 / 41.19
Height : 31 3/4
Shaft Diameter : 1/2

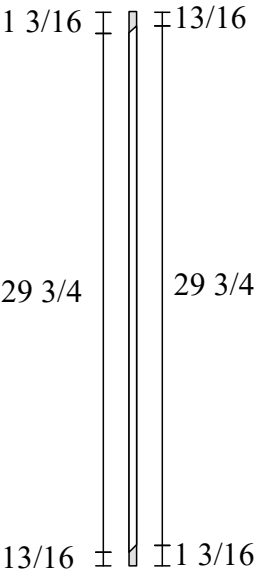

StairDesigner
Banister : 16-17

Landen

landen01v02

Banister : 16
Flight : 2
Position : 42 13/16
Height from Ground Level : 95 1/2
Angle : 41.16 / 41.19
Height : 31 11/16
Shaft Diameter : 1/2

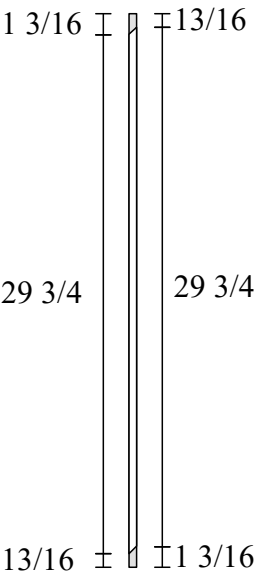

Banister : 17
Flight : 2
Position : 47 3/8
Height from Ground Level : 99 1/2
Angle : 41.16 / 41.19
Height : 31 11/16
Shaft Diameter : 1/2

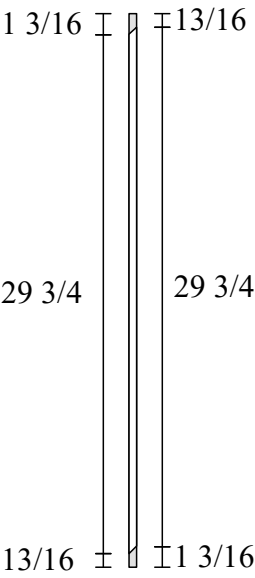

Piece	Dimensions	Cutting List Volume	Real Volume
Step 1	33 1/4 x 10 13/16 x 1 1/2	8.84 dm ³	8.68 dm ³
Step 2	33 3/8 x 11 5/16 x 1 1/2	9.27 dm ³	8.68 dm ³
Step 3	33 15/16 x 11 7/8 x 1 1/2	9.92 dm ³	8.68 dm ³
Step 4	35 3/16 x 12 5/8 x 1 1/2	10.92 dm ³	8.71 dm ³
Step 5	37 13/16 x 13 11/16 x 1 1/2	12.71 dm ³	8.82 dm ³
Step 6	45 1/16 x 19 11/16 x 1 1/2	21.78 dm ³	11.25 dm ³
Step 7	50 13/16 x 16 1/2 x 1 1/2	20.57 dm ³	12.04 dm ³
Step 8	40 7/8 x 12 13/16 x 1 1/2	12.89 dm ³	8.92 dm ³
Step 9	37 1/4 x 12 1/4 x 1 1/2	11.20 dm ³	8.69 dm ³
Step 10	35 3/8 x 11 7/8 x 1 1/2	10.30 dm ³	8.68 dm ³
Step 11	34 1/4 x 11 7/16 x 1 1/2	9.64 dm ³	8.68 dm ³
Step 12	33 5/8 x 11 1/16 x 1 1/2	9.16 dm ³	8.68 dm ³
Step 13	33 5/16 x 9 5/8 x 1 1/2	7.89 dm ³	7.76 dm ³
Riser 1	33 1/4 x 6 1/16 x 3/4	2.47 dm ³	2.47 dm ³
Riser 2	33 1/4 x 7 9/16 x 3/4	3.08 dm ³	3.08 dm ³
Riser 3	33 5/16 x 7 9/16 x 3/4	3.09 dm ³	3.09 dm ³
Riser 4	33 5/8 x 7 9/16 x 3/4	3.12 dm ³	3.11 dm ³
Riser 5	34 1/2 x 7 9/16 x 3/4	3.20 dm ³	3.18 dm ³
Riser 6	36 7/8 x 7 9/16 x 3/4	3.42 dm ³	3.39 dm ³
Riser 7	48 5/8 x 7 9/16 x 3/4	4.51 dm ³	4.44 dm ³
Riser 8	37 13/16 x 7 9/16 x 3/4	3.51 dm ³	3.47 dm ³
Riser 9	35 x 7 9/16 x 3/4	3.25 dm ³	3.22 dm ³
Riser 10	33 7/8 x 7 9/16 x 3/4	3.14 dm ³	3.13 dm ³
Riser 11	33 7/16 x 7 9/16 x 3/4	3.10 dm ³	3.10 dm ³
Riser 12	33 5/16 x 7 9/16 x 3/4	3.09 dm ³	3.09 dm ³
Riser 13	33 1/4 x 7 9/16 x 3/4	3.08 dm ³	3.08 dm ³
Riser 14	33 1/4 x 7 9/16 x 3/4	3.08 dm ³	3.08 dm ³
Right Stringboard 1	54 7/16 x 11 1/16 x 1 1/2	14.76 dm ³	12.64 dm ³
Right Stringboard 2	76 1/8 x 11 1/16 x 1 1/2	20.63 dm ³	18.02 dm ³
Left Stringboard 1	95 1/16 x 15 1/4 x 1 1/2	35.60 dm ³	24.33 dm ³
Left Stringboard 2	106 7/16 x 16 7/16 x 1 1/2	43.00 dm ³	27.23 dm ³
Right Handrail 1	51 11/16 x 2 3/4 x 1 3/4	4.11 dm ³	3.91 dm ³
Right Handrail 2	68 13/16 x 2 3/4 x 1 3/4	5.48 dm ³	5.28 dm ³
Newel Post 1	3 1/2 x 2 1/2 x 46 1/4	6.63 dm ³	6.63 dm ³
Newel Post 2	6 1/2 x 3 1/2 x 100	37.28 dm ³	37.28 dm ³
Newel Post 3	2 3/4 x 2 x 52 1/16	4.69 dm ³	4.69 dm ³
Newel Post 4	2 3/4 x 2 1/8 x 55 1/8	5.20 dm ³	5.20 dm ³
Banister 1	1/2 x 1/2 x 32 7/16	0.12 dm ³	0.09 dm ³
Banister 2	1/2 x 1/2 x 32 11/16	0.12 dm ³	0.09 dm ³
Banister 3	1/2 x 1/2 x 33	0.12 dm ³	0.09 dm ³
Banister 4	1/2 x 1/2 x 33 1/4	0.12 dm ³	0.10 dm ³
Banister 5	1/2 x 1/2 x 33 9/16	0.12 dm ³	0.10 dm ³
Banister 6	1/2 x 1/2 x 33 13/16	0.12 dm ³	0.10 dm ³
Banister 7	1/2 x 1/2 x 34 1/8	0.13 dm ³	0.10 dm ³
Banister 8	1/2 x 1/2 x 31 3/4	0.12 dm ³	0.09 dm ³
Banister 9	1/2 x 1/2 x 31 3/4	0.12 dm ³	0.09 dm ³
Banister 10	1/2 x 1/2 x 31 3/4	0.12 dm ³	0.09 dm ³
Banister 11	1/2 x 1/2 x 31 3/4	0.12 dm ³	0.09 dm ³
Banister 12	1/2 x 1/2 x 31 3/4	0.12 dm ³	0.09 dm ³
Banister 13	1/2 x 1/2 x 31 3/4	0.12 dm ³	0.09 dm ³
Banister 14	1/2 x 1/2 x 31 3/4	0.12 dm ³	0.09 dm ³

StairDesigner
Cutting List (2/2)

Landen

landen01v02

Piece	Dimensions	Cutting List Volume	Real Volume
Banister 15	1/2 x 1/2 x 31 3/4	0.12 dm ³	0.09 dm ³
Banister 16	1/2 x 1/2 x 31 11/16	0.12 dm ³	0.09 dm ³
Banister 17	1/2 x 1/2 x 31 11/16	0.12 dm ³	0.09 dm ³

Piece	Cutting List Volume	Real Volume	Weight	Cost
Steps	155.10 dm ³	118.26 dm ³	118.26 kg	93.06 £
Risers	45.14 dm ³	44.93 dm ³		
Stringboards	113.99 dm ³	82.22 dm ³	82.22 kg	68.39 £
Handrails	9.59 dm ³	9.19 dm ³	9.19 kg	5.75 £
Newel Posts	53.81 dm ³	53.81 dm ³	53.81 kg	32.28 £
Banisters	2.02 dm ³	1.58 dm ³		14.02 £
Total	379.65 dm ³	309.99 dm ³	263.47 kg	213.51 £