

StairDesigner

Landen

landen01v01

Scale : 1/18

Multi-Flight Stair

Risers : 14

Floor Height : 254.95 cm

Riser Height : 18.21 cm

Tread Width : 24.10 cm

Stair Rule : 60.52 cm

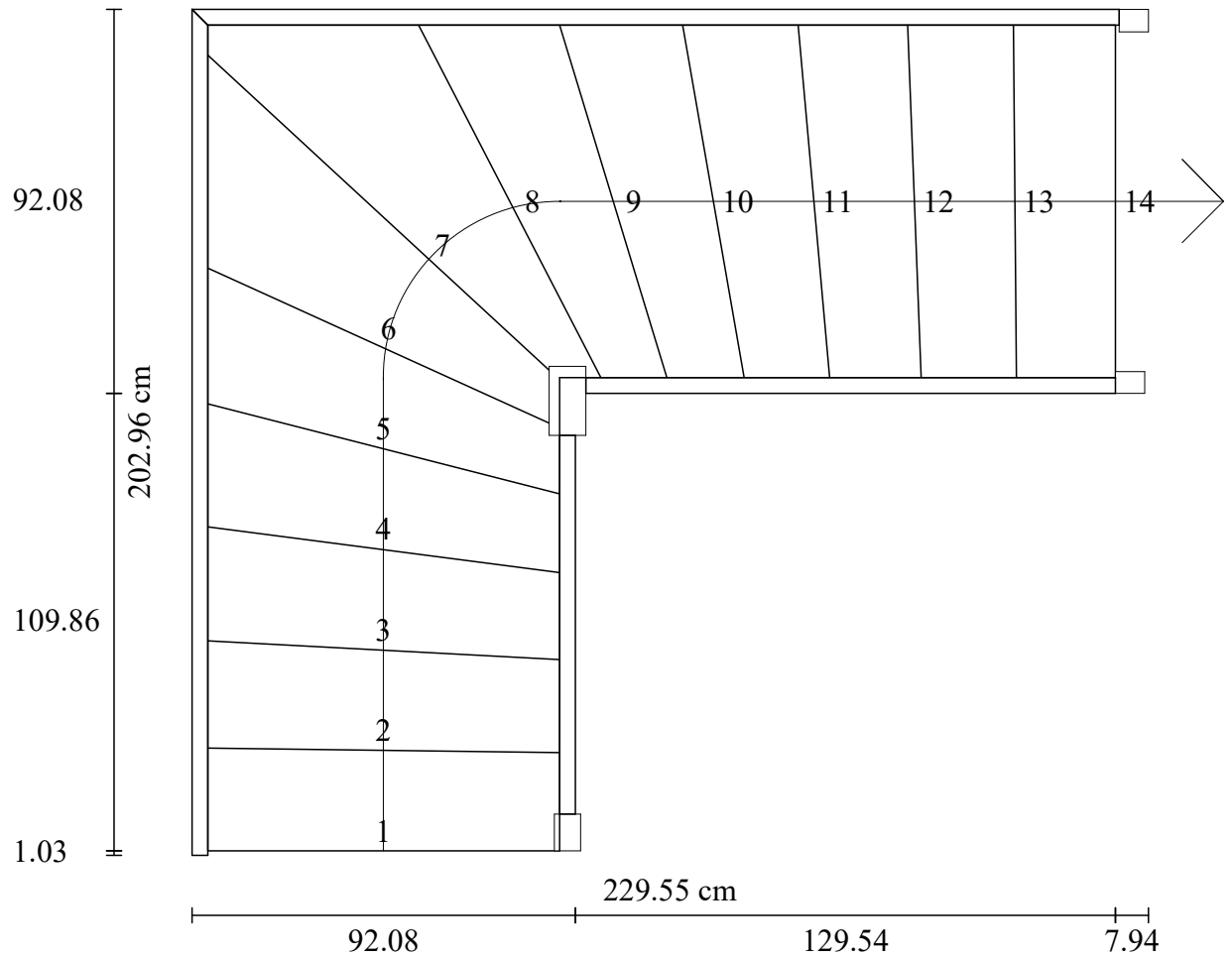

StairDesigner  
Step : 1

Landen

landen01v01  
Scale : 1/12

Step : 84.46 x 27.49

Riser

Width : 84.46 Height : 15.35 Thickness : 1.91 Angle : 0.00

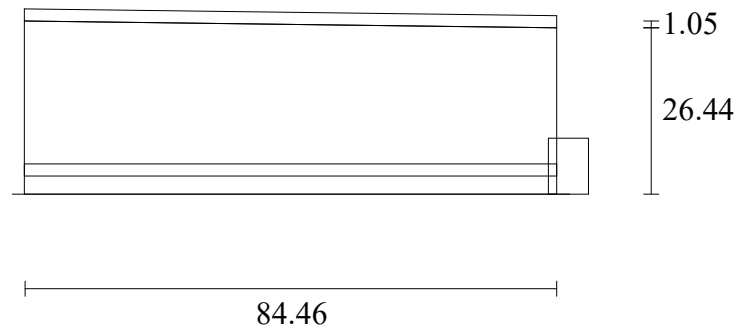

StairDesigner  
Step : 2

Landen

landen01v01  
Scale : 1/12

Step : 84.82 x 28.70

Riser

Width : 84.49 Height : 19.16 Thickness : 1.91 Angle : 0.71

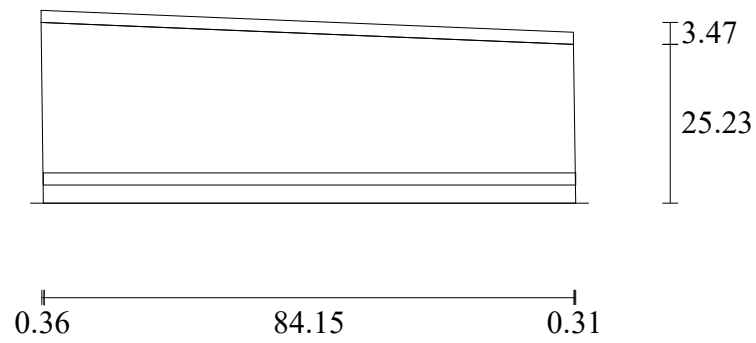

StairDesigner  
Step : 3

Landen

landen01v01  
Scale : 1/12

Step : 86.19 x 30.21

Riser

Width : 84.68 Height : 19.16 Thickness : 1.91 Angle : 3.06

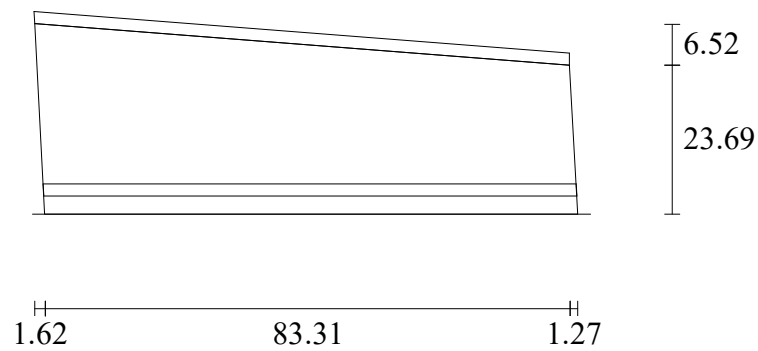

StairDesigner  
Step : 4

Landen

landen01v01  
Scale : 1/12

Step : 89.37 x 32.07

Riser

Width : 85.42 Height : 19.16 Thickness : 1.91 Angle : 7.45

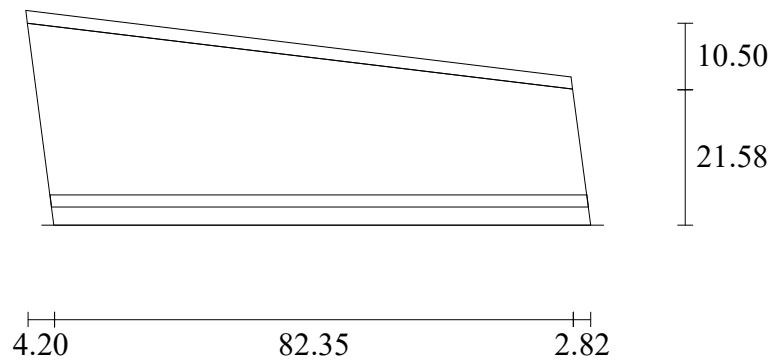

StairDesigner  
Step : 5

Landen

landen01v01  
Scale : 1/12

Step : 96.08 x 34.73

Riser

Width : 87.67 Height : 19.16 Thickness : 1.91 Angle : 14.37

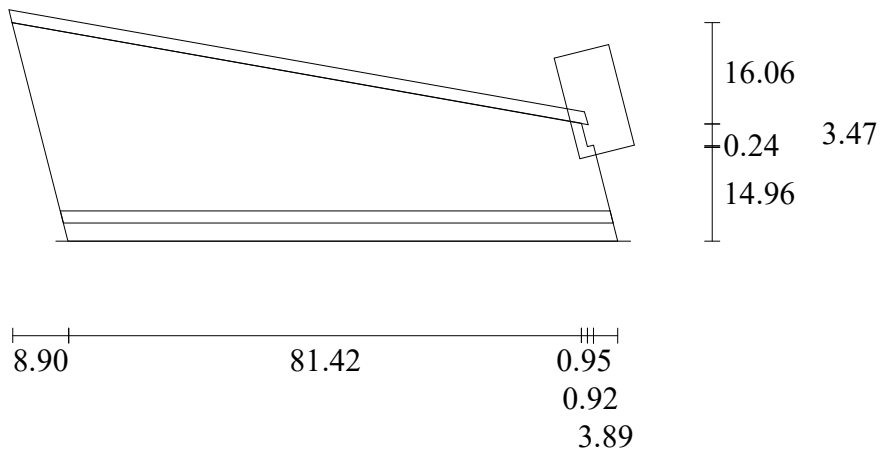

StairDesigner  
Step : 6

Landen

landen01v01  
Scale : 1/12

Step : 114.44 x 49.95

Riser

Width : 93.64 Height : 19.16 Thickness : 1.91 Angle : 24.45

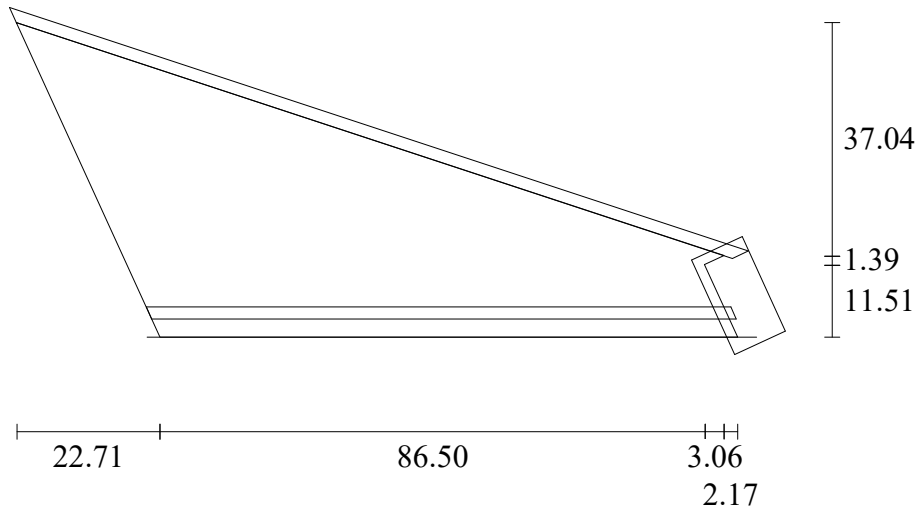

StairDesigner  
Step : 7

Landen

landen01v01  
Scale : 1/12

Step : 129.04 x 41.83

Riser

Width : 123.45 Height : 19.16 Thickness : 1.91 Angle R:-47.29 ; L:42.71

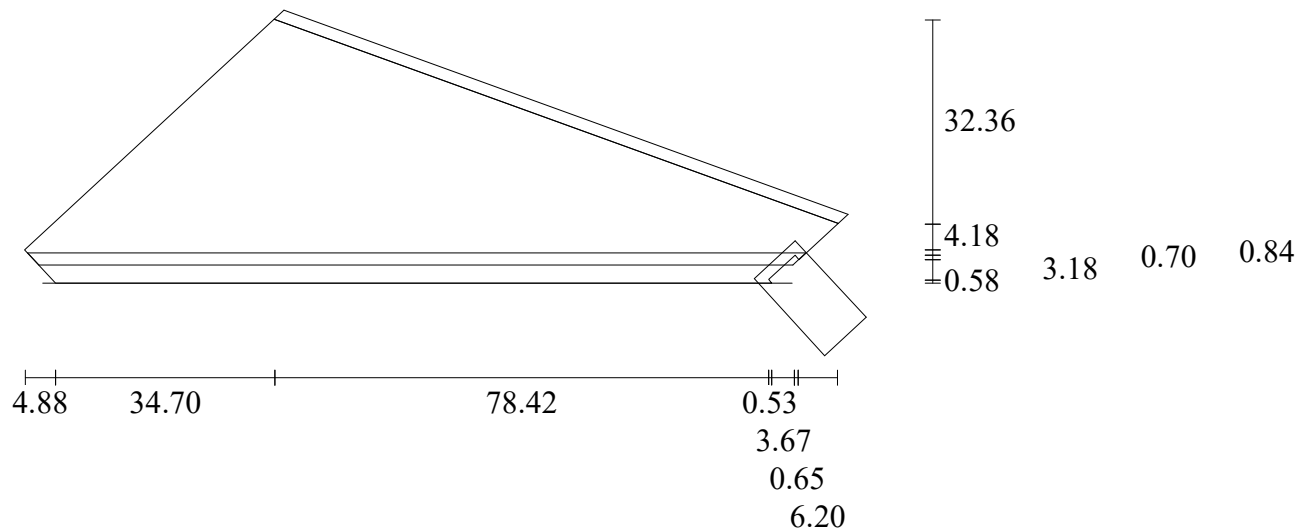

StairDesigner  
Step : 8

Landen

landen01v01  
Scale : 1/12

Step : 103.76 x 32.60

Riser

Width : 96.12 Height : 19.16 Thickness : 1.91 Angle : -27.40

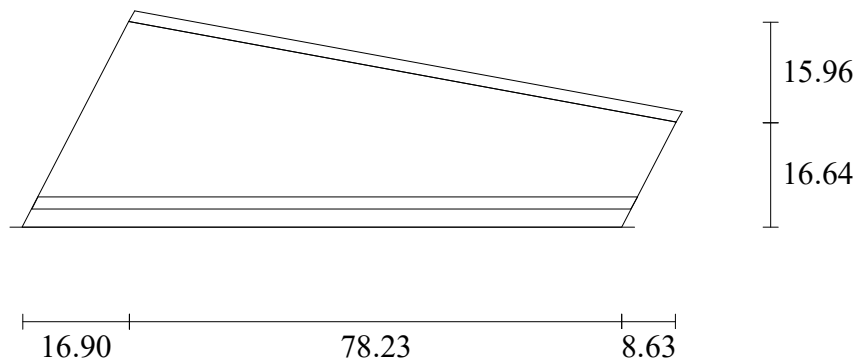

StairDesigner  
Step : 9

Landen

landen01v01  
Scale : 1/12

Step : 94.60 x 31.08

Riser

Width : 88.89 Height : 19.16 Thickness : 1.91 Angle : -16.99

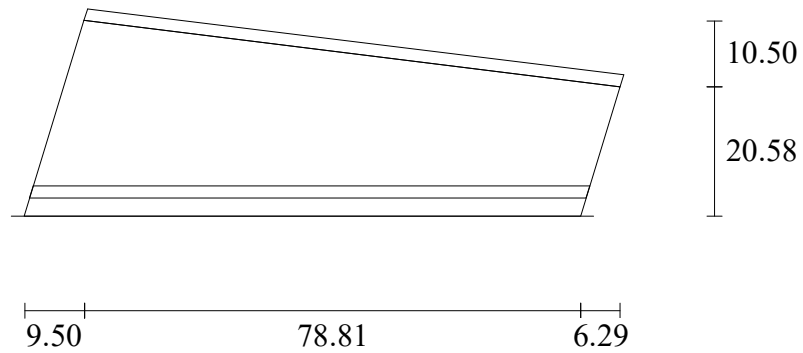

StairDesigner  
Step : 10

Landen

landen01v01  
Scale : 1/12

Step : 89.79 x 30.12

Riser

Width : 86.08 Height : 19.16 Thickness : 1.91 Angle : -9.96

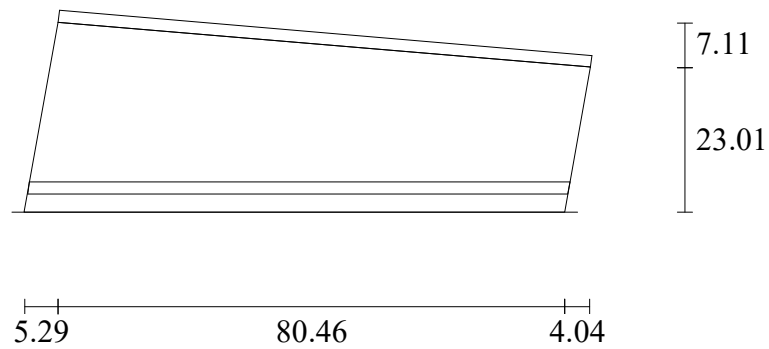

StairDesigner  
Step : 11

Landen

landen01v01  
Scale : 1/12

Step : 87.02 x 29.09

Riser

Width : 84.97 Height : 19.16 Thickness : 1.91 Angle : -5.15

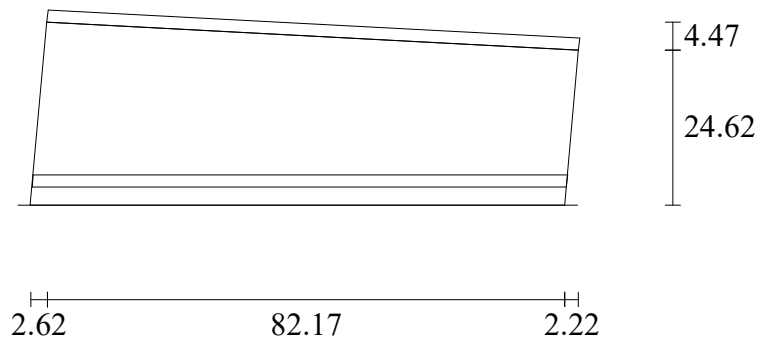

StairDesigner  
Step : 12

Landen

landen01v01  
Scale : 1/12

Step : 85.47 x 28.14

Riser

Width : 84.58 Height : 19.16 Thickness : 1.91 Angle : -2.12

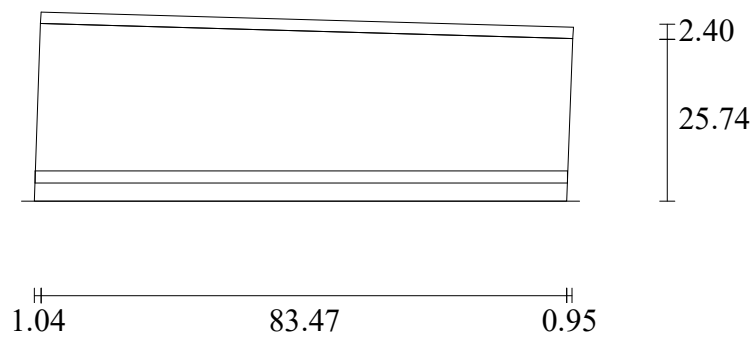

StairDesigner  
Step : 13

Landen

landen01v01  
Scale : 1/12

Step : 84.66 x 24.47

Riser

Width : 84.47 Height : 19.16 Thickness : 1.91 Angle : -0.49

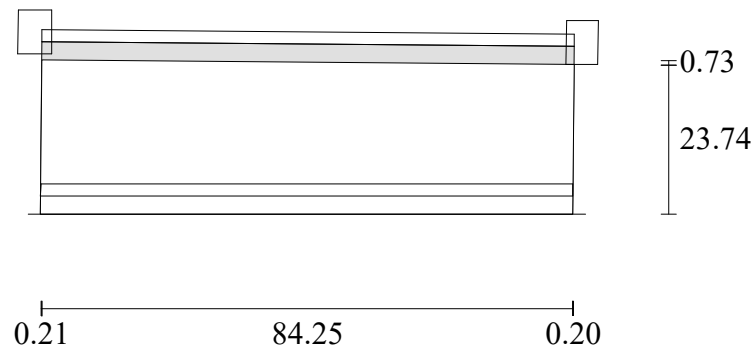

StairDesigner  
Step : 14

Landen

landen01v01  
Scale : 1/12

Landing Step

Riser

Width : 84.46 Height : 19.16 Thickness : 1.91 Angle : 0.00

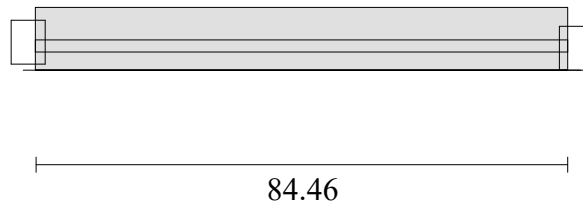

StairDesigner  
Left Stringboard

Landen

landen01v01  
Scale : 1/28

Dimensions : 490.08 x 47.28 (27.9°)

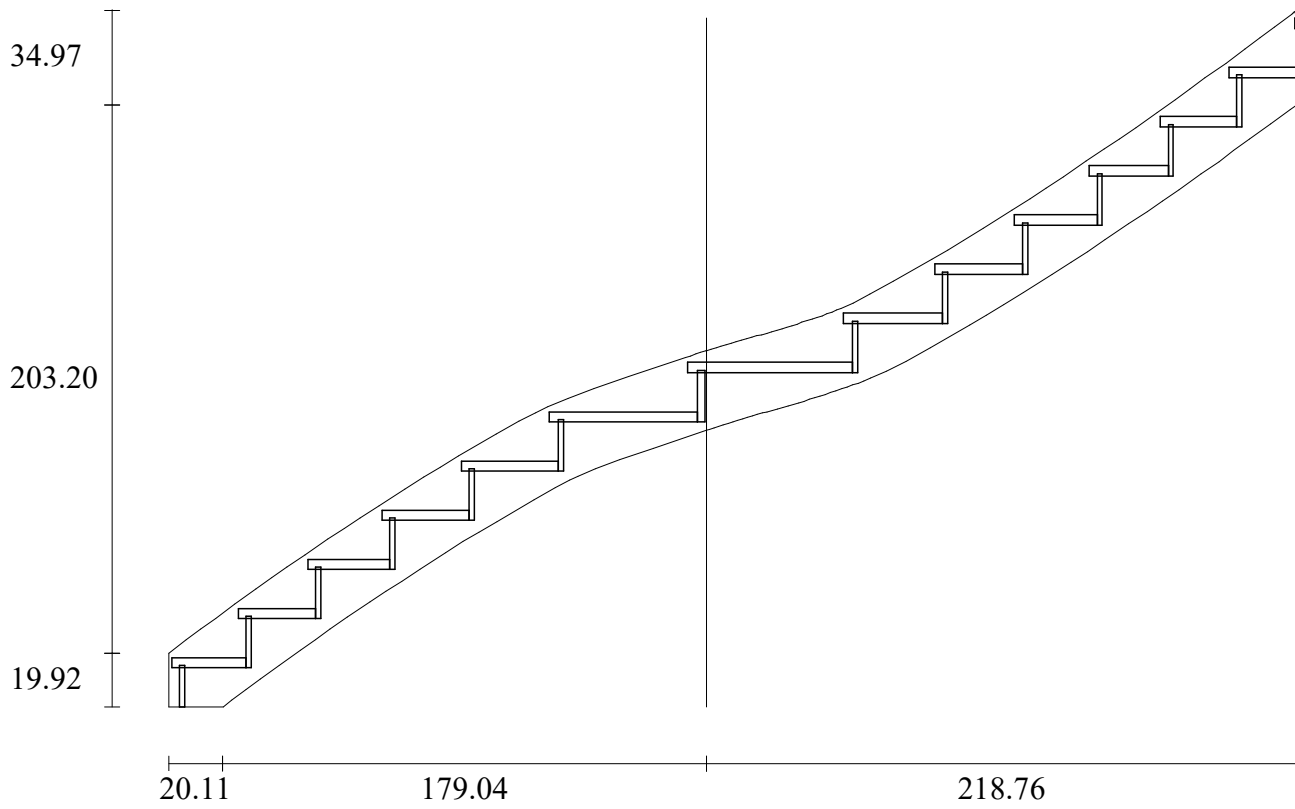

Dimensions : 362.69 x 44.19 (47.3°)

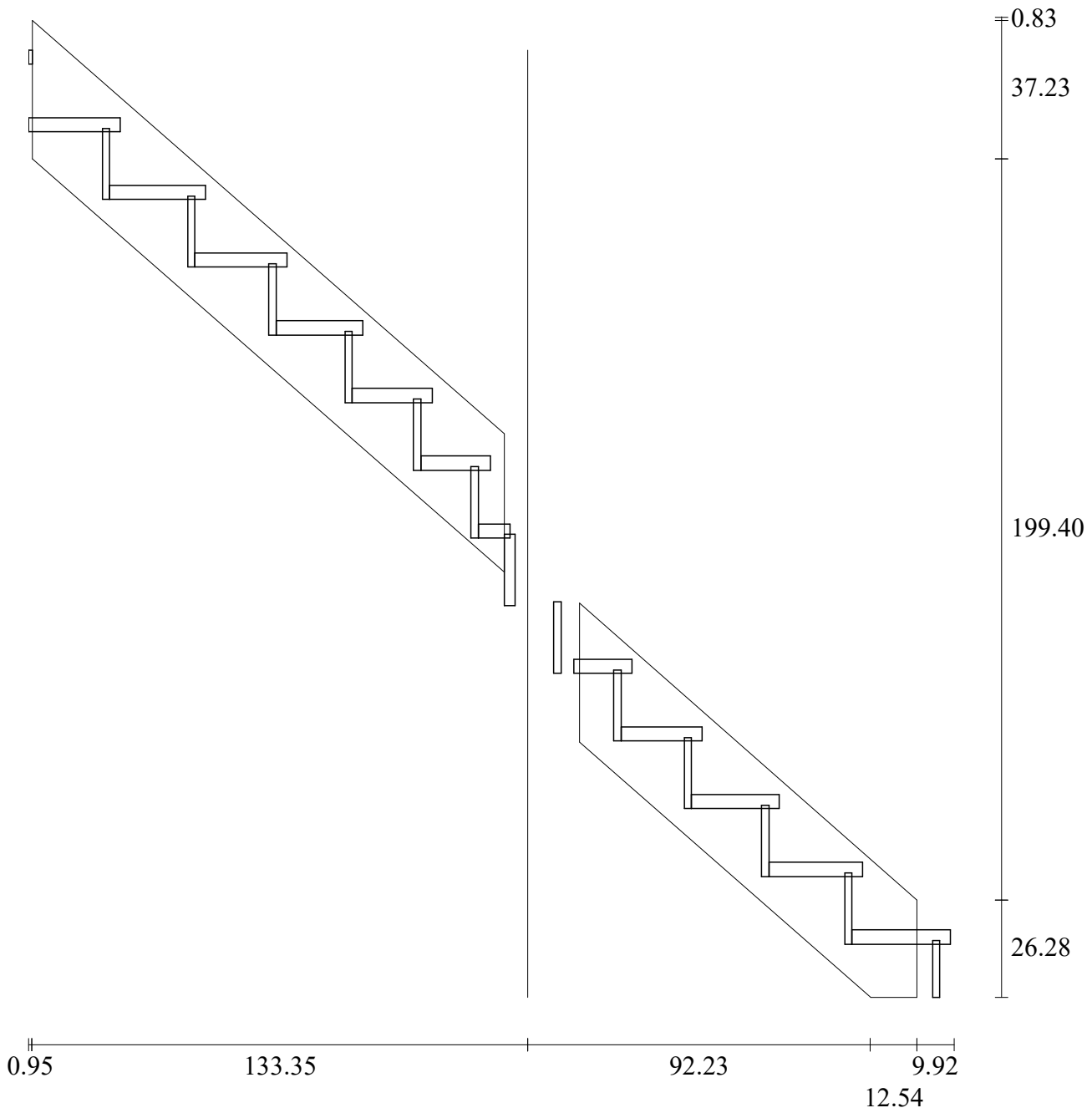

StairDesigner  
Newel Post : 1

Landen

landen01v01  
Scale : 1/19

Extremity Newel Post Right Stringboard Flight : 1

Top View

Height : 117.53

Step 1 Height : 18.21

Front 2 : Stringboard : 0.00 / 41.31 Handrail : 43.27

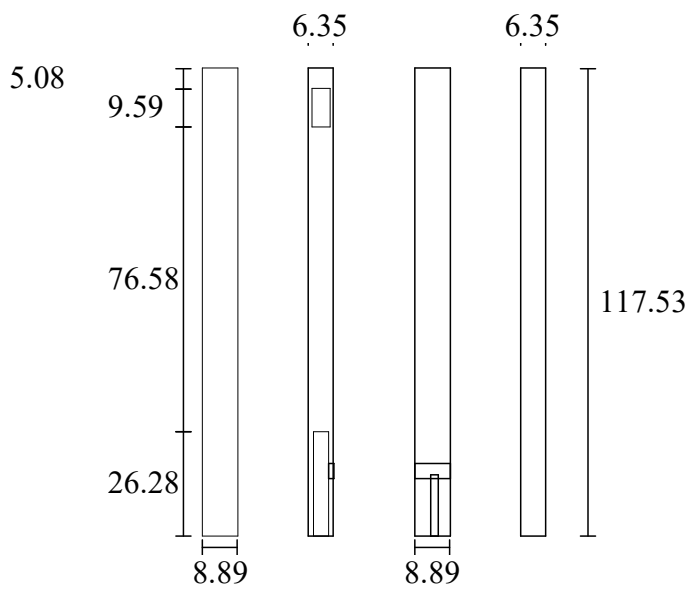

StairDesigner  
Newel Post : 2

Landen

landen01v01  
Scale : 1/19

Corner Newel Post Right Stringboard Flight : 1-2

Top View

Height : 254.00

Angle : 90.00

Step 5 Height : 91.05



Step 6 Height : 109.27

Step 7 Height : 127.48

Front 1 : Stringboard : 41.19 Handrail : 41.16

Front 4 : Stringboard : 41.31 Handrail : 43.27

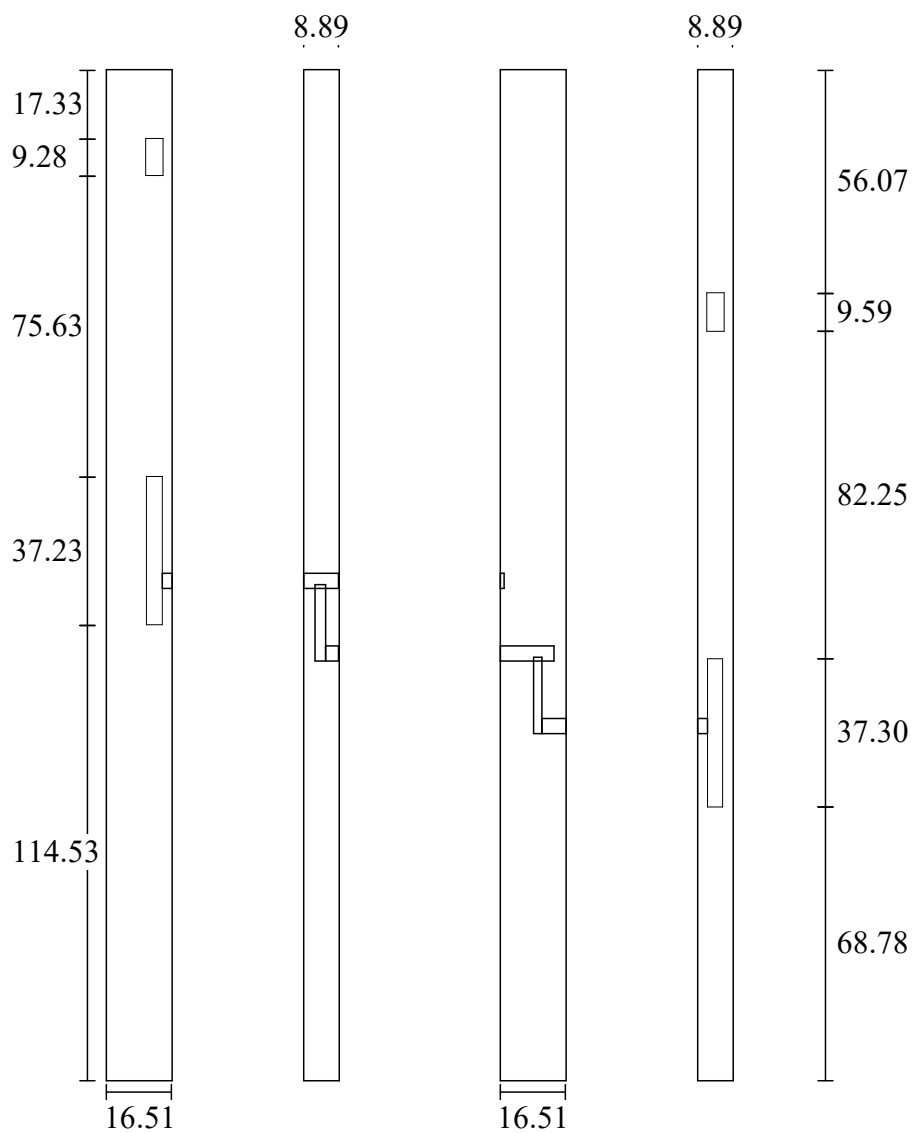

StairDesigner  
Newel Post : 3

Landen

landen01v01  
Scale : 1/19

Extremity Newel Post Right Stringboard Flight : 2

Top View

Height : 132.16

Step 13 Height : 16.15

Step 14 Height : 34.36



Front 1 : Stringboard : 41.19 Handrail : 41.16

Front 4 : Stringboard : 41.19 Handrail : 41.16

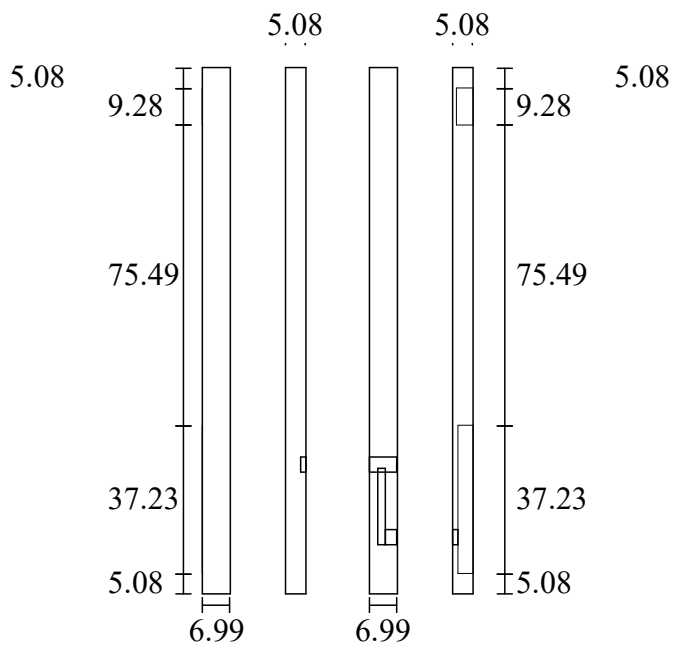

StairDesigner  
Newel Post : 4

Landen

landen01v01  
Scale : 1/19

Extremity Newel Post Left Stringboard Flight : 2

Top View

Height : 139.99

Step 13 Height : 18.62

Step 14 Height : 36.83

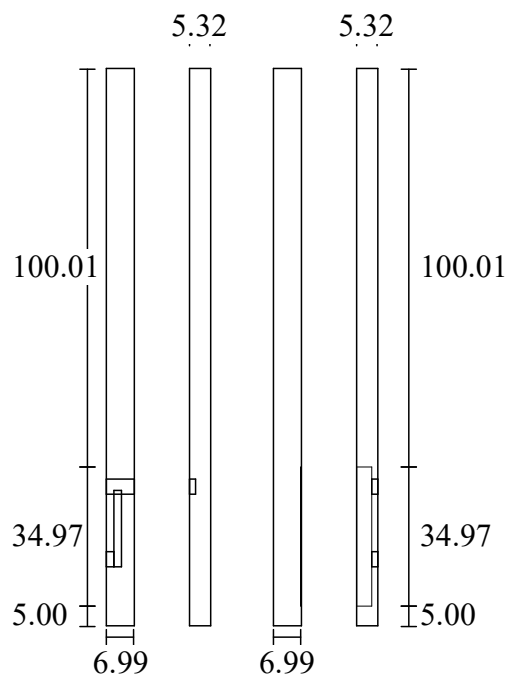

StairDesigner  
Right Handrail

Landen

landen01v01  
Scale : 1/23

Dimensions : 353.74 x 22.77 (46.5°)

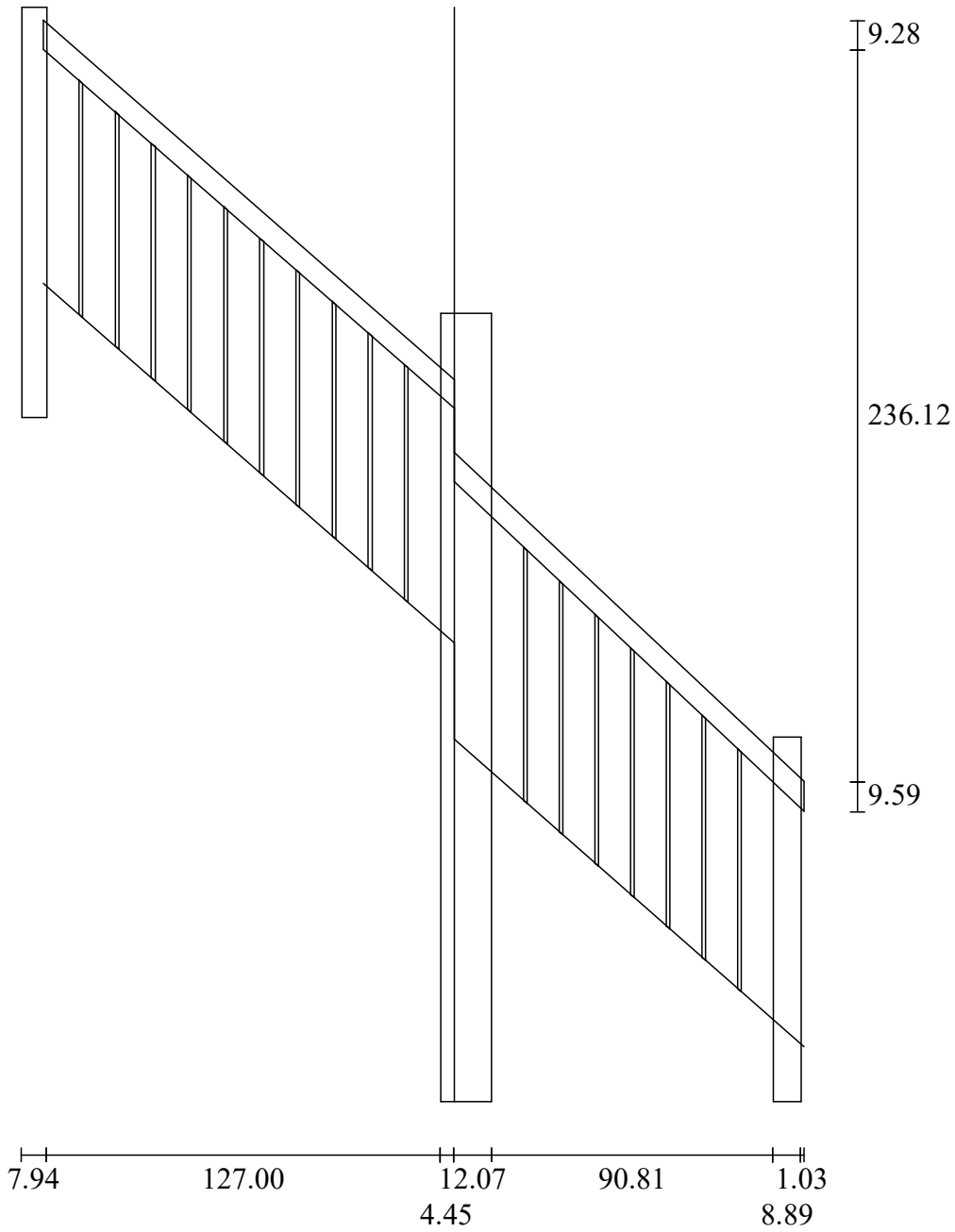

|                                 |        |             |
|---------------------------------|--------|-------------|
| StairDesigner<br>Banister : 1-3 | Landen | landen01v01 |
|---------------------------------|--------|-------------|

Banister : 1

Flight : 1

Position : 20.82

Height from Ground Level : 35.33

Angle : 43.27 / 41.31

Height : 82.35

Shaft Diameter : 1.20

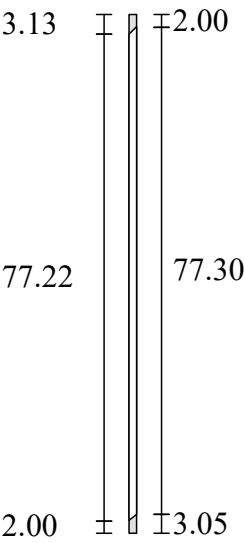

Banister : 2

Flight : 1

Position : 32.32

Height from Ground Level : 45.44

Angle : 43.27 / 41.31

Height : 83.07

Shaft Diameter : 1.20

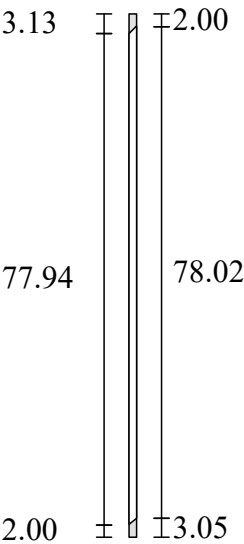

Banister : 3

Flight : 1

Position : 43.82

Height from Ground Level : 55.55

Angle : 43.27 / 41.31

Height : 83.79

Shaft Diameter : 1.20

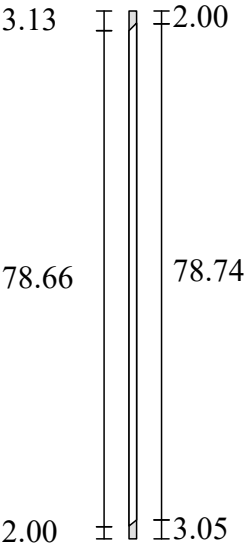

|                                 |        |             |
|---------------------------------|--------|-------------|
| StairDesigner<br>Banister : 4-6 | Landen | landen01v01 |
|---------------------------------|--------|-------------|

Banister : 4

Flight : 1

Position : 55.32

Height from Ground Level : 65.66

Angle : 43.27 / 41.31

Height : 84.51

Shaft Diameter : 1.20

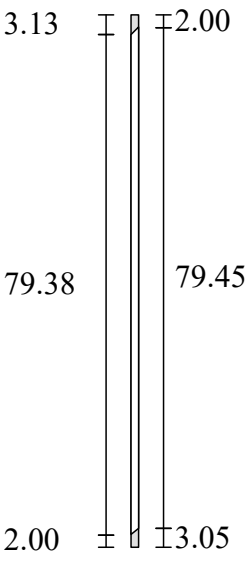

Banister : 5

Flight : 1

Position : 66.83

Height from Ground Level : 75.76

Angle : 43.27 / 41.31

Height : 85.23

Shaft Diameter : 1.20

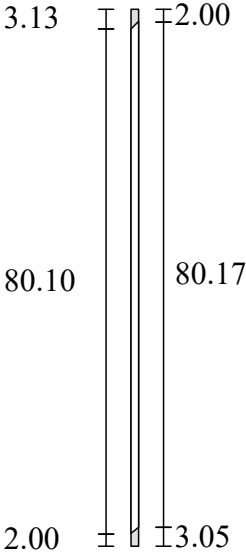

Banister : 6

Flight : 1

Position : 78.33

Height from Ground Level : 85.87

Angle : 43.27 / 41.31

Height : 85.95

Shaft Diameter : 1.20

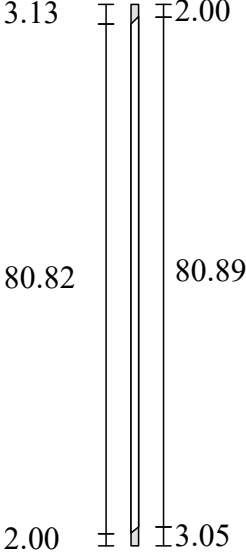

|                                 |        |             |
|---------------------------------|--------|-------------|
| StairDesigner<br>Banister : 7-9 | Landen | landen01v01 |
|---------------------------------|--------|-------------|

Banister : 7

Flight : 1

Position : 89.83

Height from Ground Level : 95.98

Angle : 43.27 / 41.31

Height : 86.66

Shaft Diameter : 1.20

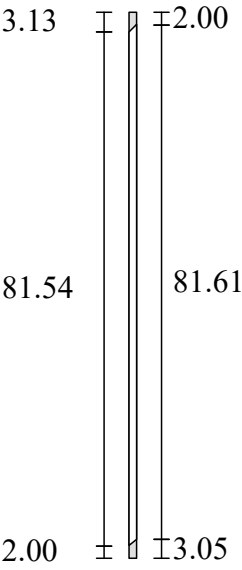

Banister : 8

Flight : 2

Position : 15.50

Height from Ground Level : 160.91

Angle : 41.16 / 41.19

Height : 80.67

Shaft Diameter : 1.20

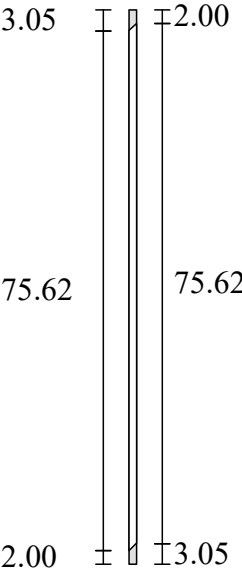

Banister : 9

Flight : 2

Position : 27.15

Height from Ground Level : 171.11

Angle : 41.16 / 41.19

Height : 80.65

Shaft Diameter : 1.20

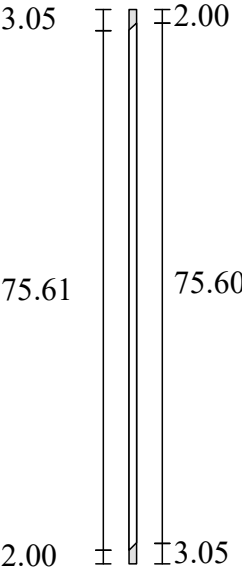

|                                   |        |             |
|-----------------------------------|--------|-------------|
| StairDesigner<br>Banister : 10-12 | Landen | landen01v01 |
|-----------------------------------|--------|-------------|

Banister : 10

Flight : 2

Position : 38.81

Height from Ground Level : 181.31

Angle : 41.16 / 41.19

Height : 80.64

Shaft Diameter : 1.20

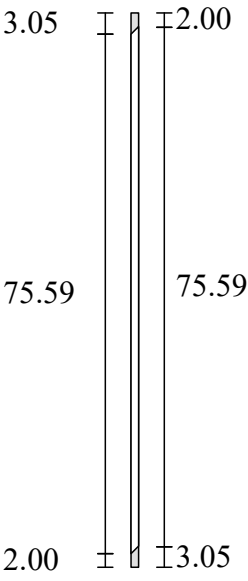

Banister : 11

Flight : 2

Position : 50.46

Height from Ground Level : 191.51

Angle : 41.16 / 41.19

Height : 80.63

Shaft Diameter : 1.20

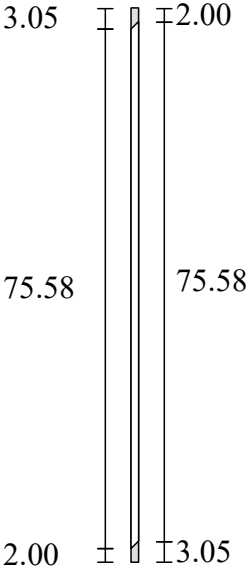

Banister : 12

Flight : 2

Position : 62.12

Height from Ground Level : 201.71

Angle : 41.16 / 41.19

Height : 80.62

Shaft Diameter : 1.20

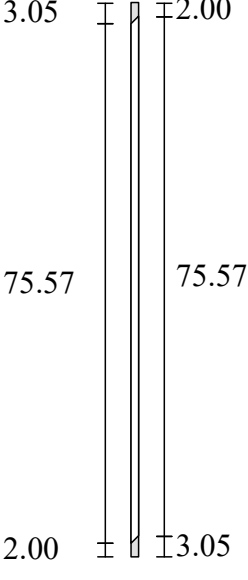

|                                   |        |             |
|-----------------------------------|--------|-------------|
| StairDesigner<br>Banister : 13-15 | Landen | landen01v01 |
|-----------------------------------|--------|-------------|

Banister : 13

Flight : 2

Position : 73.77

Height from Ground Level : 211.91

Angle : 41.16 / 41.19

Height : 80.60

Shaft Diameter : 1.20

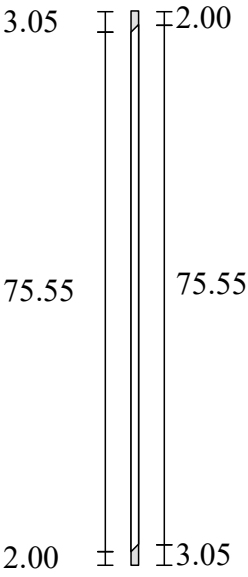

Banister : 14

Flight : 2

Position : 85.43

Height from Ground Level : 222.11

Angle : 41.16 / 41.19

Height : 80.59

Shaft Diameter : 1.20

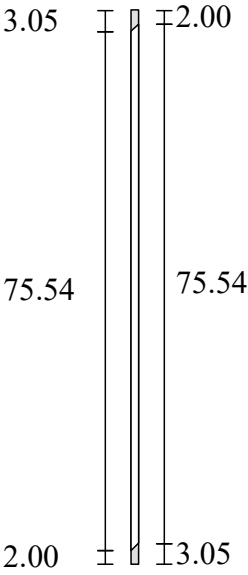

Banister : 15

Flight : 2

Position : 97.08

Height from Ground Level : 232.31

Angle : 41.16 / 41.19

Height : 80.58

Shaft Diameter : 1.20

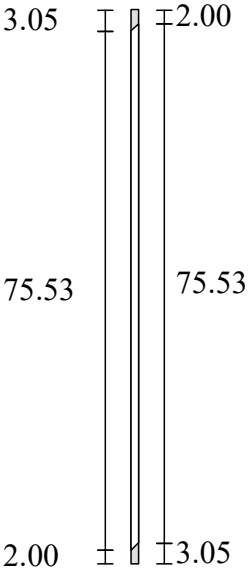

Shaft Diameter : 1.20

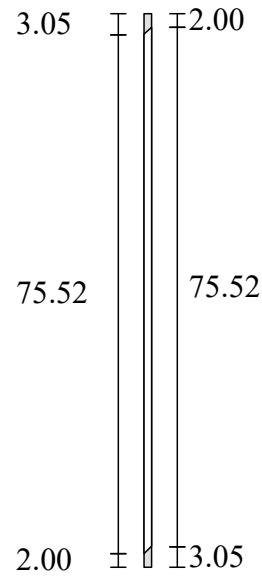

Shaft Diameter : 1.20

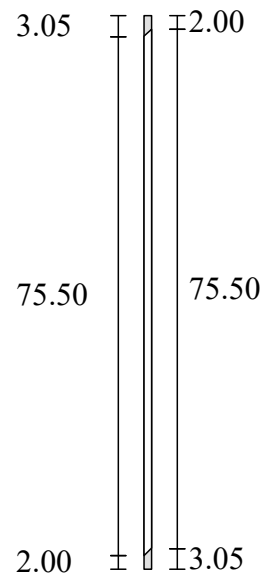

| Piece               | Dimensions            | Cutting List Volume   | Real Volume           |
|---------------------|-----------------------|-----------------------|-----------------------|
| Step 1              | 84.46 x 27.49 x 3.81  | 8.84 dm <sup>3</sup>  | 8.68 dm <sup>3</sup>  |
| Step 2              | 84.82 x 28.70 x 3.81  | 9.27 dm <sup>3</sup>  | 8.68 dm <sup>3</sup>  |
| Step 3              | 86.19 x 30.21 x 3.81  | 9.92 dm <sup>3</sup>  | 8.68 dm <sup>3</sup>  |
| Step 4              | 89.37 x 32.07 x 3.81  | 10.92 dm <sup>3</sup> | 8.71 dm <sup>3</sup>  |
| Step 5              | 96.08 x 34.73 x 3.81  | 12.71 dm <sup>3</sup> | 8.82 dm <sup>3</sup>  |
| Step 6              | 114.44 x 49.95 x 3.81 | 21.78 dm <sup>3</sup> | 11.25 dm <sup>3</sup> |
| Step 7              | 129.04 x 41.83 x 3.81 | 20.57 dm <sup>3</sup> | 12.04 dm <sup>3</sup> |
| Step 8              | 103.76 x 32.60 x 3.81 | 12.89 dm <sup>3</sup> | 8.92 dm <sup>3</sup>  |
| Step 9              | 94.60 x 31.08 x 3.81  | 11.20 dm <sup>3</sup> | 8.69 dm <sup>3</sup>  |
| Step 10             | 89.79 x 30.12 x 3.81  | 10.30 dm <sup>3</sup> | 8.68 dm <sup>3</sup>  |
| Step 11             | 87.02 x 29.09 x 3.81  | 9.64 dm <sup>3</sup>  | 8.68 dm <sup>3</sup>  |
| Step 12             | 85.47 x 28.14 x 3.81  | 9.16 dm <sup>3</sup>  | 8.68 dm <sup>3</sup>  |
| Step 13             | 84.66 x 24.47 x 3.81  | 7.89 dm <sup>3</sup>  | 7.76 dm <sup>3</sup>  |
| Riser 1             | 84.46 x 15.35 x 1.91  | 2.47 dm <sup>3</sup>  | 2.47 dm <sup>3</sup>  |
| Riser 2             | 84.49 x 19.16 x 1.91  | 3.08 dm <sup>3</sup>  | 3.08 dm <sup>3</sup>  |
| Riser 3             | 84.68 x 19.16 x 1.91  | 3.09 dm <sup>3</sup>  | 3.09 dm <sup>3</sup>  |
| Riser 4             | 85.42 x 19.16 x 1.91  | 3.12 dm <sup>3</sup>  | 3.11 dm <sup>3</sup>  |
| Riser 5             | 87.67 x 19.16 x 1.91  | 3.20 dm <sup>3</sup>  | 3.18 dm <sup>3</sup>  |
| Riser 6             | 93.64 x 19.16 x 1.91  | 3.42 dm <sup>3</sup>  | 3.39 dm <sup>3</sup>  |
| Riser 7             | 123.45 x 19.16 x 1.91 | 4.51 dm <sup>3</sup>  | 4.44 dm <sup>3</sup>  |
| Riser 8             | 96.12 x 19.16 x 1.91  | 3.51 dm <sup>3</sup>  | 3.47 dm <sup>3</sup>  |
| Riser 9             | 88.89 x 19.16 x 1.91  | 3.25 dm <sup>3</sup>  | 3.22 dm <sup>3</sup>  |
| Riser 10            | 86.08 x 19.16 x 1.91  | 3.14 dm <sup>3</sup>  | 3.13 dm <sup>3</sup>  |
| Riser 11            | 84.97 x 19.16 x 1.91  | 3.10 dm <sup>3</sup>  | 3.10 dm <sup>3</sup>  |
| Riser 12            | 84.58 x 19.16 x 1.91  | 3.09 dm <sup>3</sup>  | 3.09 dm <sup>3</sup>  |
| Riser 13            | 84.47 x 19.16 x 1.91  | 3.08 dm <sup>3</sup>  | 3.08 dm <sup>3</sup>  |
| Riser 14            | 84.46 x 19.16 x 1.91  | 3.08 dm <sup>3</sup>  | 3.08 dm <sup>3</sup>  |
| Right Stringboard 1 | 138.24 x 28.02 x 3.81 | 14.76 dm <sup>3</sup> | 12.64 dm <sup>3</sup> |
| Right Stringboard 2 | 193.29 x 28.02 x 3.81 | 20.63 dm <sup>3</sup> | 18.02 dm <sup>3</sup> |
| Left Stringboard 1  | 241.52 x 38.68 x 3.81 | 35.60 dm <sup>3</sup> | 24.33 dm <sup>3</sup> |
| Left Stringboard 2  | 270.39 x 41.74 x 3.81 | 43.00 dm <sup>3</sup> | 27.23 dm <sup>3</sup> |
| Right Handrail 1    | 131.29 x 6.99 x 4.48  | 4.11 dm <sup>3</sup>  | 3.91 dm <sup>3</sup>  |
| Right Handrail 2    | 174.78 x 6.99 x 4.48  | 5.48 dm <sup>3</sup>  | 5.28 dm <sup>3</sup>  |
| Newel Post 1        | 8.89 x 6.35 x 117.53  | 6.63 dm <sup>3</sup>  | 6.63 dm <sup>3</sup>  |
| Newel Post 2        | 16.51 x 8.89 x 254.00 | 37.28 dm <sup>3</sup> | 37.28 dm <sup>3</sup> |
| Newel Post 3        | 6.99 x 5.08 x 132.16  | 4.69 dm <sup>3</sup>  | 4.69 dm <sup>3</sup>  |
| Newel Post 4        | 6.99 x 5.32 x 139.99  | 5.20 dm <sup>3</sup>  | 5.20 dm <sup>3</sup>  |
| Banister 1          | 1.20 x 1.20 x 82.35   | 0.12 dm <sup>3</sup>  | 0.09 dm <sup>3</sup>  |
| Banister 2          | 1.20 x 1.20 x 83.07   | 0.12 dm <sup>3</sup>  | 0.09 dm <sup>3</sup>  |
| Banister 3          | 1.20 x 1.20 x 83.79   | 0.12 dm <sup>3</sup>  | 0.09 dm <sup>3</sup>  |
| Banister 4          | 1.20 x 1.20 x 84.51   | 0.12 dm <sup>3</sup>  | 0.10 dm <sup>3</sup>  |
| Banister 5          | 1.20 x 1.20 x 85.23   | 0.12 dm <sup>3</sup>  | 0.10 dm <sup>3</sup>  |
| Banister 6          | 1.20 x 1.20 x 85.95   | 0.12 dm <sup>3</sup>  | 0.10 dm <sup>3</sup>  |
| Banister 7          | 1.20 x 1.20 x 86.66   | 0.13 dm <sup>3</sup>  | 0.10 dm <sup>3</sup>  |
| Banister 8          | 1.20 x 1.20 x 80.67   | 0.12 dm <sup>3</sup>  | 0.09 dm <sup>3</sup>  |
| Banister 9          | 1.20 x 1.20 x 80.65   | 0.12 dm <sup>3</sup>  | 0.09 dm <sup>3</sup>  |
| Banister 10         | 1.20 x 1.20 x 80.64   | 0.12 dm <sup>3</sup>  | 0.09 dm <sup>3</sup>  |
| Banister 11         | 1.20 x 1.20 x 80.63   | 0.12 dm <sup>3</sup>  | 0.09 dm <sup>3</sup>  |
| Banister 12         | 1.20 x 1.20 x 80.62   | 0.12 dm <sup>3</sup>  | 0.09 dm <sup>3</sup>  |
| Banister 13         | 1.20 x 1.20 x 80.60   | 0.12 dm <sup>3</sup>  | 0.09 dm <sup>3</sup>  |
| Banister 14         | 1.20 x 1.20 x 80.59   | 0.12 dm <sup>3</sup>  | 0.09 dm <sup>3</sup>  |

StairDesigner  
Cutting List (2/2)

Landen

landen01v01

| Piece       | Dimensions          | Cutting List Volume  | Real Volume          |
|-------------|---------------------|----------------------|----------------------|
| Banister 15 | 1.20 x 1.20 x 80.58 | 0.12 dm <sup>3</sup> | 0.09 dm <sup>3</sup> |
| Banister 16 | 1.20 x 1.20 x 80.57 | 0.12 dm <sup>3</sup> | 0.09 dm <sup>3</sup> |
| Banister 17 | 1.20 x 1.20 x 80.55 | 0.12 dm <sup>3</sup> | 0.09 dm <sup>3</sup> |

| Piece        | Cutting List Volume    | Real Volume            | Weight    | Cost     |
|--------------|------------------------|------------------------|-----------|----------|
| Steps        | 155.10 dm <sup>3</sup> | 118.26 dm <sup>3</sup> | 118.26 kg | 93.06 £  |
| Risers       | 45.14 dm <sup>3</sup>  | 44.93 dm <sup>3</sup>  |           |          |
| Stringboards | 113.99 dm <sup>3</sup> | 82.22 dm <sup>3</sup>  | 82.22 kg  | 68.39 £  |
| Handrails    | 9.59 dm <sup>3</sup>   | 9.19 dm <sup>3</sup>   | 9.19 kg   | 5.75 £   |
| Newel Posts  | 53.81 dm <sup>3</sup>  | 53.81 dm <sup>3</sup>  | 53.81 kg  | 32.28 £  |
| Banisters    | 2.02 dm <sup>3</sup>   | 1.58 dm <sup>3</sup>   |           | 14.02 £  |
| Total        | 379.65 dm <sup>3</sup> | 309.99 dm <sup>3</sup> | 263.47 kg | 213.51 £ |