

## Venus Kitchens

Width	15640.0 mm
Depth	10750.0 mm

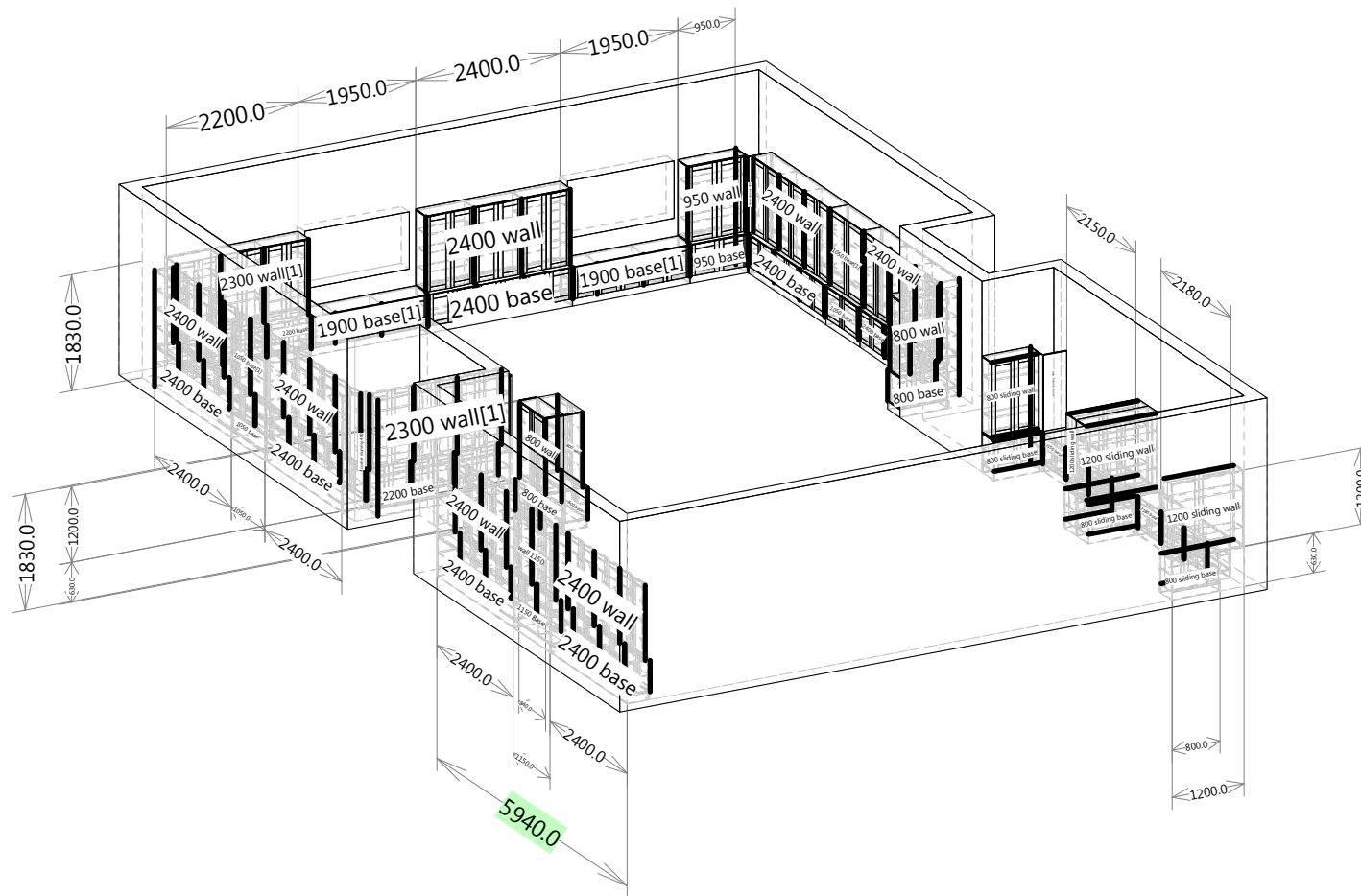

# Venus Kitchens

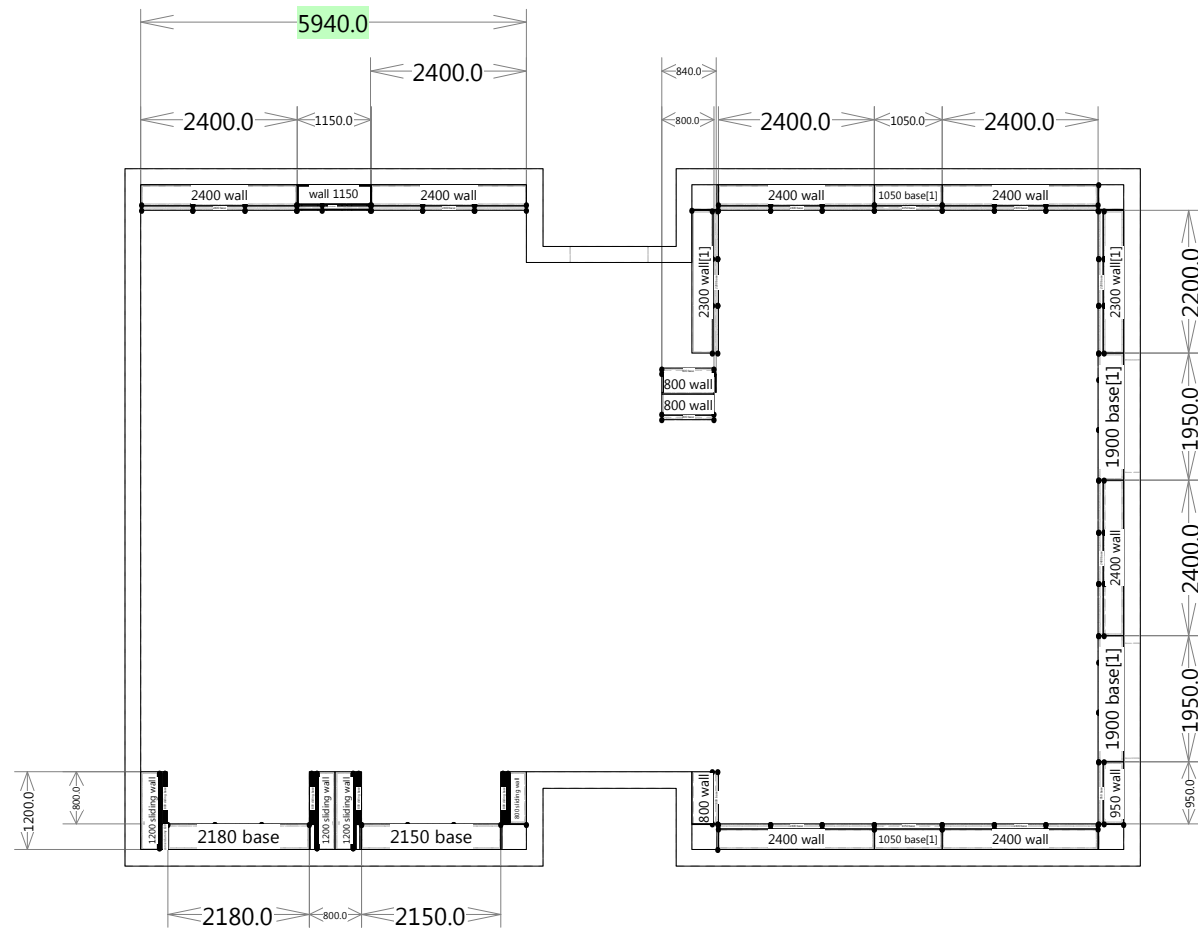

## Plan

Venus Kitchens

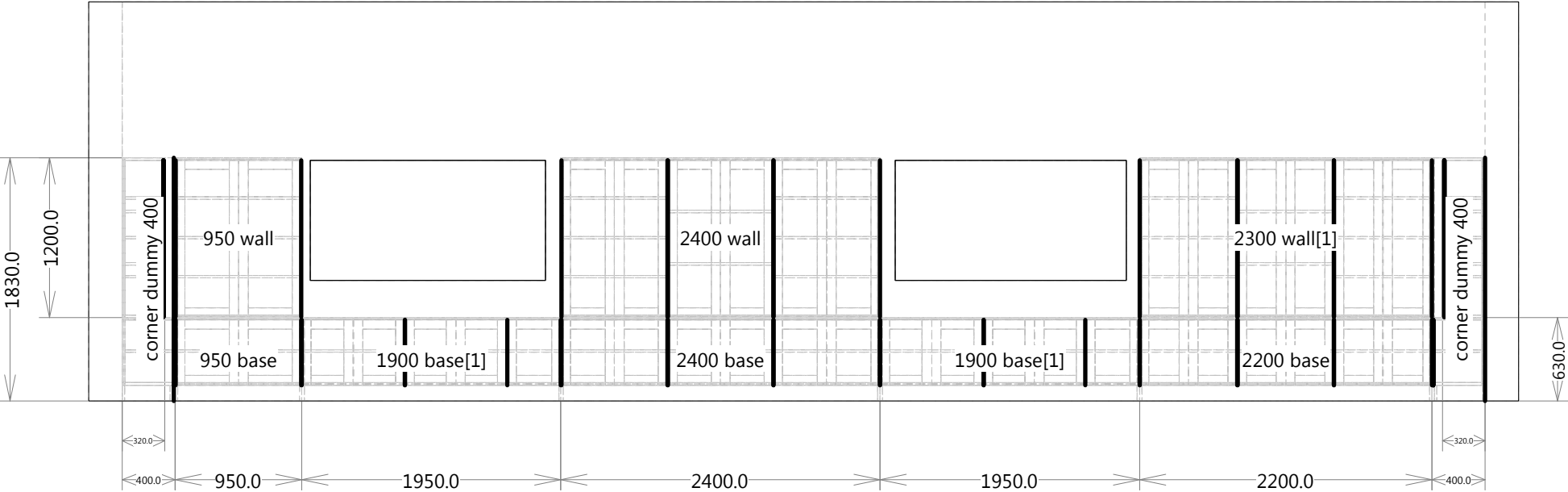

front

Venus Kitchens

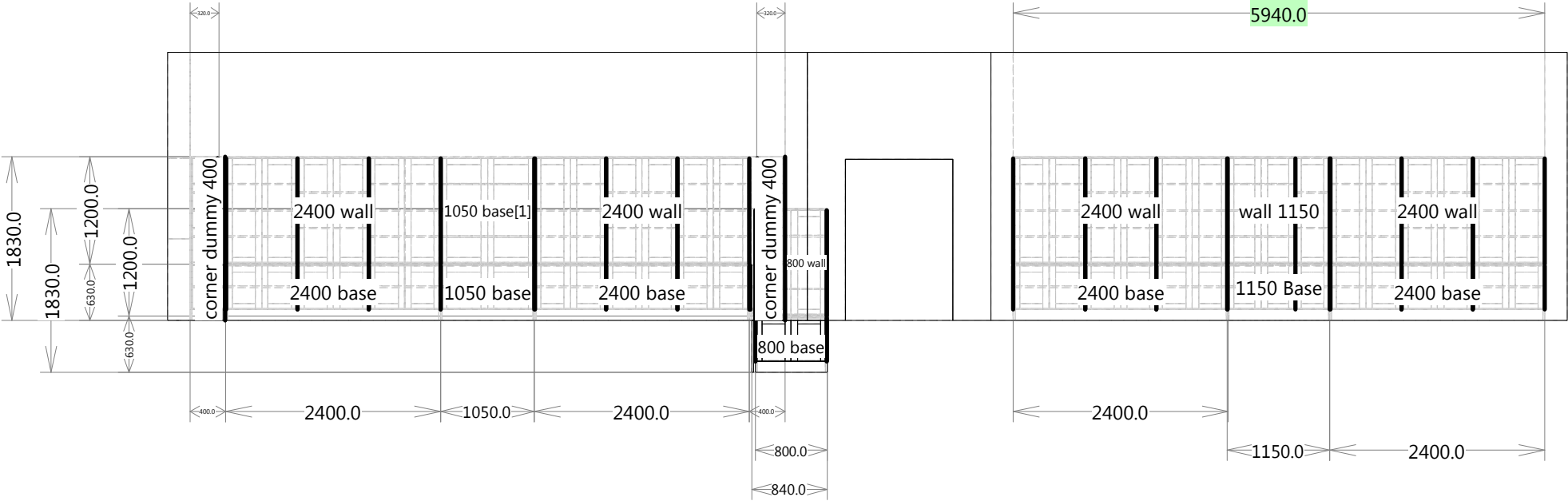

left

Venus Kitchens

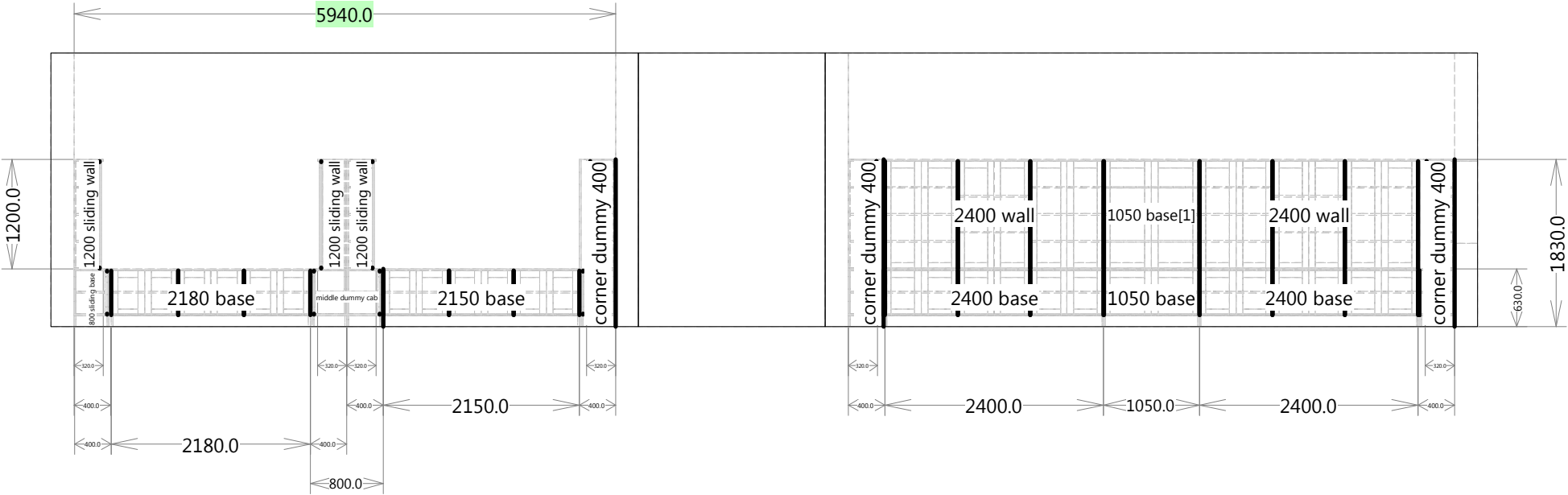

right

## Venus Kitchens

17/03/2016

### Cutting List (Net Dimensions)

Material	Reference	Height	Width	Quantity	Grain	Left Edge	Right Edge	Bottom Edge	Top Edge
<b>800 base (x3)</b>									
BWP Plywood, 17.5	Top	799.0	397.5	3	Yes	0.5 white, 0.5 mm	2mm White, 2.0 mm	0.5 white, 0.5 mm	0.5 white, 0.5 mm
BWP Plywood, 17.5	Bottom	799.0	379.0	3	Yes	0.5 white, 0.5 mm	0.5 white, 0.5 mm	0.5 white, 0.5 mm	0.5 white, 0.5 mm
BWP Plywood, 17.5	Left Side	474.0	379.0	3	Yes	0.5 white, 0.5 mm	0.5 white, 0.5 mm	0.5 white, 0.5 mm	0.5 white, 0.5 mm
BWP Plywood, 17.5	Right Side	474.0	379.0	3	Yes	0.5 white, 0.5 mm	0.5 white, 0.5 mm	0.5 white, 0.5 mm	0.5 white, 0.5 mm
Back Plywood, 8.0	Back	490.0	780.0	3	No	0.5 white, 0.5 mm	0.5 white, 0.5 mm	0.5 white, 0.5 mm	0.5 white, 0.5 mm
BWP Plywood, 17.5	Mobile Shelve [1]	764.0	356.0	3	Yes	0.5 white, 0.5 mm	0.5 white, 0.5 mm	0.5 white, 0.5 mm	0.5 white, 0.5 mm
Blue Matt, 18.0	Door 1 (double) [1]	258.0	70.0	3	Yes				
Blue Matt, 18.0	Door 1 (double) [1]	489.0	70.0	3	Yes				
Blue Matt, 18.0	Door 1 (double) [1]	258.0	70.0	3	Yes				
Blue Matt, 18.0	Door 1 (double) [1]	489.0	70.0	3	Yes				
OSB3, 18.0	Door 1 (double) [1]	349.0	258.0	3	Yes				
Yellow Matt, 18.0	Door 1 (double) [1]	258.0	70.0	3	No				
Yellow Matt, 18.0	Door 1 (double) [1]	489.0	70.0	3	No				
Yellow Matt, 18.0	Door 1 (double) [1]	258.0	70.0	3	No				
Yellow Matt, 18.0	Door 1 (double) [1]	489.0	70.0	3	No				
OSB3, 18.0	Door 1 (double) [1]	349.0	258.0	3	Yes				
BWP Plywood, 17.5	Plinth 1 [1]	119.0	378.6	3	Yes	0.5 white, 0.5 mm	0.5 white, 0.5 mm	0.5 white, 0.5 mm	0.5 white, 0.5 mm
BWP Plywood, 17.5	Plinth 1 [2]	119.0	378.6	3	Yes	0.5 white, 0.5 mm	0.5 white, 0.5 mm	0.5 white, 0.5 mm	0.5 white, 0.5 mm
BWP Plywood, 17.5	Plinth 1 [3]	119.0	798.6	3	Yes	0.5 white, 0.5 mm	0.5 white, 0.5 mm	0.5 white, 0.5 mm	0.5 white, 0.5 mm
BWP Plywood, 17.5	Plinth 1 [4]	119.0	798.6	3	Yes	0.5 white, 0.5 mm	0.5 white, 0.5 mm	0.5 white, 0.5 mm	0.5 white, 0.5 mm
<b>800 sliding base (x4)</b>									
BWP Plywood, 18.0	Top	799.0	397.5	4	Yes	0.5 white, 0.5 mm	2mm White, 2.0 mm	0.5 white, 0.5 mm	0.5 white, 0.5 mm
BWP Plywood, 18.0	Bottom	799.0	377.5	4	Yes	0.5 white, 0.5 mm	2mm White, 2.0 mm	0.5 white, 0.5 mm	0.5 white, 0.5 mm
BWP Plywood, 18.0	Left Side	473.0	377.5	4	Yes	0.5 white, 0.5 mm	2mm White, 2.0 mm	0.5 white, 0.5 mm	0.5 white, 0.5 mm
BWP Plywood, 18.0	Right Side	473.0	377.5	4	Yes	0.5 white, 0.5 mm	2mm White, 2.0 mm	0.5 white, 0.5 mm	0.5 white, 0.5 mm
Back Plywood, 8.0	Back	490.0	780.0	4	No				

## Venus Kitchens

17/03/2016

### Cutting List (Net Dimensions) (Next)

Material	Reference	Height	Width	Quantity	Grain	Left Edge	Right Edge	Bottom Edge	Top Edge
BWP Plywood, 18.0	Mobile Shelve [1]	763.0	319.0	4	Yes	0.5 white, 0.5 mm	0.5 white, 0.5 mm	0.5 white, 0.5 mm	0.5 white, 0.5 mm
Yellow Matt, 18.0	Door 1 (sliding) [1]	252.0	70.0	4	No				
Yellow Matt, 18.0	Door 1 (sliding) [1]	474.0	70.0	4	No				
Yellow Matt, 18.0	Door 1 (sliding) [1]	252.0	70.0	4	No				
Yellow Matt, 18.0	Door 1 (sliding) [1]	474.0	70.0	4	No				
OSB3, 18.0	Door 1 (sliding) [1]	334.0	252.0	4	Yes				
Blue Matt, 18.0	Door 1 (sliding) [1]	252.0	70.0	4	Yes				
Blue Matt, 18.0	Door 1 (sliding) [1]	474.0	70.0	4	Yes				
Blue Matt, 18.0	Door 1 (sliding) [1]	252.0	70.0	4	Yes				
Blue Matt, 18.0	Door 1 (sliding) [1]	474.0	70.0	4	Yes				
OSB3, 18.0	Door 1 (sliding) [1]	334.0	252.0	4	Yes				
BWP Plywood, 18.0	Plinth 1 [1]	119.0	378.6	4	Yes	0.5 white, 0.5 mm	0.5 white, 0.5 mm	0.5 white, 0.5 mm	0.5 white, 0.5 mm
BWP Plywood, 18.0	Plinth 1 [2]	119.0	378.6	4	Yes	0.5 white, 0.5 mm	0.5 white, 0.5 mm	0.5 white, 0.5 mm	0.5 white, 0.5 mm
BWP Plywood, 18.0	Plinth 1 [3]	119.0	798.6	4	Yes	0.5 white, 0.5 mm	0.5 white, 0.5 mm	0.5 white, 0.5 mm	0.5 white, 0.5 mm
BWP Plywood, 18.0	Plinth 1 [4]	119.0	798.6	4	Yes	0.5 white, 0.5 mm	0.5 white, 0.5 mm	0.5 white, 0.5 mm	0.5 white, 0.5 mm
<b>800 sliding wall</b>									
BWP Plywood, 17.5	Top	799.0	317.5	1	Yes	0.5 white, 0.5 mm	2mm White, 2.0 mm	0.5 white, 0.5 mm	0.5 white, 0.5 mm
BWP Plywood, 17.5	Bottom	799.0	297.5	1	Yes	0.5 white, 0.5 mm	2mm White, 2.0 mm	0.5 white, 0.5 mm	0.5 white, 0.5 mm
BWP Plywood, 17.5	Left Side	1164.0	297.5	1	Yes	0.5 white, 0.5 mm	2mm White, 2.0 mm	0.5 white, 0.5 mm	0.5 white, 0.5 mm
BWP Plywood, 17.5	Right Side	1164.0	297.5	1	Yes	0.5 white, 0.5 mm	2mm White, 2.0 mm	0.5 white, 0.5 mm	0.5 white, 0.5 mm
Back Plywood, 8.0	Back	1181.0	781.0	1	No				
BWP Plywood, 17.5	Mobile Shelve [1]	764.0	239.0	1	Yes	0.5 white, 0.5 mm	0.5 white, 0.5 mm	0.5 white, 0.5 mm	0.5 white, 0.5 mm
BWP Plywood, 17.5	Mobile Shelve [2]	764.0	239.0	1	Yes	0.5 white, 0.5 mm	0.5 white, 0.5 mm	0.5 white, 0.5 mm	0.5 white, 0.5 mm
BWP Plywood, 17.5	Mobile Shelve [3]	764.0	239.0	1	Yes	0.5 white, 0.5 mm	0.5 white, 0.5 mm	0.5 white, 0.5 mm	0.5 white, 0.5 mm
Blue Matt, 18.0	Door 1 (sliding) [1]	252.5	70.0	1	Yes				
Blue Matt, 18.0	Door 1 (sliding) [1]	1165.0	70.0	1	Yes				
Blue Matt, 18.0	Door 1 (sliding) [1]	252.5	70.0	1	Yes				

## Venus Kitchens

### Cutting List (Net Dimensions) (Next)

Material	Reference	Height	Width	Quantity	Grain	Left Edge	Right Edge	Bottom Edge	Top Edge
Blue Matt, 18.0	Door 1 (sliding) [1]	1165.0	70.0	1	Yes				
OSB3, 18.0	Door 1 (sliding) [1]	1025.0	252.5	1	Yes				
Yellow Matt, 18.0	Door 1 (sliding) [1]	252.5	70.0	1	No				
Yellow Matt, 18.0	Door 1 (sliding) [1]	1165.0	70.0	1	No				
Yellow Matt, 18.0	Door 1 (sliding) [1]	252.5	70.0	1	No				
Yellow Matt, 18.0	Door 1 (sliding) [1]	1165.0	70.0	1	No				
OSB3, 18.0	Door 1 (sliding) [1]	1025.0	252.5	1	Yes				
<b>800 wall (x3)</b>									
BWP Plywood, 17.5	Top	799.0	317.5	3	Yes	0.5 white, 0.5 mm	2mm White, 2.0 mm	0.5 white, 0.5 mm	0.5 white, 0.5 mm
BWP Plywood, 17.5	Bottom	799.0	299.0	3	Yes	0.5 white, 0.5 mm	0.5 white, 0.5 mm	0.5 white, 0.5 mm	0.5 white, 0.5 mm
BWP Plywood, 17.5	Left Side	1164.0	299.0	3	Yes	0.5 white, 0.5 mm	0.5 white, 0.5 mm	0.5 white, 0.5 mm	0.5 white, 0.5 mm
BWP Plywood, 17.5	Right Side	1164.0	299.0	3	Yes	0.5 white, 0.5 mm	0.5 white, 0.5 mm	0.5 white, 0.5 mm	0.5 white, 0.5 mm
Back Plywood, 8.0	Back	1180.0	780.0	3	No	0.5 white, 0.5 mm	0.5 white, 0.5 mm	0.5 white, 0.5 mm	0.5 white, 0.5 mm
BWP Plywood, 17.5	Mobile Shelve [1]	764.0	276.0	3	Yes	0.5 white, 0.5 mm	0.5 white, 0.5 mm	0.5 white, 0.5 mm	0.5 white, 0.5 mm
BWP Plywood, 17.5	Mobile Shelve [2]	764.0	276.0	3	Yes	0.5 white, 0.5 mm	0.5 white, 0.5 mm	0.5 white, 0.5 mm	0.5 white, 0.5 mm
BWP Plywood, 17.5	Mobile Shelve [3]	764.0	276.0	3	Yes	0.5 white, 0.5 mm	0.5 white, 0.5 mm	0.5 white, 0.5 mm	0.5 white, 0.5 mm
Yellow Matt, 18.0	Door 1 (double) [1]	258.0	70.0	3	No				
Yellow Matt, 18.0	Door 1 (double) [1]	1179.0	70.0	3	No				
Yellow Matt, 18.0	Door 1 (double) [1]	258.0	70.0	3	No				
Yellow Matt, 18.0	Door 1 (double) [1]	1179.0	70.0	3	No				
OSB3, 18.0	Door 1 (double) [1]	1039.0	258.0	3	Yes				
Blue Matt, 18.0	Door 1 (double) [1]	258.0	70.0	3	Yes				
Blue Matt, 18.0	Door 1 (double) [1]	1179.0	70.0	3	Yes				
Blue Matt, 18.0	Door 1 (double) [1]	258.0	70.0	3	Yes				
Blue Matt, 18.0	Door 1 (double) [1]	1179.0	70.0	3	Yes				
OSB3, 18.0	Door 1 (double) [1]	1039.0	258.0	3	Yes				



## Venus Kitchens

17/03/2016

### Cutting List (Net Dimensions) (Next)

Material	Reference	Height	Width	Quantity	Grain	Left Edge	Right Edge	Bottom Edge	Top Edge
<b>— 950 base —</b>									
BWP Plywood, 17.5	Top	949.0	397.5	1	Yes	0.5 white, 0.5 mm	2mm White, 2.0 mm	0.5 white, 0.5 mm	0.5 white, 0.5 mm
BWP Plywood, 17.5	Bottom	949.0	379.0	1	Yes	0.5 white, 0.5 mm	0.5 white, 0.5 mm	0.5 white, 0.5 mm	0.5 white, 0.5 mm
BWP Plywood, 17.5	Left Side	474.0	379.0	1	Yes	0.5 white, 0.5 mm	0.5 white, 0.5 mm	0.5 white, 0.5 mm	0.5 white, 0.5 mm
BWP Plywood, 17.5	Right Side	474.0	379.0	1	Yes	0.5 white, 0.5 mm	0.5 white, 0.5 mm	0.5 white, 0.5 mm	0.5 white, 0.5 mm
Back Plywood, 8.0	Back	490.0	930.0	1	No	0.5 white, 0.5 mm	0.5 white, 0.5 mm	0.5 white, 0.5 mm	0.5 white, 0.5 mm
BWP Plywood, 17.5	Mobile Shelve [1]	914.0	356.0	1	Yes	0.5 white, 0.5 mm	0.5 white, 0.5 mm	0.5 white, 0.5 mm	0.5 white, 0.5 mm
Blue Matt, 18.0	Door 1 (double) [1]	333.0	70.0	1	Yes				
Blue Matt, 18.0	Door 1 (double) [1]	489.0	70.0	1	Yes				
Blue Matt, 18.0	Door 1 (double) [1]	333.0	70.0	1	Yes				
Blue Matt, 18.0	Door 1 (double) [1]	489.0	70.0	1	Yes				
OSB3, 18.0	Door 1 (double) [1]	349.0	333.0	1	Yes				
Yellow Matt, 18.0	Door 1 (double) [1]	333.0	70.0	1	No				
Yellow Matt, 18.0	Door 1 (double) [1]	489.0	70.0	1	No				
Yellow Matt, 18.0	Door 1 (double) [1]	333.0	70.0	1	No				
Yellow Matt, 18.0	Door 1 (double) [1]	489.0	70.0	1	No				
OSB3, 18.0	Door 1 (double) [1]	349.0	333.0	1	Yes				
BWP Plywood, 17.5	Plinth 1 [1]	119.0	378.6	1	Yes	0.5 white, 0.5 mm	0.5 white, 0.5 mm	0.5 white, 0.5 mm	0.5 white, 0.5 mm
BWP Plywood, 17.5	Plinth 1 [2]	119.0	378.6	1	Yes	0.5 white, 0.5 mm	0.5 white, 0.5 mm	0.5 white, 0.5 mm	0.5 white, 0.5 mm
BWP Plywood, 17.5	Plinth 1 [3]	119.0	948.6	1	Yes	0.5 white, 0.5 mm	0.5 white, 0.5 mm	0.5 white, 0.5 mm	0.5 white, 0.5 mm
BWP Plywood, 17.5	Plinth 1 [4]	119.0	948.6	1	Yes	0.5 white, 0.5 mm	0.5 white, 0.5 mm	0.5 white, 0.5 mm	0.5 white, 0.5 mm
<b>— 950 wall —</b>									
BWP Plywood, 17.5	Top	949.0	317.5	1	Yes	0.5 white, 0.5 mm	2mm White, 2.0 mm	0.5 white, 0.5 mm	0.5 white, 0.5 mm
BWP Plywood, 17.5	Bottom	949.0	299.0	1	Yes	0.5 white, 0.5 mm	0.5 white, 0.5 mm	0.5 white, 0.5 mm	0.5 white, 0.5 mm
BWP Plywood, 17.5	Left Side	1164.0	299.0	1	Yes	0.5 white, 0.5 mm	0.5 white, 0.5 mm	0.5 white, 0.5 mm	0.5 white, 0.5 mm
BWP Plywood, 17.5	Right Side	1164.0	299.0	1	Yes	0.5 white, 0.5 mm	0.5 white, 0.5 mm	0.5 white, 0.5 mm	0.5 white, 0.5 mm
Back Plywood, 8.0	Back	1180.0	930.0	1	No	0.5 white, 0.5 mm	0.5 white, 0.5 mm	0.5 white, 0.5 mm	0.5 white, 0.5 mm

## Venus Kitchens

17/03/2016

### Cutting List (Net Dimensions) (Next)

Material	Reference	Height	Width	Quantity	Grain	Left Edge	Right Edge	Bottom Edge	Top Edge
BWP Plywood, 17.5	Mobile Shelve [1]	914.0	276.0	1	Yes	0.5 white, 0.5 mm	0.5 white, 0.5 mm	0.5 white, 0.5 mm	0.5 white, 0.5 mm
BWP Plywood, 17.5	Mobile Shelve [2]	914.0	276.0	1	Yes	0.5 white, 0.5 mm	0.5 white, 0.5 mm	0.5 white, 0.5 mm	0.5 white, 0.5 mm
BWP Plywood, 17.5	Mobile Shelve [3]	914.0	276.0	1	Yes	0.5 white, 0.5 mm	0.5 white, 0.5 mm	0.5 white, 0.5 mm	0.5 white, 0.5 mm
Yellow Matt, 18.0	Door 1 (double) [1]	333.0	70.0	1	No				
Yellow Matt, 18.0	Door 1 (double) [1]	1179.0	70.0	1	No				
Yellow Matt, 18.0	Door 1 (double) [1]	333.0	70.0	1	No				
Yellow Matt, 18.0	Door 1 (double) [1]	1179.0	70.0	1	No				
OSB3, 18.0	Door 1 (double) [1]	1039.0	333.0	1	Yes				
Blue Matt, 18.0	Door 1 (double) [1]	333.0	70.0	1	Yes				
Blue Matt, 18.0	Door 1 (double) [1]	1179.0	70.0	1	Yes				
Blue Matt, 18.0	Door 1 (double) [1]	333.0	70.0	1	Yes				
Blue Matt, 18.0	Door 1 (double) [1]	1179.0	70.0	1	Yes				
OSB3, 18.0	Door 1 (double) [1]	1039.0	333.0	1	Yes				
<b>1050 base (x2)</b>									
BWP Plywood, 17.5	Top	1049.0	397.5	2	Yes	0.5 white, 0.5 mm	2mm White, 2.0 mm	0.5 white, 0.5 mm	0.5 white, 0.5 mm
BWP Plywood, 17.5	Bottom	1049.0	379.0	2	Yes	0.5 white, 0.5 mm	0.5 white, 0.5 mm	0.5 white, 0.5 mm	0.5 white, 0.5 mm
BWP Plywood, 17.5	Left Side	474.0	379.0	2	Yes	0.5 white, 0.5 mm	0.5 white, 0.5 mm	0.5 white, 0.5 mm	0.5 white, 0.5 mm
BWP Plywood, 17.5	Right Side	474.0	379.0	2	Yes	0.5 white, 0.5 mm	0.5 white, 0.5 mm	0.5 white, 0.5 mm	0.5 white, 0.5 mm
Back Plywood, 8.0	Back	490.0	1030.0	2	No	0.5 white, 0.5 mm	0.5 white, 0.5 mm	0.5 white, 0.5 mm	0.5 white, 0.5 mm
BWP Plywood, 17.5	Mobile Shelve [1]	1014.0	356.0	2	Yes	0.5 white, 0.5 mm	0.5 white, 0.5 mm	0.5 white, 0.5 mm	0.5 white, 0.5 mm
Blue Matt, 18.0	Door 1 (double) [1]	383.0	70.0	2	Yes				
Blue Matt, 18.0	Door 1 (double) [1]	489.0	70.0	2	Yes				
Blue Matt, 18.0	Door 1 (double) [1]	383.0	70.0	2	Yes				
Blue Matt, 18.0	Door 1 (double) [1]	489.0	70.0	2	Yes				
OSB3, 18.0	Door 1 (double) [1]	349.0	383.0	2	Yes				
Yellow Matt, 18.0	Door 1 (double) [1]	383.0	70.0	2	No				
Yellow Matt, 18.0	Door 1 (double) [1]	489.0	70.0	2	No				

## Venus Kitchens

### Cutting List (Net Dimensions) (Next)

Material	Reference	Height	Width	Quantity	Grain	Left Edge	Right Edge	Bottom Edge	Top Edge
Yellow Matt, 18.0	Door 1 (double) [1]	383.0	70.0	2	No				
Yellow Matt, 18.0	Door 1 (double) [1]	489.0	70.0	2	No				
OSB3, 18.0	Door 1 (double) [1]	349.0	383.0	2	Yes				
BWP Plywood, 17.5	Plinth 1 [1]	119.0	378.6	2	Yes	0.5 white, 0.5 mm	0.5 white, 0.5 mm	0.5 white, 0.5 mm	0.5 white, 0.5 mm
BWP Plywood, 17.5	Plinth 1 [2]	119.0	378.6	2	Yes	0.5 white, 0.5 mm	0.5 white, 0.5 mm	0.5 white, 0.5 mm	0.5 white, 0.5 mm
BWP Plywood, 17.5	Plinth 1 [3]	119.0	1048.6	2	Yes	0.5 white, 0.5 mm	0.5 white, 0.5 mm	0.5 white, 0.5 mm	0.5 white, 0.5 mm
BWP Plywood, 17.5	Plinth 1 [4]	119.0	1048.6	2	Yes	0.5 white, 0.5 mm	0.5 white, 0.5 mm	0.5 white, 0.5 mm	0.5 white, 0.5 mm
<b>— 1050 base[1] (x2)</b>									
BWP Plywood, 17.5	Top	1049.0	317.5	2	Yes	0.5 white, 0.5 mm	2mm White, 2.0 mm	0.5 white, 0.5 mm	0.5 white, 0.5 mm
BWP Plywood, 17.5	Bottom	1049.0	299.0	2	Yes	0.5 white, 0.5 mm	0.5 white, 0.5 mm	0.5 white, 0.5 mm	0.5 white, 0.5 mm
BWP Plywood, 17.5	Left Side	1164.0	299.0	2	Yes	0.5 white, 0.5 mm	0.5 white, 0.5 mm	0.5 white, 0.5 mm	0.5 white, 0.5 mm
BWP Plywood, 17.5	Right Side	1164.0	299.0	2	Yes	0.5 white, 0.5 mm	0.5 white, 0.5 mm	0.5 white, 0.5 mm	0.5 white, 0.5 mm
Back Plywood, 8.0	Back	1180.0	1030.0	2	No	0.5 white, 0.5 mm	0.5 white, 0.5 mm	0.5 white, 0.5 mm	0.5 white, 0.5 mm
BWP Plywood, 17.5	Mobile Shelve [1]	1014.0	276.0	2	Yes	0.5 white, 0.5 mm	0.5 white, 0.5 mm	0.5 white, 0.5 mm	0.5 white, 0.5 mm
BWP Plywood, 17.5	Mobile Shelve [2]	1014.0	276.0	2	Yes	0.5 white, 0.5 mm	0.5 white, 0.5 mm	0.5 white, 0.5 mm	0.5 white, 0.5 mm
BWP Plywood, 17.5	Mobile Shelve [3]	1014.0	276.0	2	Yes	0.5 white, 0.5 mm	0.5 white, 0.5 mm	0.5 white, 0.5 mm	0.5 white, 0.5 mm
Yellow Matt, 18.0	Door 1 (double) [1]	383.0	70.0	2	No				
Yellow Matt, 18.0	Door 1 (double) [1]	1179.0	70.0	2	No				
Yellow Matt, 18.0	Door 1 (double) [1]	383.0	70.0	2	No				
Yellow Matt, 18.0	Door 1 (double) [1]	1179.0	70.0	2	No				
OSB3, 18.0	Door 1 (double) [1]	1039.0	383.0	2	Yes				
Blue Matt, 18.0	Door 1 (double) [1]	383.0	70.0	2	Yes				
Blue Matt, 18.0	Door 1 (double) [1]	1179.0	70.0	2	Yes				
Blue Matt, 18.0	Door 1 (double) [1]	383.0	70.0	2	Yes				
Blue Matt, 18.0	Door 1 (double) [1]	1179.0	70.0	2	Yes				
OSB3, 18.0	Door 1 (double) [1]	1039.0	383.0	2	Yes				

## Venus Kitchens

17/03/2016

### Cutting List (Net Dimensions) (Next)

Material	Reference	Height	Width	Quantity	Grain	Left Edge	Right Edge	Bottom Edge	Top Edge
<b>— 1150 Base —</b>									
BWP Plywood, 17.5	Top	1149.0	397.5	1	Yes	0.5 white, 0.5 mm	2mm White, 2.0 mm	0.5 white, 0.5 mm	0.5 white, 0.5 mm
BWP Plywood, 17.5	Bottom	1149.0	379.0	1	Yes	0.5 white, 0.5 mm	0.5 white, 0.5 mm	0.5 white, 0.5 mm	0.5 white, 0.5 mm
BWP Plywood, 17.5	Left Side	474.0	379.0	1	Yes	0.5 white, 0.5 mm	0.5 white, 0.5 mm	0.5 white, 0.5 mm	0.5 white, 0.5 mm
BWP Plywood, 17.5	Right Side	474.0	379.0	1	Yes	0.5 white, 0.5 mm	0.5 white, 0.5 mm	0.5 white, 0.5 mm	0.5 white, 0.5 mm
Back Plywood, 8.0	Back	490.0	1130.0	1	No	0.5 white, 0.5 mm	0.5 white, 0.5 mm	0.5 white, 0.5 mm	0.5 white, 0.5 mm
BWP Plywood, 17.5	Mobile Shelf [1]	361.2	356.0	1	Yes	0.5 white, 0.5 mm	0.5 white, 0.5 mm	0.5 white, 0.5 mm	0.5 white, 0.5 mm
BWP Plywood, 17.5	Mobile Shelf [2]	734.3	356.0	1	Yes	0.5 white, 0.5 mm	0.5 white, 0.5 mm	0.5 white, 0.5 mm	0.5 white, 0.5 mm
BWP Plywood, 17.5	Vertical Division [1]	474.0	356.0	1	Yes	0.5 white, 0.5 mm	0.5 white, 0.5 mm	0.5 white, 0.5 mm	0.5 white, 0.5 mm
Blue Matt, 18.0	Door 1 (single) [1]_T	246.9	70.0	1	Yes				
Blue Matt, 18.0	Door 1 (single) [1]_M	489.0	70.0	1	Yes				
Blue Matt, 18.0	Door 1 (single) [1]_T	246.9	70.0	1	Yes				
Blue Matt, 18.0	Door 1 (single) [1]_M	489.0	70.0	1	Yes				
OSB3, 18.0	Door 1 (single) [1]_A	349.0	246.9	1	Yes				
Yellow Matt, 18.0	Door 1 (double) [1]	239.0	70.0	1	No				
Yellow Matt, 18.0	Door 1 (double) [1]	489.0	70.0	1	No				
Yellow Matt, 18.0	Door 1 (double) [1]	239.0	70.0	1	No				
Yellow Matt, 18.0	Door 1 (double) [1]	489.0	70.0	1	No				
OSB3, 18.0	Door 1 (double) [1]	349.0	239.0	1	Yes				
Blue Matt, 18.0	Door 1 (double) [1]	239.0	70.0	1	Yes				
Blue Matt, 18.0	Door 1 (double) [1]	489.0	70.0	1	Yes				
Blue Matt, 18.0	Door 1 (double) [1]	239.0	70.0	1	Yes				
Blue Matt, 18.0	Door 1 (double) [1]	489.0	70.0	1	Yes				
OSB3, 18.0	Door 1 (double) [1]	349.0	239.0	1	Yes				
BWP Plywood, 17.5	Plinth 1 [1]	119.0	378.6	1	Yes	0.5 white, 0.5 mm	0.5 white, 0.5 mm	0.5 white, 0.5 mm	0.5 white, 0.5 mm
BWP Plywood, 17.5	Plinth 1 [2]	119.0	378.6	1	Yes	0.5 white, 0.5 mm	0.5 white, 0.5 mm	0.5 white, 0.5 mm	0.5 white, 0.5 mm
BWP Plywood, 17.5	Plinth 1 [3]	119.0	1148.6	1	Yes	0.5 white, 0.5 mm	0.5 white, 0.5 mm	0.5 white, 0.5 mm	0.5 white, 0.5 mm

## Venus Kitchens

### Cutting List (Net Dimensions) (Next)

Material	Reference	Height	Width	Quantity	Grain	Left Edge	Right Edge	Bottom Edge	Top Edge
BWP Plywood, 17.5	Plinth 1 [4]	119.0	1148.6	1	Yes	0.5 white, 0.5 mm	0.5 white, 0.5 mm	0.5 white, 0.5 mm	0.5 white, 0.5 mm
<b>— 1200 sliding wall (x3) —</b>									
BWP Plywood, 17.5	Top	1199.0	317.5	3	Yes	0.5 white, 0.5 mm	2mm White, 2.0 mm	0.5 white, 0.5 mm	0.5 white, 0.5 mm
BWP Plywood, 17.5	Bottom	1199.0	297.5	3	Yes	0.5 white, 0.5 mm	2mm White, 2.0 mm	0.5 white, 0.5 mm	0.5 white, 0.5 mm
BWP Plywood, 17.5	Left Side	1164.0	297.5	3	Yes	0.5 white, 0.5 mm	2mm White, 2.0 mm	0.5 white, 0.5 mm	0.5 white, 0.5 mm
BWP Plywood, 17.5	Right Side	1164.0	297.5	3	Yes	0.5 white, 0.5 mm	2mm White, 2.0 mm	0.5 white, 0.5 mm	0.5 white, 0.5 mm
Back Plywood, 8.0	Back	1181.0	1181.0	3	No				
BWP Plywood, 17.5	Mobile Shelf [1]	1164.0	239.0	3	Yes	0.5 white, 0.5 mm	0.5 white, 0.5 mm	0.5 white, 0.5 mm	0.5 white, 0.5 mm
BWP Plywood, 17.5	Mobile Shelf [2]	1164.0	239.0	3	Yes	0.5 white, 0.5 mm	0.5 white, 0.5 mm	0.5 white, 0.5 mm	0.5 white, 0.5 mm
BWP Plywood, 17.5	Mobile Shelf [3]	1164.0	239.0	3	Yes	0.5 white, 0.5 mm	0.5 white, 0.5 mm	0.5 white, 0.5 mm	0.5 white, 0.5 mm
Blue Matt, 18.0	Door 1 (sliding) [1]	452.5	70.0	3	Yes				
Blue Matt, 18.0	Door 1 (sliding) [1]	1165.0	70.0	3	Yes				
Blue Matt, 18.0	Door 1 (sliding) [1]	452.5	70.0	3	Yes				
Blue Matt, 18.0	Door 1 (sliding) [1]	1165.0	70.0	3	Yes				
OSB3, 18.0	Door 1 (sliding) [1]	1025.0	452.5	3	Yes				
Yellow Matt, 18.0	Door 1 (sliding) [1]	452.5	70.0	3	No				
Yellow Matt, 18.0	Door 1 (sliding) [1]	1165.0	70.0	3	No				
Yellow Matt, 18.0	Door 1 (sliding) [1]	452.5	70.0	3	No				
Yellow Matt, 18.0	Door 1 (sliding) [1]	1165.0	70.0	3	No				
OSB3, 18.0	Door 1 (sliding) [1]	1025.0	452.5	3	Yes				
<b>— 1900 base[1] (x2) —</b>									
BWP Plywood, 17.5	Top	1949.0	397.5	2	Yes	0.5 white, 0.5 mm	2mm White, 2.0 mm	0.5 white, 0.5 mm	0.5 white, 0.5 mm
BWP Plywood, 17.5	Bottom	1949.0	379.0	2	Yes	0.5 white, 0.5 mm	0.5 white, 0.5 mm	0.5 white, 0.5 mm	0.5 white, 0.5 mm
BWP Plywood, 17.5	Left Side	474.0	379.0	2	Yes	0.5 white, 0.5 mm	0.5 white, 0.5 mm	0.5 white, 0.5 mm	0.5 white, 0.5 mm
BWP Plywood, 17.5	Right Side	474.0	379.0	2	Yes	0.5 white, 0.5 mm	0.5 white, 0.5 mm	0.5 white, 0.5 mm	0.5 white, 0.5 mm
Back Plywood, 8.0	Back	490.0	1930.0	2	No	0.5 white, 0.5 mm	0.5 white, 0.5 mm	0.5 white, 0.5 mm	0.5 white, 0.5 mm
BWP Plywood, 17.5	Mobile Shelf [1]	378.5	356.0	2	Yes	0.5 white, 0.5 mm	0.5 white, 0.5 mm	0.5 white, 0.5 mm	0.5 white, 0.5 mm

## Venus Kitchens

17/03/2016

### Cutting List (Net Dimensions) (Next)

Material	Reference	Height	Width	Quantity	Grain	Left Edge	Right Edge	Bottom Edge	Top Edge
BWP Plywood, 17.5	Mobile Shelve [2]	749.3	356.0	2	Yes	0.5 white, 0.5 mm	0.5 white, 0.5 mm	0.5 white, 0.5 mm	0.5 white, 0.5 mm
BWP Plywood, 17.5	Mobile Shelve [3]	749.3	356.0	2	Yes	0.5 white, 0.5 mm	0.5 white, 0.5 mm	0.5 white, 0.5 mm	0.5 white, 0.5 mm
BWP Plywood, 17.5	Vertical Division [1]	474.0	356.0	2	Yes	0.5 white, 0.5 mm	0.5 white, 0.5 mm	0.5 white, 0.5 mm	0.5 white, 0.5 mm
BWP Plywood, 17.5	Vertical Division [2]	474.0	356.0	2	Yes	0.5 white, 0.5 mm	0.5 white, 0.5 mm	0.5 white, 0.5 mm	0.5 white, 0.5 mm
Blue Matt, 18.0	Door 1 (single) [1]_T	264.3	70.0	2	Yes				
Blue Matt, 18.0	Door 1 (single) [1]_M	489.0	70.0	2	Yes				
Blue Matt, 18.0	Door 1 (single) [1]_T	264.3	70.0	2	Yes				
Blue Matt, 18.0	Door 1 (single) [1]_M	489.0	70.0	2	Yes				
OSB3, 18.0	Door 1 (single) [1]_A	349.0	264.3	2	Yes				
Yellow Matt, 18.0	Door 1 (double) [1]	242.4	70.0	2	No				
Yellow Matt, 18.0	Door 1 (double) [1]	489.0	70.0	2	No				
Yellow Matt, 18.0	Door 1 (double) [1]	242.4	70.0	2	No				
Yellow Matt, 18.0	Door 1 (double) [1]	489.0	70.0	2	No				
OSB3, 18.0	Door 1 (double) [1]	349.0	242.4	2	Yes				
Blue Matt, 18.0	Door 1 (double) [1]	242.4	70.0	2	Yes				
Blue Matt, 18.0	Door 1 (double) [1]	489.0	70.0	2	Yes				
Blue Matt, 18.0	Door 1 (double) [1]	242.4	70.0	2	Yes				
Blue Matt, 18.0	Door 1 (double) [1]	489.0	70.0	2	Yes				
OSB3, 18.0	Door 1 (double) [1]	349.0	242.4	2	Yes				
Yellow Matt, 18.0	Door 1 (double) [2]	246.5	70.0	2	No				
Yellow Matt, 18.0	Door 1 (double) [2]	489.0	70.0	2	No				
Yellow Matt, 18.0	Door 1 (double) [2]	246.5	70.0	2	No				
Yellow Matt, 18.0	Door 1 (double) [2]	489.0	70.0	2	No				
OSB3, 18.0	Door 1 (double) [2]	349.0	246.5	2	Yes				
Blue Matt, 18.0	Door 1 (double) [2]	246.5	70.0	2	Yes				
Blue Matt, 18.0	Door 1 (double) [2]	489.0	70.0	2	Yes				
Blue Matt, 18.0	Door 1 (double) [2]	246.5	70.0	2	Yes				

## Venus Kitchens

### Cutting List (Net Dimensions) (Next)

Material	Reference	Height	Width	Quantity	Grain	Left Edge	Right Edge	Bottom Edge	Top Edge
Blue Matt, 18.0	Door 1 (double) [2]	489.0	70.0	2	Yes				
OSB3, 18.0	Door 1 (double) [2]	349.0	246.5	2	Yes				
BWP Plywood, 17.5	Plinth 1 [1]	119.0	378.6	2	Yes	0.5 white, 0.5 mm	0.5 white, 0.5 mm	0.5 white, 0.5 mm	0.5 white, 0.5 mm
BWP Plywood, 17.5	Plinth 1 [2]	119.0	378.6	2	Yes	0.5 white, 0.5 mm	0.5 white, 0.5 mm	0.5 white, 0.5 mm	0.5 white, 0.5 mm
BWP Plywood, 17.5	Plinth 1 [3]	119.0	1948.6	2	Yes	0.5 white, 0.5 mm	0.5 white, 0.5 mm	0.5 white, 0.5 mm	0.5 white, 0.5 mm
BWP Plywood, 17.5	Plinth 1 [4]	119.0	1948.6	2	Yes	0.5 white, 0.5 mm	0.5 white, 0.5 mm	0.5 white, 0.5 mm	0.5 white, 0.5 mm
<b>2150 base</b>									
BWP Plywood, 18.0	Top	2149.0	397.5	1	Yes	0.5 white, 0.5 mm	2mm White, 2.0 mm	0.5 white, 0.5 mm	0.5 white, 0.5 mm
BWP Plywood, 18.0	Bottom	2149.0	379.0	1	Yes	0.5 white, 0.5 mm	0.5 white, 0.5 mm	0.5 white, 0.5 mm	0.5 white, 0.5 mm
BWP Plywood, 18.0	Left Side	473.0	379.0	1	Yes	0.5 white, 0.5 mm	0.5 white, 0.5 mm	0.5 white, 0.5 mm	0.5 white, 0.5 mm
BWP Plywood, 18.0	Right Side	473.0	379.0	1	Yes	0.5 white, 0.5 mm	0.5 white, 0.5 mm	0.5 white, 0.5 mm	0.5 white, 0.5 mm
Back Plywood, 8.0	Back	489.0	2129.0	1	No	0.5 white, 0.5 mm	0.5 white, 0.5 mm	0.5 white, 0.5 mm	0.5 white, 0.5 mm
BWP Plywood, 18.0	Mobile Shelve [1]	691.7	356.0	1	Yes	0.5 white, 0.5 mm	0.5 white, 0.5 mm	0.5 white, 0.5 mm	0.5 white, 0.5 mm
BWP Plywood, 18.0	Mobile Shelve [2]	691.7	356.0	1	Yes	0.5 white, 0.5 mm	0.5 white, 0.5 mm	0.5 white, 0.5 mm	0.5 white, 0.5 mm
BWP Plywood, 18.0	Mobile Shelve [3]	691.7	356.0	1	Yes	0.5 white, 0.5 mm	0.5 white, 0.5 mm	0.5 white, 0.5 mm	0.5 white, 0.5 mm
BWP Plywood, 18.0	Vertical Division [1]	473.0	356.0	1	Yes	0.5 white, 0.5 mm	0.5 white, 0.5 mm	0.5 white, 0.5 mm	0.5 white, 0.5 mm
BWP Plywood, 18.0	Vertical Division [2]	473.0	356.0	1	Yes	0.5 white, 0.5 mm	0.5 white, 0.5 mm	0.5 white, 0.5 mm	0.5 white, 0.5 mm
Blue Matt, 18.0	Door 1 (double) [1]	213.8	70.0	1	Yes				
Blue Matt, 18.0	Door 1 (double) [1]	489.0	70.0	1	Yes				
Blue Matt, 18.0	Door 1 (double) [1]	213.8	70.0	1	Yes				
Blue Matt, 18.0	Door 1 (double) [1]	489.0	70.0	1	Yes				
OSB3, 18.0	Door 1 (double) [1]	349.0	213.8	1	Yes				
Yellow Matt, 18.0	Door 1 (double) [1]	213.8	70.0	1	No				
Yellow Matt, 18.0	Door 1 (double) [1]	489.0	70.0	1	No				
Yellow Matt, 18.0	Door 1 (double) [1]	213.8	70.0	1	No				
Yellow Matt, 18.0	Door 1 (double) [1]	489.0	70.0	1	No				
OSB3, 18.0	Door 1 (double) [1]	349.0	213.8	1	Yes				

## Venus Kitchens

17/03/2016

### Cutting List (Net Dimensions) (Next)

Material	Reference	Height	Width	Quantity	Grain	Left Edge	Right Edge	Bottom Edge	Top Edge
Blue Matt, 18.0	Door 1 (double) [2]	218.1	70.0	1	Yes				
Blue Matt, 18.0	Door 1 (double) [2]	489.0	70.0	1	Yes				
Blue Matt, 18.0	Door 1 (double) [2]	218.1	70.0	1	Yes				
Blue Matt, 18.0	Door 1 (double) [2]	489.0	70.0	1	Yes				
OSB3, 18.0	Door 1 (double) [2]	349.0	218.1	1	Yes				
Yellow Matt, 18.0	Door 1 (double) [2]	218.1	70.0	1	No				
Yellow Matt, 18.0	Door 1 (double) [2]	489.0	70.0	1	No				
Yellow Matt, 18.0	Door 1 (double) [2]	218.1	70.0	1	No				
Yellow Matt, 18.0	Door 1 (double) [2]	489.0	70.0	1	No				
OSB3, 18.0	Door 1 (double) [2]	349.0	218.1	1	Yes				
Blue Matt, 18.0	Door 2 (double) [1]	218.1	70.0	1	Yes				
Blue Matt, 18.0	Door 2 (double) [1]	489.0	70.0	1	Yes				
Blue Matt, 18.0	Door 2 (double) [1]	218.1	70.0	1	Yes				
Blue Matt, 18.0	Door 2 (double) [1]	489.0	70.0	1	Yes				
OSB3, 18.0	Door 2 (double) [1]	349.0	218.1	1	Yes				
Yellow Matt, 18.0	Door 2 (double) [1]	218.1	70.0	1	No				
Yellow Matt, 18.0	Door 2 (double) [1]	489.0	70.0	1	No				
Yellow Matt, 18.0	Door 2 (double) [1]	218.1	70.0	1	No				
Yellow Matt, 18.0	Door 2 (double) [1]	489.0	70.0	1	No				
OSB3, 18.0	Door 2 (double) [1]	349.0	218.1	1	Yes				
BWP Plywood, 18.0	Plinth 1 [1]	119.0	378.6	1	Yes	0.5 white, 0.5 mm	0.5 white, 0.5 mm	0.5 white, 0.5 mm	0.5 white, 0.5 mm
BWP Plywood, 18.0	Plinth 1 [2]	119.0	378.6	1	Yes	0.5 white, 0.5 mm	0.5 white, 0.5 mm	0.5 white, 0.5 mm	0.5 white, 0.5 mm
BWP Plywood, 18.0	Plinth 1 [3]	119.0	2148.6	1	Yes	0.5 white, 0.5 mm	0.5 white, 0.5 mm	0.5 white, 0.5 mm	0.5 white, 0.5 mm
BWP Plywood, 18.0	Plinth 1 [4]	119.0	2148.6	1	Yes	0.5 white, 0.5 mm	0.5 white, 0.5 mm	0.5 white, 0.5 mm	0.5 white, 0.5 mm
<b>2180 base</b>									
BWP Plywood, 18.0	Top	2179.0	397.5	1	Yes	0.5 white, 0.5 mm	2mm White, 2.0 mm	0.5 white, 0.5 mm	0.5 white, 0.5 mm
BWP Plywood, 18.0	Bottom	2179.0	379.0	1	Yes	0.5 white, 0.5 mm	0.5 white, 0.5 mm	0.5 white, 0.5 mm	0.5 white, 0.5 mm



## Venus Kitchens

17/03/2016

### Cutting List (Net Dimensions) (Next)

Material	Reference	Height	Width	Quantity	Grain	Left Edge	Right Edge	Bottom Edge	Top Edge
BWP Plywood, 18.0	Left Side	473.0	379.0	1	Yes	0.5 white, 0.5 mm	0.5 white, 0.5 mm	0.5 white, 0.5 mm	0.5 white, 0.5 mm
BWP Plywood, 18.0	Right Side	473.0	379.0	1	Yes	0.5 white, 0.5 mm	0.5 white, 0.5 mm	0.5 white, 0.5 mm	0.5 white, 0.5 mm
Back Plywood, 8.0	Back	489.0	2159.0	1	No	0.5 white, 0.5 mm	0.5 white, 0.5 mm	0.5 white, 0.5 mm	0.5 white, 0.5 mm
BWP Plywood, 18.0	Mobile Shelve [1]	701.7	356.0	1	Yes	0.5 white, 0.5 mm	0.5 white, 0.5 mm	0.5 white, 0.5 mm	0.5 white, 0.5 mm
BWP Plywood, 18.0	Mobile Shelve [2]	701.7	356.0	1	Yes	0.5 white, 0.5 mm	0.5 white, 0.5 mm	0.5 white, 0.5 mm	0.5 white, 0.5 mm
BWP Plywood, 18.0	Mobile Shelve [3]	701.7	356.0	1	Yes	0.5 white, 0.5 mm	0.5 white, 0.5 mm	0.5 white, 0.5 mm	0.5 white, 0.5 mm
BWP Plywood, 18.0	Vertical Division [1]	473.0	356.0	1	Yes	0.5 white, 0.5 mm	0.5 white, 0.5 mm	0.5 white, 0.5 mm	0.5 white, 0.5 mm
BWP Plywood, 18.0	Vertical Division [2]	473.0	356.0	1	Yes	0.5 white, 0.5 mm	0.5 white, 0.5 mm	0.5 white, 0.5 mm	0.5 white, 0.5 mm
Blue Matt, 18.0	Door 1 (double) [1]	218.8	70.0	1	Yes				
Blue Matt, 18.0	Door 1 (double) [1]	489.0	70.0	1	Yes				
Blue Matt, 18.0	Door 1 (double) [1]	218.8	70.0	1	Yes				
Blue Matt, 18.0	Door 1 (double) [1]	489.0	70.0	1	Yes				
OSB3, 18.0	Door 1 (double) [1]	349.0	218.8	1	Yes				
Yellow Matt, 18.0	Door 1 (double) [1]	218.8	70.0	1	No				
Yellow Matt, 18.0	Door 1 (double) [1]	489.0	70.0	1	No				
Yellow Matt, 18.0	Door 1 (double) [1]	218.8	70.0	1	No				
Yellow Matt, 18.0	Door 1 (double) [1]	489.0	70.0	1	No				
OSB3, 18.0	Door 1 (double) [1]	349.0	218.8	1	Yes				
Blue Matt, 18.0	Door 1 (double) [2]	223.1	70.0	1	Yes				
Blue Matt, 18.0	Door 1 (double) [2]	489.0	70.0	1	Yes				
Blue Matt, 18.0	Door 1 (double) [2]	223.1	70.0	1	Yes				
Blue Matt, 18.0	Door 1 (double) [2]	489.0	70.0	1	Yes				
OSB3, 18.0	Door 1 (double) [2]	349.0	223.1	1	Yes				
Yellow Matt, 18.0	Door 1 (double) [2]	223.1	70.0	1	No				
Yellow Matt, 18.0	Door 1 (double) [2]	489.0	70.0	1	No				
Yellow Matt, 18.0	Door 1 (double) [2]	223.1	70.0	1	No				
Yellow Matt, 18.0	Door 1 (double) [2]	489.0	70.0	1	No				

## Venus Kitchens

17/03/2016

### Cutting List (Net Dimensions) (Next)

Material	Reference	Height	Width	Quantity	Grain	Left Edge	Right Edge	Bottom Edge	Top Edge
OSB3, 18.0	Door 1 (double) [2]	349.0	223.1	1	Yes				
Blue Matt, 18.0	Door 2 (double) [1]	223.1	70.0	1	Yes				
Blue Matt, 18.0	Door 2 (double) [1]	489.0	70.0	1	Yes				
Blue Matt, 18.0	Door 2 (double) [1]	223.1	70.0	1	Yes				
Blue Matt, 18.0	Door 2 (double) [1]	489.0	70.0	1	Yes				
OSB3, 18.0	Door 2 (double) [1]	349.0	223.1	1	Yes				
Yellow Matt, 18.0	Door 2 (double) [1]	223.1	70.0	1	No				
Yellow Matt, 18.0	Door 2 (double) [1]	489.0	70.0	1	No				
Yellow Matt, 18.0	Door 2 (double) [1]	223.1	70.0	1	No				
Yellow Matt, 18.0	Door 2 (double) [1]	489.0	70.0	1	No				
OSB3, 18.0	Door 2 (double) [1]	349.0	223.1	1	Yes				
BWP Plywood, 18.0	Plinth 1 [1]	119.0	378.6	1	Yes	0.5 white, 0.5 mm	0.5 white, 0.5 mm	0.5 white, 0.5 mm	0.5 white, 0.5 mm
BWP Plywood, 18.0	Plinth 1 [2]	119.0	378.6	1	Yes	0.5 white, 0.5 mm	0.5 white, 0.5 mm	0.5 white, 0.5 mm	0.5 white, 0.5 mm
BWP Plywood, 18.0	Plinth 1 [3]	119.0	2178.6	1	Yes	0.5 white, 0.5 mm	0.5 white, 0.5 mm	0.5 white, 0.5 mm	0.5 white, 0.5 mm
BWP Plywood, 18.0	Plinth 1 [4]	119.0	2178.6	1	Yes	0.5 white, 0.5 mm	0.5 white, 0.5 mm	0.5 white, 0.5 mm	0.5 white, 0.5 mm
<b>2200 base (x2)</b>									
BWP Plywood, 18.0	Top	2199.0	397.5	2	Yes	0.5 white, 0.5 mm	2mm White, 2.0 mm	0.5 white, 0.5 mm	0.5 white, 0.5 mm
BWP Plywood, 18.0	Bottom	2199.0	379.0	2	Yes	0.5 white, 0.5 mm	0.5 white, 0.5 mm	0.5 white, 0.5 mm	0.5 white, 0.5 mm
BWP Plywood, 18.0	Left Side	473.0	379.0	2	Yes	0.5 white, 0.5 mm	0.5 white, 0.5 mm	0.5 white, 0.5 mm	0.5 white, 0.5 mm
BWP Plywood, 18.0	Right Side	473.0	379.0	2	Yes	0.5 white, 0.5 mm	0.5 white, 0.5 mm	0.5 white, 0.5 mm	0.5 white, 0.5 mm
Back Plywood, 8.0	Back	489.0	2179.0	2	No	0.5 white, 0.5 mm	0.5 white, 0.5 mm	0.5 white, 0.5 mm	0.5 white, 0.5 mm
BWP Plywood, 18.0	Mobile Shelve [1]	708.3	356.0	2	Yes	0.5 white, 0.5 mm	0.5 white, 0.5 mm	0.5 white, 0.5 mm	0.5 white, 0.5 mm
BWP Plywood, 18.0	Mobile Shelve [2]	708.3	356.0	2	Yes	0.5 white, 0.5 mm	0.5 white, 0.5 mm	0.5 white, 0.5 mm	0.5 white, 0.5 mm
BWP Plywood, 18.0	Mobile Shelve [3]	708.3	356.0	2	Yes	0.5 white, 0.5 mm	0.5 white, 0.5 mm	0.5 white, 0.5 mm	0.5 white, 0.5 mm
BWP Plywood, 18.0	Vertical Division [1]	473.0	356.0	2	Yes	0.5 white, 0.5 mm	0.5 white, 0.5 mm	0.5 white, 0.5 mm	0.5 white, 0.5 mm
BWP Plywood, 18.0	Vertical Division [2]	473.0	356.0	2	Yes	0.5 white, 0.5 mm	0.5 white, 0.5 mm	0.5 white, 0.5 mm	0.5 white, 0.5 mm
Blue Matt, 18.0	Door 1 (double) [1]	222.2	70.0	2	Yes				

## Venus Kitchens

### Cutting List (Net Dimensions) (Next)

Material	Reference	Height	Width	Quantity	Grain	Left Edge	Right Edge	Bottom Edge	Top Edge
Blue Matt, 18.0	Door 1 (double) [1]	489.0	70.0	2	Yes				
Blue Matt, 18.0	Door 1 (double) [1]	222.2	70.0	2	Yes				
Blue Matt, 18.0	Door 1 (double) [1]	489.0	70.0	2	Yes				
OSB3, 18.0	Door 1 (double) [1]	349.0	222.2	2	Yes				
Yellow Matt, 18.0	Door 1 (double) [1]	222.2	70.0	2	No				
Yellow Matt, 18.0	Door 1 (double) [1]	489.0	70.0	2	No				
Yellow Matt, 18.0	Door 1 (double) [1]	222.2	70.0	2	No				
Yellow Matt, 18.0	Door 1 (double) [1]	489.0	70.0	2	No				
OSB3, 18.0	Door 1 (double) [1]	349.0	222.2	2	Yes				
Blue Matt, 18.0	Door 1 (double) [2]	226.4	70.0	2	Yes				
Blue Matt, 18.0	Door 1 (double) [2]	489.0	70.0	2	Yes				
Blue Matt, 18.0	Door 1 (double) [2]	226.4	70.0	2	Yes				
Blue Matt, 18.0	Door 1 (double) [2]	489.0	70.0	2	Yes				
OSB3, 18.0	Door 1 (double) [2]	349.0	226.4	2	Yes				
Yellow Matt, 18.0	Door 1 (double) [2]	226.4	70.0	2	No				
Yellow Matt, 18.0	Door 1 (double) [2]	489.0	70.0	2	No				
Yellow Matt, 18.0	Door 1 (double) [2]	226.4	70.0	2	No				
Yellow Matt, 18.0	Door 1 (double) [2]	489.0	70.0	2	No				
OSB3, 18.0	Door 1 (double) [2]	349.0	226.4	2	Yes				
Blue Matt, 18.0	Door 2 (double) [1]	226.4	70.0	2	Yes				
Blue Matt, 18.0	Door 2 (double) [1]	489.0	70.0	2	Yes				
Blue Matt, 18.0	Door 2 (double) [1]	226.4	70.0	2	Yes				
Blue Matt, 18.0	Door 2 (double) [1]	489.0	70.0	2	Yes				
OSB3, 18.0	Door 2 (double) [1]	349.0	226.4	2	Yes				
Yellow Matt, 18.0	Door 2 (double) [1]	226.4	70.0	2	No				
Yellow Matt, 18.0	Door 2 (double) [1]	489.0	70.0	2	No				
Yellow Matt, 18.0	Door 2 (double) [1]	226.4	70.0	2	No				

## Venus Kitchens

### Cutting List (Net Dimensions) (Next)

Material	Reference	Height	Width	Quantity	Grain	Left Edge	Right Edge	Bottom Edge	Top Edge
Yellow Matt, 18.0	Door 2 (double) [1]	489.0	70.0	2	No				
OSB3, 18.0	Door 2 (double) [1]	349.0	226.4	2	Yes				
BWP Plywood, 18.0	Plinth 1 [1]	119.0	378.6	2	Yes	0.5 white, 0.5 mm	0.5 white, 0.5 mm	0.5 white, 0.5 mm	0.5 white, 0.5 mm
BWP Plywood, 18.0	Plinth 1 [2]	119.0	378.6	2	Yes	0.5 white, 0.5 mm	0.5 white, 0.5 mm	0.5 white, 0.5 mm	0.5 white, 0.5 mm
BWP Plywood, 18.0	Plinth 1 [3]	119.0	2198.6	2	Yes	0.5 white, 0.5 mm	0.5 white, 0.5 mm	0.5 white, 0.5 mm	0.5 white, 0.5 mm
BWP Plywood, 18.0	Plinth 1 [4]	119.0	2198.6	2	Yes	0.5 white, 0.5 mm	0.5 white, 0.5 mm	0.5 white, 0.5 mm	0.5 white, 0.5 mm
<b>— 2300 wall[1] (x2) —</b>									
BWP Plywood, 17.5	Top	2199.0	317.5	2	Yes	0.5 white, 0.5 mm	2mm White, 2.0 mm	0.5 white, 0.5 mm	0.5 white, 0.5 mm
BWP Plywood, 17.5	Bottom	2199.0	299.0	2	Yes	0.5 white, 0.5 mm	0.5 white, 0.5 mm	0.5 white, 0.5 mm	0.5 white, 0.5 mm
BWP Plywood, 17.5	Left Side	1164.0	299.0	2	Yes	0.5 white, 0.5 mm	0.5 white, 0.5 mm	0.5 white, 0.5 mm	0.5 white, 0.5 mm
BWP Plywood, 17.5	Right Side	1164.0	299.0	2	Yes	0.5 white, 0.5 mm	0.5 white, 0.5 mm	0.5 white, 0.5 mm	0.5 white, 0.5 mm
Back Plywood, 8.0	Back	1180.0	2180.0	2	No	0.5 white, 0.5 mm	0.5 white, 0.5 mm	0.5 white, 0.5 mm	0.5 white, 0.5 mm
BWP Plywood, 17.5	Fixed Shelve [1]	709.0	276.0	2	Yes	0.5 white, 0.5 mm	0.5 white, 0.5 mm	0.5 white, 0.5 mm	0.5 white, 0.5 mm
BWP Plywood, 17.5	Fixed Shelve [2]	709.0	276.0	2	Yes	0.5 white, 0.5 mm	0.5 white, 0.5 mm	0.5 white, 0.5 mm	0.5 white, 0.5 mm
BWP Plywood, 17.5	Fixed Shelve [3]	709.0	276.0	2	Yes	0.5 white, 0.5 mm	0.5 white, 0.5 mm	0.5 white, 0.5 mm	0.5 white, 0.5 mm
BWP Plywood, 17.5	Fixed Shelve [4]	709.0	276.0	2	Yes	0.5 white, 0.5 mm	0.5 white, 0.5 mm	0.5 white, 0.5 mm	0.5 white, 0.5 mm
BWP Plywood, 17.5	Fixed Shelve [5]	709.0	276.0	2	Yes	0.5 white, 0.5 mm	0.5 white, 0.5 mm	0.5 white, 0.5 mm	0.5 white, 0.5 mm
BWP Plywood, 17.5	Mobile Shelve [1]	709.0	276.0	2	Yes	0.5 white, 0.5 mm	0.5 white, 0.5 mm	0.5 white, 0.5 mm	0.5 white, 0.5 mm
BWP Plywood, 17.5	Mobile Shelve [2]	709.0	276.0	2	Yes	0.5 white, 0.5 mm	0.5 white, 0.5 mm	0.5 white, 0.5 mm	0.5 white, 0.5 mm
BWP Plywood, 17.5	Mobile Shelve [3]	709.0	276.0	2	Yes	0.5 white, 0.5 mm	0.5 white, 0.5 mm	0.5 white, 0.5 mm	0.5 white, 0.5 mm
BWP Plywood, 17.5	Vertical Division [1]	1164.0	276.0	2	Yes	0.5 white, 0.5 mm	0.5 white, 0.5 mm	0.5 white, 0.5 mm	0.5 white, 0.5 mm
BWP Plywood, 17.5	Vertical Division [2]	1164.0	276.0	2	Yes	0.5 white, 0.5 mm	0.5 white, 0.5 mm	0.5 white, 0.5 mm	0.5 white, 0.5 mm
Yellow Matt, 18.0	Door 1 (double) [1]	222.3	70.0	2	No				
Yellow Matt, 18.0	Door 1 (double) [1]	1179.0	70.0	2	No				
Yellow Matt, 18.0	Door 1 (double) [1]	222.3	70.0	2	No				
Yellow Matt, 18.0	Door 1 (double) [1]	1179.0	70.0	2	No				
OSB3, 18.0	Door 1 (double) [1]	1039.0	222.3	2	Yes				

## Venus Kitchens

### Cutting List (Net Dimensions) (Next)

Material	Reference	Height	Width	Quantity	Grain	Left Edge	Right Edge	Bottom Edge	Top Edge
Blue Matt, 18.0	Door 1 (double) [1]	222.3	70.0	2	Yes				
Blue Matt, 18.0	Door 1 (double) [1]	1179.0	70.0	2	Yes				
Blue Matt, 18.0	Door 1 (double) [1]	222.3	70.0	2	Yes				
Blue Matt, 18.0	Door 1 (double) [1]	1179.0	70.0	2	Yes				
OSB3, 18.0	Door 1 (double) [1]	1039.0	222.3	2	Yes				
Yellow Matt, 18.0	Door 1 (double) [2]	226.4	70.0	2	No				
Yellow Matt, 18.0	Door 1 (double) [2]	1179.0	70.0	2	No				
Yellow Matt, 18.0	Door 1 (double) [2]	226.4	70.0	2	No				
Yellow Matt, 18.0	Door 1 (double) [2]	1179.0	70.0	2	No				
OSB3, 18.0	Door 1 (double) [2]	1039.0	226.4	2	Yes				
Blue Matt, 18.0	Door 1 (double) [2]	226.4	70.0	2	Yes				
Blue Matt, 18.0	Door 1 (double) [2]	1179.0	70.0	2	Yes				
Blue Matt, 18.0	Door 1 (double) [2]	226.4	70.0	2	Yes				
Blue Matt, 18.0	Door 1 (double) [2]	1179.0	70.0	2	Yes				
OSB3, 18.0	Door 1 (double) [2]	1039.0	226.4	2	Yes				
Yellow Matt, 18.0	Door 2 (double) [1]	226.4	70.0	2	No				
Yellow Matt, 18.0	Door 2 (double) [1]	1179.0	70.0	2	No				
Yellow Matt, 18.0	Door 2 (double) [1]	226.4	70.0	2	No				
Yellow Matt, 18.0	Door 2 (double) [1]	1179.0	70.0	2	No				
OSB3, 18.0	Door 2 (double) [1]	1039.0	226.4	2	Yes				
Blue Matt, 18.0	Door 2 (double) [1]	226.4	70.0	2	Yes				
Blue Matt, 18.0	Door 2 (double) [1]	1179.0	70.0	2	Yes				
Blue Matt, 18.0	Door 2 (double) [1]	226.4	70.0	2	Yes				
Blue Matt, 18.0	Door 2 (double) [1]	1179.0	70.0	2	Yes				
OSB3, 18.0	Door 2 (double) [1]	1039.0	226.4	2	Yes				
<b>2400 base (x7)</b>									
BWP Plywood, 18.0	Top	2399.0	397.5	7	Yes	0.5 white, 0.5 mm	2mm White, 2.0 mm	0.5 white, 0.5 mm	0.5 white, 0.5 mm

## Venus Kitchens

17/03/2016

### Cutting List (Net Dimensions) (Next)

Material	Reference	Height	Width	Quantity	Grain	Left Edge	Right Edge	Bottom Edge	Top Edge
BWP Plywood, 18.0	Bottom	2399.0	379.0	7	Yes	0.5 white, 0.5 mm	0.5 white, 0.5 mm	0.5 white, 0.5 mm	0.5 white, 0.5 mm
BWP Plywood, 18.0	Left Side	473.0	379.0	7	Yes	0.5 white, 0.5 mm	0.5 white, 0.5 mm	0.5 white, 0.5 mm	0.5 white, 0.5 mm
BWP Plywood, 18.0	Right Side	473.0	379.0	7	Yes	0.5 white, 0.5 mm	0.5 white, 0.5 mm	0.5 white, 0.5 mm	0.5 white, 0.5 mm
Back Plywood, 8.0	Back	489.0	2379.0	7	No	0.5 white, 0.5 mm	0.5 white, 0.5 mm	0.5 white, 0.5 mm	0.5 white, 0.5 mm
BWP Plywood, 18.0	Mobile Shelve [1]	775.0	356.0	7	Yes	0.5 white, 0.5 mm	0.5 white, 0.5 mm	0.5 white, 0.5 mm	0.5 white, 0.5 mm
BWP Plywood, 18.0	Mobile Shelve [2]	775.0	356.0	7	Yes	0.5 white, 0.5 mm	0.5 white, 0.5 mm	0.5 white, 0.5 mm	0.5 white, 0.5 mm
BWP Plywood, 18.0	Mobile Shelve [3]	775.0	356.0	7	Yes	0.5 white, 0.5 mm	0.5 white, 0.5 mm	0.5 white, 0.5 mm	0.5 white, 0.5 mm
BWP Plywood, 18.0	Vertical Division [1]	473.0	356.0	7	Yes	0.5 white, 0.5 mm	0.5 white, 0.5 mm	0.5 white, 0.5 mm	0.5 white, 0.5 mm
BWP Plywood, 18.0	Vertical Division [2]	473.0	356.0	7	Yes	0.5 white, 0.5 mm	0.5 white, 0.5 mm	0.5 white, 0.5 mm	0.5 white, 0.5 mm
Blue Matt, 18.0	Door 1 (double) [1]	255.5	70.0	7	Yes				
Blue Matt, 18.0	Door 1 (double) [1]	489.0	70.0	7	Yes				
Blue Matt, 18.0	Door 1 (double) [1]	255.5	70.0	7	Yes				
Blue Matt, 18.0	Door 1 (double) [1]	489.0	70.0	7	Yes				
OSB3, 18.0	Door 1 (double) [1]	349.0	255.5	7	Yes				
Yellow Matt, 18.0	Door 1 (double) [1]	255.5	70.0	7	No				
Yellow Matt, 18.0	Door 1 (double) [1]	489.0	70.0	7	No				
Yellow Matt, 18.0	Door 1 (double) [1]	255.5	70.0	7	No				
Yellow Matt, 18.0	Door 1 (double) [1]	489.0	70.0	7	No				
OSB3, 18.0	Door 1 (double) [1]	349.0	255.5	7	Yes				
Blue Matt, 18.0	Door 1 (double) [2]	259.8	70.0	7	Yes				
Blue Matt, 18.0	Door 1 (double) [2]	489.0	70.0	7	Yes				
Blue Matt, 18.0	Door 1 (double) [2]	259.8	70.0	7	Yes				
Blue Matt, 18.0	Door 1 (double) [2]	489.0	70.0	7	Yes				
OSB3, 18.0	Door 1 (double) [2]	349.0	259.8	7	Yes				
Yellow Matt, 18.0	Door 1 (double) [2]	259.8	70.0	7	No				
Yellow Matt, 18.0	Door 1 (double) [2]	489.0	70.0	7	No				
Yellow Matt, 18.0	Door 1 (double) [2]	259.8	70.0	7	No				

## Venus Kitchens

### Cutting List (Net Dimensions) (Next)

Material	Reference	Height	Width	Quantity	Grain	Left Edge	Right Edge	Bottom Edge	Top Edge
Yellow Matt, 18.0	Door 1 (double) [2]	489.0	70.0	7	No				
OSB3, 18.0	Door 1 (double) [2]	349.0	259.8	7	Yes				
Blue Matt, 18.0	Door 2 (double) [1]	259.8	70.0	7	Yes				
Blue Matt, 18.0	Door 2 (double) [1]	489.0	70.0	7	Yes				
Blue Matt, 18.0	Door 2 (double) [1]	259.8	70.0	7	Yes				
Blue Matt, 18.0	Door 2 (double) [1]	489.0	70.0	7	Yes				
OSB3, 18.0	Door 2 (double) [1]	349.0	259.8	7	Yes				
Yellow Matt, 18.0	Door 2 (double) [1]	259.8	70.0	7	No				
Yellow Matt, 18.0	Door 2 (double) [1]	489.0	70.0	7	No				
Yellow Matt, 18.0	Door 2 (double) [1]	259.8	70.0	7	No				
Yellow Matt, 18.0	Door 2 (double) [1]	489.0	70.0	7	No				
OSB3, 18.0	Door 2 (double) [1]	349.0	259.8	7	Yes				
BWP Plywood, 18.0	Plinth 1 [1]	119.0	378.6	7	Yes	0.5 white, 0.5 mm	0.5 white, 0.5 mm	0.5 white, 0.5 mm	0.5 white, 0.5 mm
BWP Plywood, 18.0	Plinth 1 [2]	119.0	378.6	7	Yes	0.5 white, 0.5 mm	0.5 white, 0.5 mm	0.5 white, 0.5 mm	0.5 white, 0.5 mm
BWP Plywood, 18.0	Plinth 1 [3]	119.0	2398.6	7	Yes	0.5 white, 0.5 mm	0.5 white, 0.5 mm	0.5 white, 0.5 mm	0.5 white, 0.5 mm
BWP Plywood, 18.0	Plinth 1 [4]	119.0	2398.6	7	Yes	0.5 white, 0.5 mm	0.5 white, 0.5 mm	0.5 white, 0.5 mm	0.5 white, 0.5 mm
<b>— 2400 wall (x7) —</b>									
BWP Plywood, 17.5	Top	2399.0	317.5	7	Yes	0.5 white, 0.5 mm	2mm White, 2.0 mm	0.5 white, 0.5 mm	0.5 white, 0.5 mm
BWP Plywood, 17.5	Bottom	2399.0	299.0	7	Yes	0.5 white, 0.5 mm	0.5 white, 0.5 mm	0.5 white, 0.5 mm	0.5 white, 0.5 mm
BWP Plywood, 17.5	Left Side	1164.0	299.0	7	Yes	0.5 white, 0.5 mm	0.5 white, 0.5 mm	0.5 white, 0.5 mm	0.5 white, 0.5 mm
BWP Plywood, 17.5	Right Side	1164.0	299.0	7	Yes	0.5 white, 0.5 mm	0.5 white, 0.5 mm	0.5 white, 0.5 mm	0.5 white, 0.5 mm
Back Plywood, 8.0	Back	1180.0	2380.0	7	No	0.5 white, 0.5 mm	0.5 white, 0.5 mm	0.5 white, 0.5 mm	0.5 white, 0.5 mm
BWP Plywood, 17.5	Fixed Shelve [1]	775.7	276.0	7	Yes	0.5 white, 0.5 mm	0.5 white, 0.5 mm	0.5 white, 0.5 mm	0.5 white, 0.5 mm
BWP Plywood, 17.5	Fixed Shelve [2]	775.7	276.0	7	Yes	0.5 white, 0.5 mm	0.5 white, 0.5 mm	0.5 white, 0.5 mm	0.5 white, 0.5 mm
BWP Plywood, 17.5	Fixed Shelve [3]	775.7	276.0	7	Yes	0.5 white, 0.5 mm	0.5 white, 0.5 mm	0.5 white, 0.5 mm	0.5 white, 0.5 mm
BWP Plywood, 17.5	Fixed Shelve [4]	775.7	276.0	7	Yes	0.5 white, 0.5 mm	0.5 white, 0.5 mm	0.5 white, 0.5 mm	0.5 white, 0.5 mm
BWP Plywood, 17.5	Fixed Shelve [5]	775.7	276.0	7	Yes	0.5 white, 0.5 mm	0.5 white, 0.5 mm	0.5 white, 0.5 mm	0.5 white, 0.5 mm

## Venus Kitchens

17/03/2016

### Cutting List (Net Dimensions) (Next)

Material	Reference	Height	Width	Quantity	Grain	Left Edge	Right Edge	Bottom Edge	Top Edge
BWP Plywood, 17.5	Mobile Shelve [1]	775.7	276.0	7	Yes	0.5 white, 0.5 mm	0.5 white, 0.5 mm	0.5 white, 0.5 mm	0.5 white, 0.5 mm
BWP Plywood, 17.5	Mobile Shelve [2]	775.7	276.0	7	Yes	0.5 white, 0.5 mm	0.5 white, 0.5 mm	0.5 white, 0.5 mm	0.5 white, 0.5 mm
BWP Plywood, 17.5	Mobile Shelve [3]	775.7	276.0	7	Yes	0.5 white, 0.5 mm	0.5 white, 0.5 mm	0.5 white, 0.5 mm	0.5 white, 0.5 mm
BWP Plywood, 17.5	Vertical Division [1]	1164.0	276.0	7	Yes	0.5 white, 0.5 mm	0.5 white, 0.5 mm	0.5 white, 0.5 mm	0.5 white, 0.5 mm
BWP Plywood, 17.5	Vertical Division [2]	1164.0	276.0	7	Yes	0.5 white, 0.5 mm	0.5 white, 0.5 mm	0.5 white, 0.5 mm	0.5 white, 0.5 mm
Yellow Matt, 18.0	Door 1 (double) [1]	255.6	70.0	7	No				
Yellow Matt, 18.0	Door 1 (double) [1]	1179.0	70.0	7	No				
Yellow Matt, 18.0	Door 1 (double) [1]	255.6	70.0	7	No				
Yellow Matt, 18.0	Door 1 (double) [1]	1179.0	70.0	7	No				
OSB3, 18.0	Door 1 (double) [1]	1039.0	255.6	7	Yes				
Blue Matt, 18.0	Door 1 (double) [1]	255.6	70.0	7	Yes				
Blue Matt, 18.0	Door 1 (double) [1]	1179.0	70.0	7	Yes				
Blue Matt, 18.0	Door 1 (double) [1]	255.6	70.0	7	Yes				
Blue Matt, 18.0	Door 1 (double) [1]	1179.0	70.0	7	Yes				
OSB3, 18.0	Door 1 (double) [1]	1039.0	255.6	7	Yes				
Yellow Matt, 18.0	Door 1 (double) [2]	259.7	70.0	7	No				
Yellow Matt, 18.0	Door 1 (double) [2]	1179.0	70.0	7	No				
Yellow Matt, 18.0	Door 1 (double) [2]	259.7	70.0	7	No				
Yellow Matt, 18.0	Door 1 (double) [2]	1179.0	70.0	7	No				
OSB3, 18.0	Door 1 (double) [2]	1039.0	259.7	7	Yes				
Blue Matt, 18.0	Door 1 (double) [2]	259.7	70.0	7	Yes				
Blue Matt, 18.0	Door 1 (double) [2]	1179.0	70.0	7	Yes				
Blue Matt, 18.0	Door 1 (double) [2]	259.7	70.0	7	Yes				
Blue Matt, 18.0	Door 1 (double) [2]	1179.0	70.0	7	Yes				
OSB3, 18.0	Door 1 (double) [2]	1039.0	259.7	7	Yes				
Yellow Matt, 18.0	Door 2 (double) [1]	259.7	70.0	7	No				
Yellow Matt, 18.0	Door 2 (double) [1]	1179.0	70.0	7	No				



## Venus Kitchens

17/03/2016

### Cutting List (Net Dimensions) (Next)

Material	Reference	Height	Width	Quantity	Grain	Left Edge	Right Edge	Bottom Edge	Top Edge
Yellow Matt, 18.0	Door 2 (double) [1]	259.7	70.0	7	No				
Yellow Matt, 18.0	Door 2 (double) [1]	1179.0	70.0	7	No				
OSB3, 18.0	Door 2 (double) [1]	1039.0	259.7	7	Yes				
Blue Matt, 18.0	Door 2 (double) [1]	259.7	70.0	7	Yes				
Blue Matt, 18.0	Door 2 (double) [1]	1179.0	70.0	7	Yes				
Blue Matt, 18.0	Door 2 (double) [1]	259.7	70.0	7	Yes				
Blue Matt, 18.0	Door 2 (double) [1]	1179.0	70.0	7	Yes				
OSB3, 18.0	Door 2 (double) [1]	1039.0	259.7	7	Yes				
<b>— corner dummy 400 (x5) —</b>									
BWP Plywood, 18.0	Right Side	1830.0	382.0	5	Yes				
BWP Plywood, 18.0	Door 1 (single) [1]	1830.0	400.0	5	Yes				
<b>— corner dummy 630 —</b>									
BWP Plywood, 18.0	Top	400.0	400.0	1	Yes				
<b>— middle dummy cab —</b>									
BWP Plywood, 18.0	Top	764.0	382.0	1	Yes				
BWP Plywood, 18.0	Left Side	630.0	382.0	1	Yes				
BWP Plywood, 18.0	Right Side	630.0	382.0	1	Yes				
Blue Matt, 18.0	Door 1 (single) [1]	630.0	800.0	1	Yes				
<b>— Pillar panel —</b>									
BWP Plywood, 17.5	Left Side	1829.0	279.0	1	Yes	0.5 white, 0.5 mm	0.5 white, 0.5 mm	0.5 white, 0.5 mm	0.5 white, 0.5 mm
BWP Plywood, 17.5	Right Side	1829.0	279.0	1	Yes	0.5 white, 0.5 mm	0.5 white, 0.5 mm	0.5 white, 0.5 mm	0.5 white, 0.5 mm
<b>— wall 1150 —</b>									
BWP Plywood, 17.5	Top	1149.0	317.5	1	Yes	0.5 white, 0.5 mm	2mm White, 2.0 mm	0.5 white, 0.5 mm	0.5 white, 0.5 mm
BWP Plywood, 17.5	Bottom	1149.0	299.0	1	Yes	0.5 white, 0.5 mm	0.5 white, 0.5 mm	0.5 white, 0.5 mm	0.5 white, 0.5 mm
BWP Plywood, 17.5	Left Side	1164.0	299.0	1	Yes	0.5 white, 0.5 mm	0.5 white, 0.5 mm	0.5 white, 0.5 mm	0.5 white, 0.5 mm
BWP Plywood, 17.5	Right Side	1164.0	299.0	1	Yes	0.5 white, 0.5 mm	0.5 white, 0.5 mm	0.5 white, 0.5 mm	0.5 white, 0.5 mm
Back Plywood, 8.0	Back	1180.0	1130.0	1	No	0.5 white, 0.5 mm	0.5 white, 0.5 mm	0.5 white, 0.5 mm	0.5 white, 0.5 mm

## Venus Kitchens

17/03/2016

### Cutting List (Net Dimensions) (Next)

Material	Reference	Height	Width	Quantity	Grain	Left Edge	Right Edge	Bottom Edge	Top Edge
BWP Plywood, 17.5	Mobile Shelve [1]	361.2	276.0	1	Yes	0.5 white, 0.5 mm	0.5 white, 0.5 mm	0.5 white, 0.5 mm	0.5 white, 0.5 mm
BWP Plywood, 17.5	Mobile Shelve [2]	734.3	276.0	1	Yes	0.5 white, 0.5 mm	0.5 white, 0.5 mm	0.5 white, 0.5 mm	0.5 white, 0.5 mm
BWP Plywood, 17.5	Mobile Shelve [3]	734.3	276.0	1	Yes	0.5 white, 0.5 mm	0.5 white, 0.5 mm	0.5 white, 0.5 mm	0.5 white, 0.5 mm
BWP Plywood, 17.5	Mobile Shelve [4]	734.3	276.0	1	Yes	0.5 white, 0.5 mm	0.5 white, 0.5 mm	0.5 white, 0.5 mm	0.5 white, 0.5 mm
BWP Plywood, 17.5	Mobile Shelve [5]	361.2	276.0	1	Yes	0.5 white, 0.5 mm	0.5 white, 0.5 mm	0.5 white, 0.5 mm	0.5 white, 0.5 mm
BWP Plywood, 17.5	Vertical Division [1]	1164.0	276.0	1	Yes	0.5 white, 0.5 mm	0.5 white, 0.5 mm	0.5 white, 0.5 mm	0.5 white, 0.5 mm
Blue Matt, 18.0	Door 1 (single) [1]_T	246.9	70.0	1	Yes				
Blue Matt, 18.0	Door 1 (single) [1]_M	1179.0	70.0	1	Yes				
Blue Matt, 18.0	Door 1 (single) [1]_T	246.9	70.0	1	Yes				
Blue Matt, 18.0	Door 1 (single) [1]_M	1179.0	70.0	1	Yes				
OSB3, 18.0	Door 1 (single) [1]_A	1039.0	246.9	1	Yes				
Yellow Matt, 18.0	Door 1 (double) [1]	239.0	70.0	1	No				
Yellow Matt, 18.0	Door 1 (double) [1]	1179.0	70.0	1	No				
Yellow Matt, 18.0	Door 1 (double) [1]	239.0	70.0	1	No				
Yellow Matt, 18.0	Door 1 (double) [1]	1179.0	70.0	1	No				
OSB3, 18.0	Door 1 (double) [1]	1039.0	239.0	1	Yes				
Blue Matt, 18.0	Door 1 (double) [1]	239.0	70.0	1	Yes				
Blue Matt, 18.0	Door 1 (double) [1]	1179.0	70.0	1	Yes				
Blue Matt, 18.0	Door 1 (double) [1]	239.0	70.0	1	Yes				
Blue Matt, 18.0	Door 1 (double) [1]	1179.0	70.0	1	Yes				
OSB3, 18.0	Door 1 (double) [1]	1039.0	239.0	1	Yes				

## Recapitulatory

Panel	Surface	Price (€/m <sup>2</sup> )	Price
Back Plywood, 8.0	56.49 m <sup>2</sup>	1076.39	60 805,18 €
Blue Matt, 18.0	13.74 m <sup>2</sup>	2152.78	29 569,66 €
BWP Plywood, 17.5	83.30 m <sup>2</sup>	1506.95	125 524,23 €
BWP Plywood, 18.0	57.41 m <sup>2</sup>	1506.95	86 514,69 €
OSB3, 18.0	30.77 m <sup>2</sup>	10.00	307,71 €
Yellow Matt, 18.0	12.72 m <sup>2</sup>	2152.78	27 379,06 €
<b>Total</b>			<b>330 100,53 €</b>

---

Edge	Length	Price (€/m)	Price
0.5 white, 0.5 mm	1306.1 m	10.00	13 061,37 €
2mm White, 2.0 mm	92.1 m	27.00	2 487,83 €
<b>Total</b>			<b>15 549,20 €</b>